

AMT 337E-96 / 338E-96



DIAPHRAGM PUMP



The AMT line of diaphragm pumps features a 2-stage, heavy duty forged gear driven transmission. AMT diaphragm pumps are designed to pump water, mud, slurry, sewage and thick liquids that have the ability to flow.

Electric motor for quiet running

AMT diaphragm pumps are available with a choice of drivers to meet your application requirements. We supply these pumps with a 1.5 HP Single Phase, 115/230 VAC Volt Motor with Manual Reset Overload, quiet running, low vibrations and no emissions.

POWER	TARE WEIGHT	CONSTRUCTION
1.5 HP Single Phase 115/230 VAC	79 kg (338) or 84 kg (337)	Sand Cast Aluminum for portability and durability

Self-priming capabilities

Built-in check valve assures self-priming to 6,1 meters after initial prime. Heavy duty forged gear driven transmission is designed to operate the pump at 60 strokes per minute. Each unit includes a 2" (AMT 338E-96) or 3" (AMT 337E-96) NPT steel suction strainer, two NPT nipples and a wheel kit for portability. Suction and discharge port sizes cannot be reduced.

Features

- Thermoplastic Santoprene diaphragm
- Solids handling: max. 31,7 mm (338) or 41 mm (337)
- Modular component design permits easy maintenance and cleanout



PUMP

AMT 338 (2") or 337 (3") diaphragm pump



MOTOR

BALDOR / ABB
1.5h Single Phase
115/230 VAC Volt motor
with manual reset
overload



PERFORMANCE

Max. 7,5 m³/h (338) /
13,4 m³/h (337) flow or
7,6 mwc head



DIMENSIONS

2" x 2" (338) /
3" x 3" (337) NPT
connection size

OPTIONS:

The AMT diaphragm pumps can be supplied with various options such as:

- In line configurations (suction and discharge ports rotated 90 degrees)
- Connection pieces to customers specifications
- Gasoline engine powered

Contact Gorman-Rupp or your local distributor for more information.

AMT 337E-96 / 338E-96



DIAPHRAGM PUMP

Performance of Diaphragm Pumps

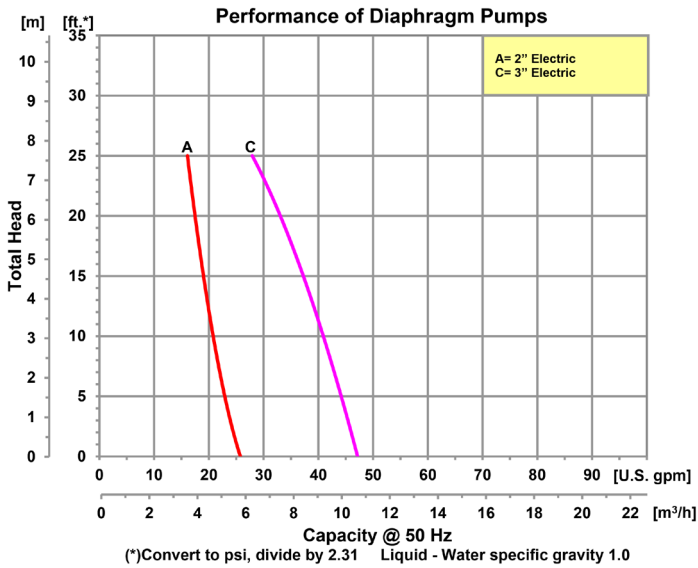

Dimensions and weight

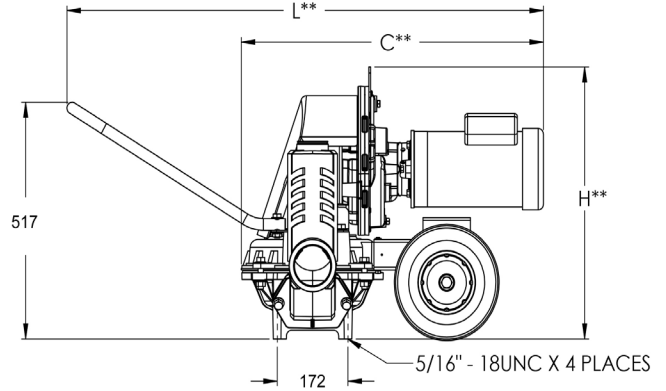
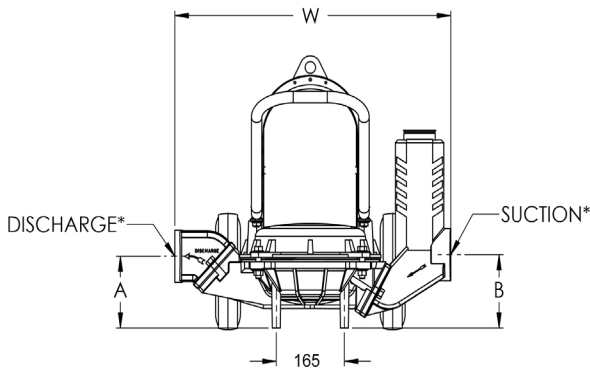

Model	338E-96	337E-96
Nominal size suction x discharge	2"	3"
A (mm)	185	157
B (mm)	145	160
C (mm)	727	727
L (mm)	1155	1155
W (mm)	561	670
H (mm)	594	594

AUTHORISED DISTRIBUTOR

Product information is subject to change; consult factory for details. All images are for illustrative purposes only. Actual product may vary from printed representation.



EUROPE

The Pump People®

GORMAN-RUPP PUMPS
ZANDWEISTRAAT 19
4181 CG WAARDENBURG | NL
TEL: +31 (0)85 7730080

GRPUMPS.EU