

**GMS SERIES**  
**MEDIUM DUTY STANDARD**  
**S & T HYDRAULIC SIZE**  
**ROTARY GEAR PUMP**



**MODEL GMS6SU3**  
**SHOWN WITH OPTIONAL**  
**180° HOUSING**

The GMS iron, high capacity series is designed for applications in the operating ranges noted below. These units are ideal for bulk handling of a variety of liquids. For temperature control, backhead and housing jackets are standard; head jackets are available. Also available are carbon graphite bushings for low viscosity liquids, silicon carbide bushings for wear resistance, and carbide or positive drive shaft seals.

For continuous service, or for handling difficult liquids, see the heavy duty GHS section.

For belt drive applications, a pedestal bearing is required.

**FEATURES**

*THRUST CONTROLLED PUMP  
 ELEMENTS*

*HIGH STRENGTH, COMPUTER  
 PROFILED GEARING FOR QUIET  
 OPERATION*

*SEAL AREA FULLY JACKETED FOR  
 TEMPERATURE CONTROL.*

*EXCEPTIONAL SEAL VERSATILITY.*

**OPERATING RANGE**

CAPACITY (GPM) : (40 TO 600)  
 [LPM] : [151 TO 2270]

PRESSURE (PSI) : [0 TO 100]  
 [BAR] : [0 TO 7]

VISCOSITY (SSU) : (28 TO 250,000)  
 [cSt] : [1 TO 55,000]

TEMPERATURE (F) : (-60° TO 500°)  
 [C] : [-51° TO 260°]

**APPLICATIONS**

USE WITH ANY CLEAN LIQUID  
 COMPATIBLE WITH CAST  
 IRON

- ★ BOOSTER SERVICE
- ★ CIRCULATING
- ★ FILTERING
- ★ LUBRICATING
- ★ TRANSFERRING

EXTER- IOR	ROTOR & IDLER	HOUSING PORTS	BUSHINGS	IDLER PIN	SHAFT	SHAFT SEALING		ROTATION	INTERNAL RELIEF VALVE	
						MECH. SEAL ●	PACKING ■		MATERIAL	SETTING
CAST IRON	HIGH STRENGTH IRON	90° 125# FLG	BRONZE	HARDENED STEEL	STEEL	FLUORO <sup>①</sup> CARBON NI-RESIST	CARBON FIBER	C.W.	CAST IRON	75 PSI [5 BAR]

## Standard Models

**G M S 4 SU 3 - B**  
 | | | | | | | | | | | |  
 GEAR DUTY DESIGN PORT HYDRAULIC SEAL STYLE  
 SIZE SIZE

MODEL NUMBER	NOM. CAPACITY - SPEED		MAXIMUM			TEMP.	SHIPPING DATA	
	MAXIMUM		DIFFERENTIAL PRESSURE-PSI [BAR]				Weight	Volume
	GPM [LPM]	RPM	BELOW 38 SSU 14 cSt	38 TO 100 SSU [21 cSt]	100 TO 250,000 SSU [55,000 cSt]	°F [°C]	LBS [KG]	CU. FT.
<b>GMS 3 SR3-B</b> ● ■ <b>GMS 3 SR4-B</b> ■ ■	202 [765]	350	50 [3.5]	75 [5.2]	100 [7]	● 400° [204]  ■ 500° [260]	515 [234]	17.3
<b>GMS 4 SR3-B</b> ● ■ <b>GMS 4 SR4-B</b> ■ ■								
<b>GMS 6 SR3-B</b> ● ■ † <b>GMS 6 SR4-B</b> ■ ■ †								
<b>GMS 3 SU3-B</b> ● ■ <b>GMS 3 SU4-B</b> ■ ■								
<b>GMS 4 SU3-B</b> ● ■ <b>GMS 4 SU4-B</b> ■ ■	337 [1276]	350	50 [3.5]	75 [5.2]	100 [7]	● 400° [204]  ■ 500° [260]	515 [234]	17.3
<b>GMS 6 SU3-B</b> ● ■ † <b>GMS 6 SU4-B</b> ■ ■ †								
<b>GMS 5 TU3-B</b> ● ■ <b>GMS 5 TU4-B</b> ■ ■								
<b>GMS 6 TU3-B</b> ● ■ <b>GMS 6 TU4-B</b> ■ ■	600 [2270]	350	50 [3.5]	75 [5.2]	100 [7]	● 400° [204]  ■ 500° [260]	715 [324]	17.3

● MECHANICAL SEAL

■ PACKING

■ PORTS ARE COMPATIBLE WITH 125# ANSI CAST IRON FLANGES.

† 180° DEGREE HOUSING

\* Note: Verify chemical compatibility

① DUPONT VITON® OR EQUIVALENT

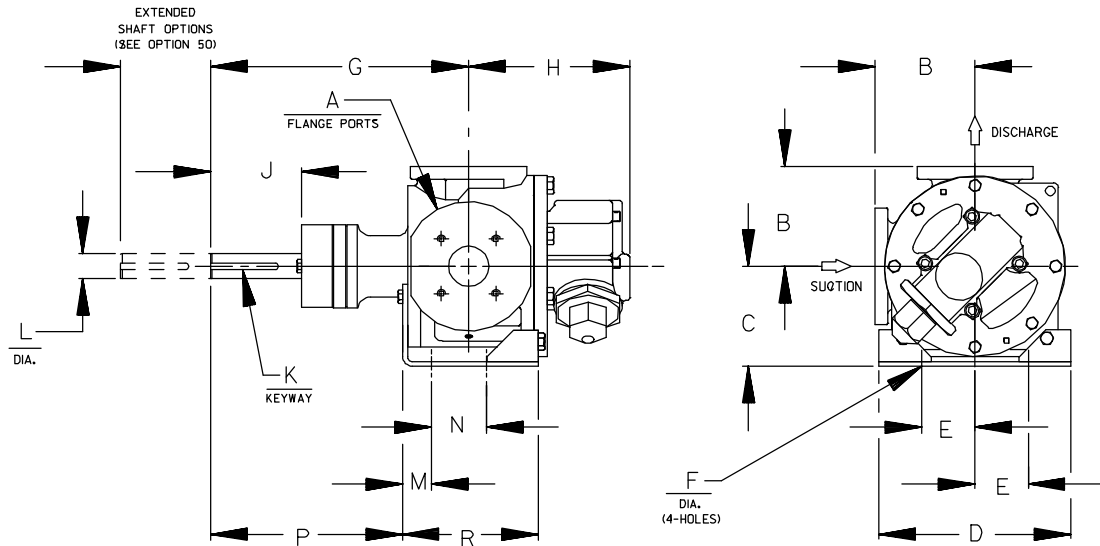

CAD FILE NO.: 17221A

PUMP MODEL	PUMP DIMENSIONS - INCHES [MILLIMETERS]														
	A	B	C	D	E	F	G	H	J	K	L	M	N	P	R
GMS S	3.00*	7.75 [197]	7.75 [197] *								.50 [13]				
	4.00*	8.25 [210]	7.75 [197]	8.25 [210]	4.12 [105]	.69 [18]	20.00 [508]	12.49 [317]	6.90 [178]	x	1.94 [49]	2.88 [73]	4.25 [108]	14.00 [356]	11.41 [290]
	6.00*	9.00 [229] †	8.75 [222]								5.00 [127]				
GMS T	5.00*	9.56 [243]									.62 [16]				
	6.00*	9.52 [244]	9.50 [241]	12.00 [304,8]	5.00 [127]	.69 [18]	20.70 [526]	12.41 [315]	7.00 [178]	x	2.44 [62]	.81 [21]	6.25 [159]	16.45 [418]	8.50 [216]
	6.00*	9.75 [248] †									4.62 [117]				

\* STANDARD DIMENSION

† 180° HOUSING

**THE GORMAN-RUPP COMPANY • MANSFIELD, OHIO**  
GORMAN-RUPP OF CANADA LIMITED • ST. THOMAS, ONTARIO, CANADA

## GRR REDUCER C-FLANGE FLEX DRIVE OPTIONS

(Drive Assembly Number Includes Base, Coupling, Guard and Gear Reducer, But **NOT** the Motor)

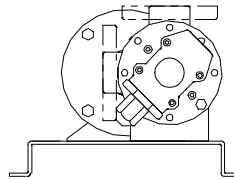
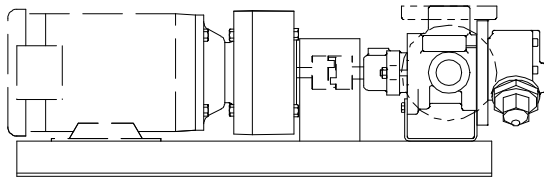

CAD FILE NO.: 16573

PUMP MODEL	RPM @ 1750	RPM @ 1150	REDUCER ①		FRAME	MTG.FT. OPTION REQ.	DRIVE ASSY NO.	
				MAX HP @ 1750				MAX HP @ 1150
GMS S	343	225	5.10:1	20.00	13.20	254TC/256TC	STD	90253-004
	344	226	5.08:1	30.00	19.80	284TC/286TC	STD	90253-006
	355	233	4.93:1	60.00	39.60	324TC	STD	90253-008
	283	186	6.19:1	20.00	13.20	254TC/256TC	STD	90253-014
	287	189	6.09:1	30.00	19.80	284TC/286TC	STD	90253-016
	276	181	6.35:1	60.00	39.60	324TC	STD	90253-018
	179	117	9.80:1	10.00	6.60	213TC	STD	90253-024
	206	135	8.50:1	20.00	13.20	254TC	STD	90253-026
				20.00	13.20	256TC	STD	90253-027
	198	130	8.83:1	30.00	19.80	284TC	STD	90253-028
				30.00	19.80	286TC	STD	90253-029
	120	79	14.55:1	10.00	6.60	213TC	STD	90253-034
	125	82	14.00:1	30.00	19.80	254TC	STD	90253-036
				30.00	19.80	256TC	STD	90253-037
105	69	16.66:1	7.81	5.16	184TC	STD	90253-044	
			17.71:1	16.48	10.88	213TC	STD	90253-046
99	65	17.81:1	26.41	17.43	254TC	STD	90253-048	
GMS T	279	186	6.19:1	20.00	13.20	254TC/256TC	STD	90253-104
	287	189	6.09:1	30.00	19.80	284TC/286TC	STD	90253-106
	276	181	6.35:1	60.00	39.60	324TC	STD	90253-108
				60.00	39.60	326TC	STD	90253-109
				60.00	39.60	364TC	STD	90253-110
	179	117	9.80:1	10.00	6.60	213TC	STD	90253-114
	206	135	8.50:1	20.00	13.20	254TC/256TC	STD	90253-116
	198	130	8.83:1	30.00	19.80	284TC	STD	90253-118
				30.00	19.80	286TC	STD	90253-119
	199	131	8.78:1	60.00	39.60	324TC	STD	90253-120
	119	79	14.55:1	10.00	6.60	213TC	STD	90253-124
	125	82	14.00:1	30.00	19.80	254TC/256TC	STD	90253-126
				30.00	19.80	284TC	STD	90253-128
	104	69	16.66:1	7.81	5.16	184TC	STD	90253-134
17.71:1				16.48	10.88	213TC	STD	90253-136
97	65	17.81:1	26.41	17.43	254TC/256TC	STD	90253-138	

① Listed reducer horsepower rated for Standard Service (8-10 hrs/day). For Light Service (3-5 hrs/day) multiply maximum rated horsepower by 1.1. For Heavy Service (16-24 hrs/day) multiply maximum rated horsepower by 0.9.

NOTE: CONSULT FACTORY FOR OPTIONS NOT SHOWN.



# PERFORMANCE CURVES

## SPEED VS. CAPACITY/HORSEPOWER

# SU

Hydraulic Size

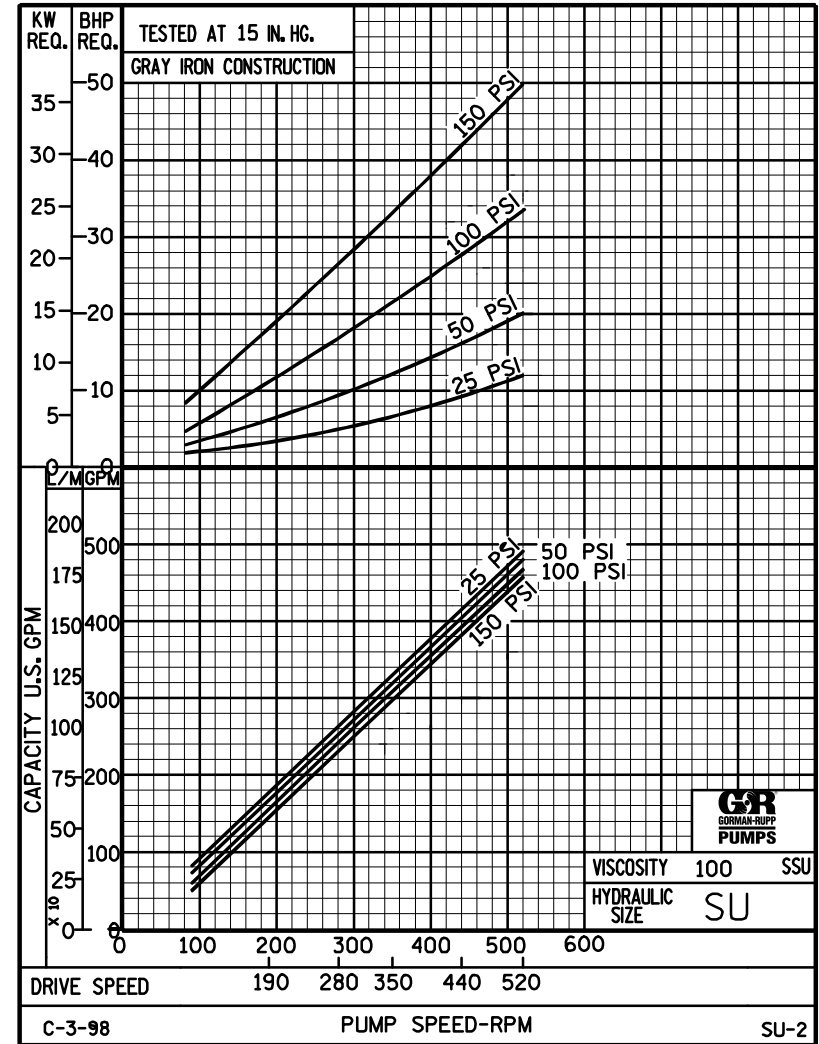
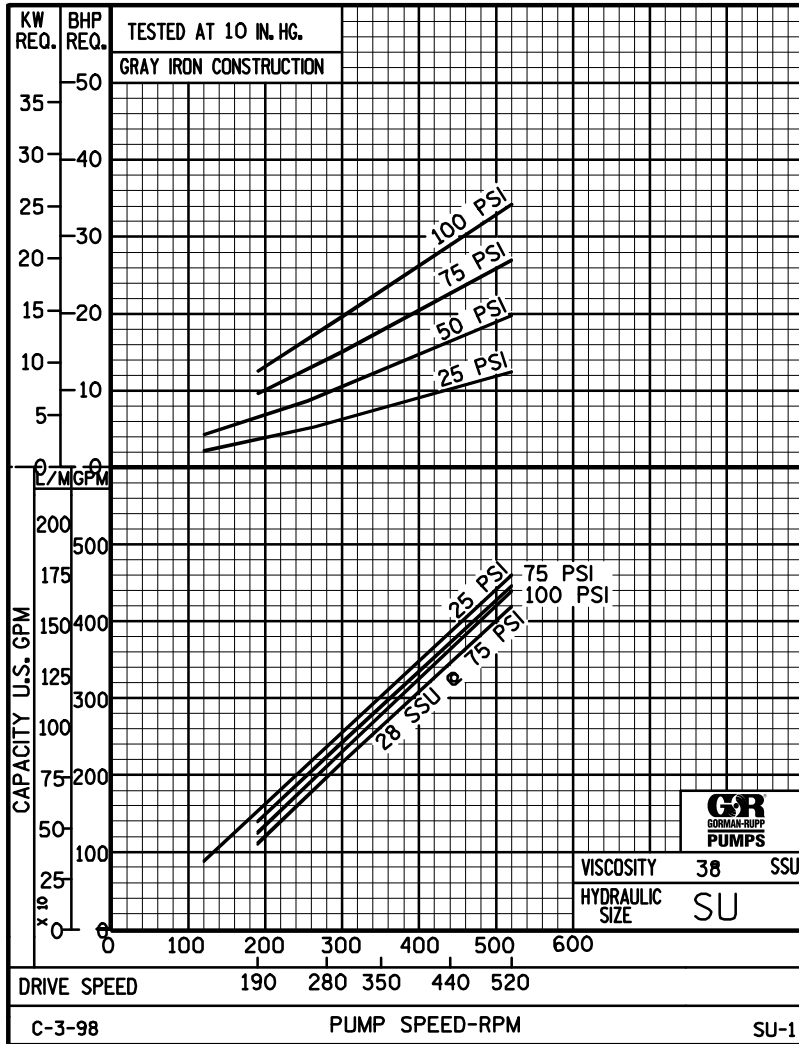

THE GORMAN-RUPP COMPANY • MANSFIELD, OHIO  
GORMAN-RUPP OF CANADA LIMITED • ST. THOMAS, ONTARIO, CANADA

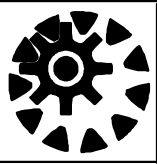

# PERFORMANCE CURVES

## SPEED VS. CAPACITY/HORSEPOWER

# SU

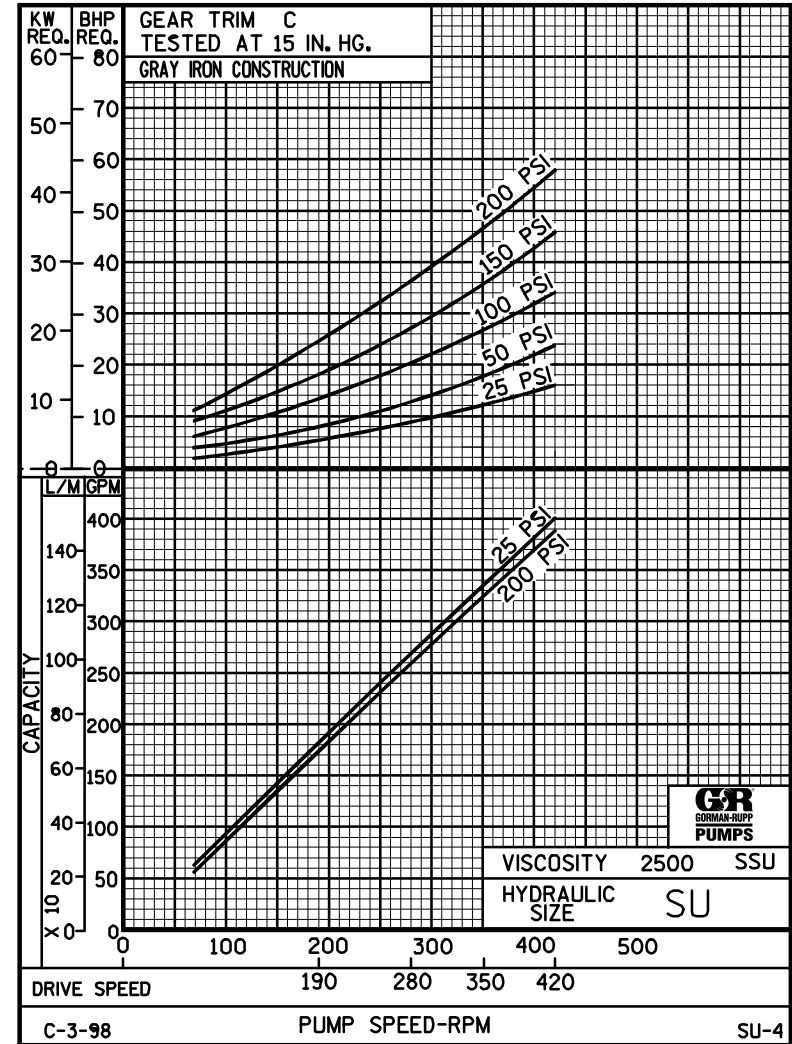
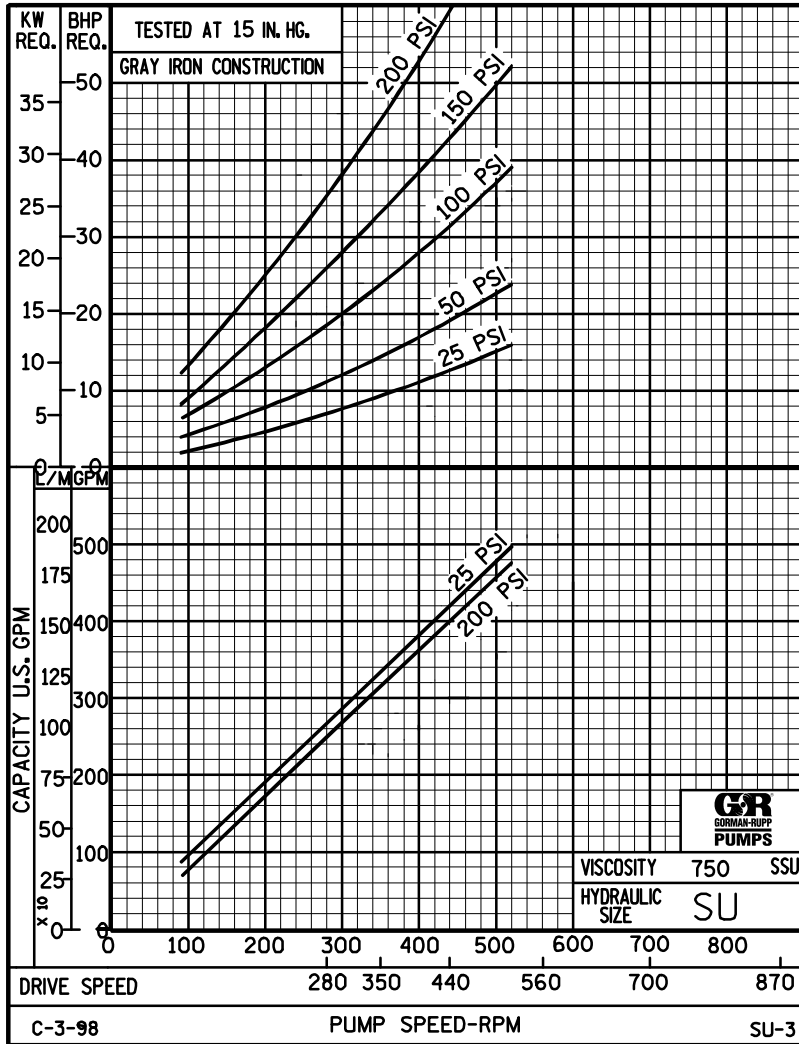
 Hydraulic Size

THE GORMAN-RUPP COMPANY • MANSFIELD, OHIO  
GORMAN-RUPP OF CANADA LIMITED • ST. THOMAS, ONTARIO, CANADA



# PERFORMANCE CURVES

## SPEED VS. CAPACITY/HORSEPOWER

# SU

Hydraulic Size

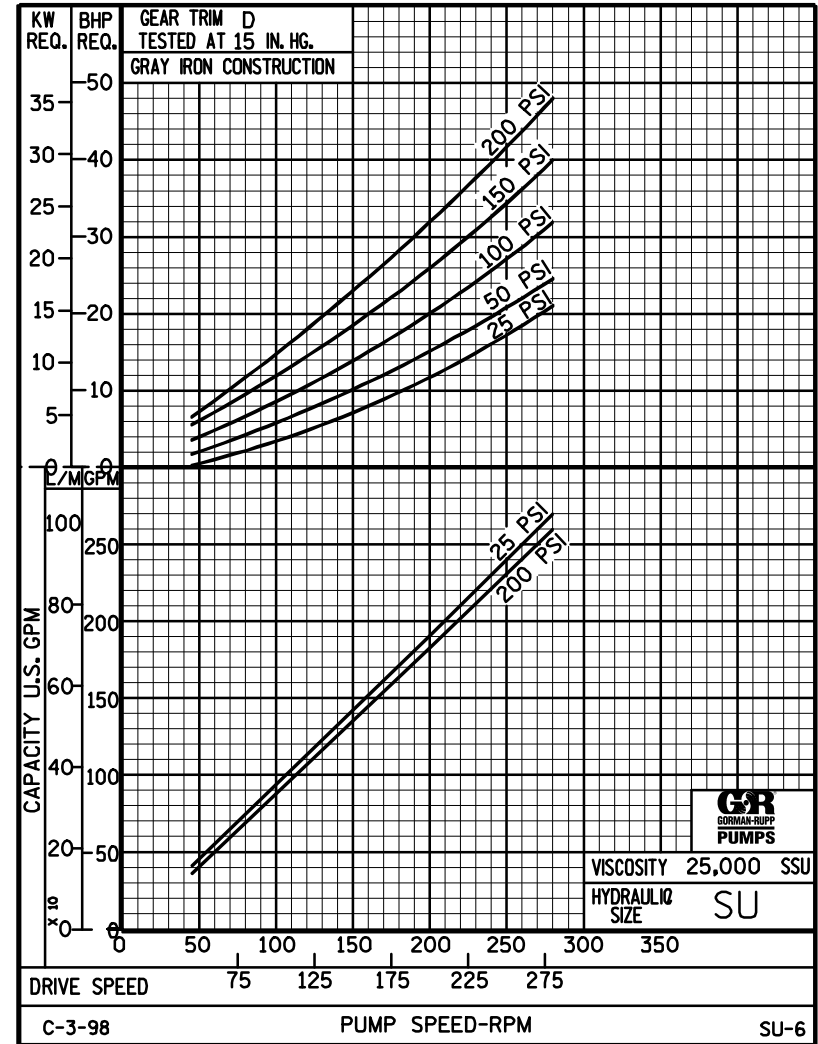
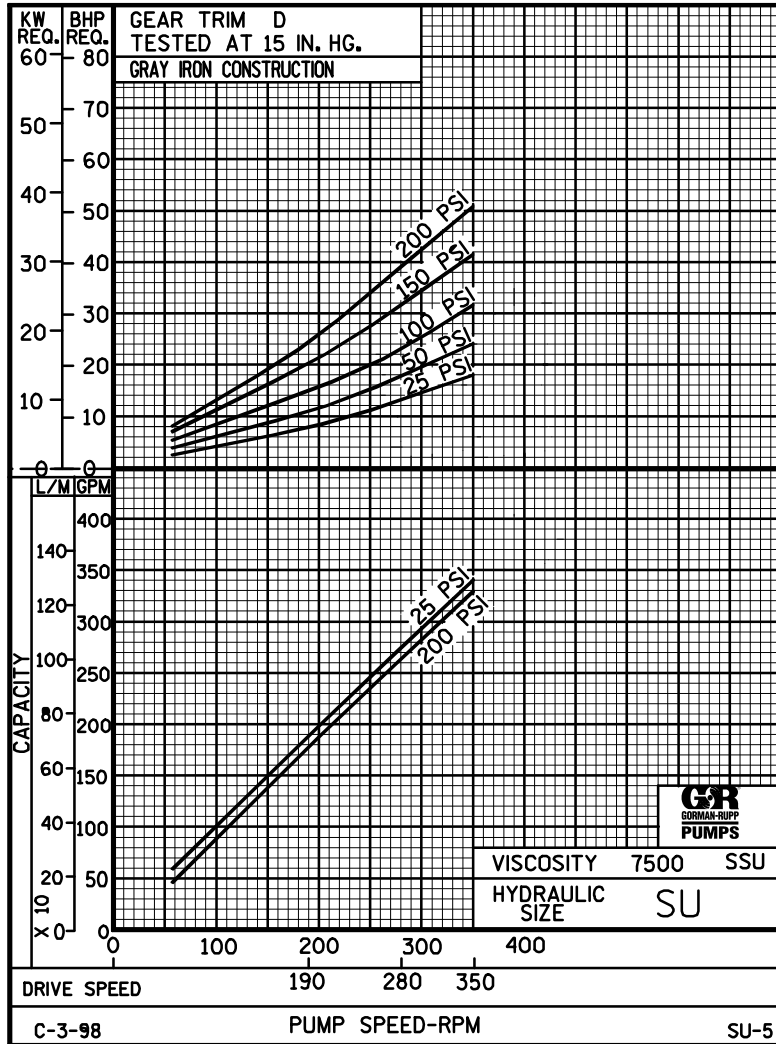

THE GORMAN-RUPP COMPANY • MANSFIELD, OHIO  
GORMAN-RUPP OF CANADA LIMITED • ST. THOMAS, ONTARIO, CANADA

Printed in U.S.A.

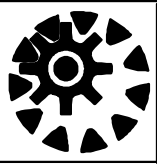

# PERFORMANCE CURVES

## SPEED VS. CAPACITY/HORSEPOWER

**SU** Hydraulic Size

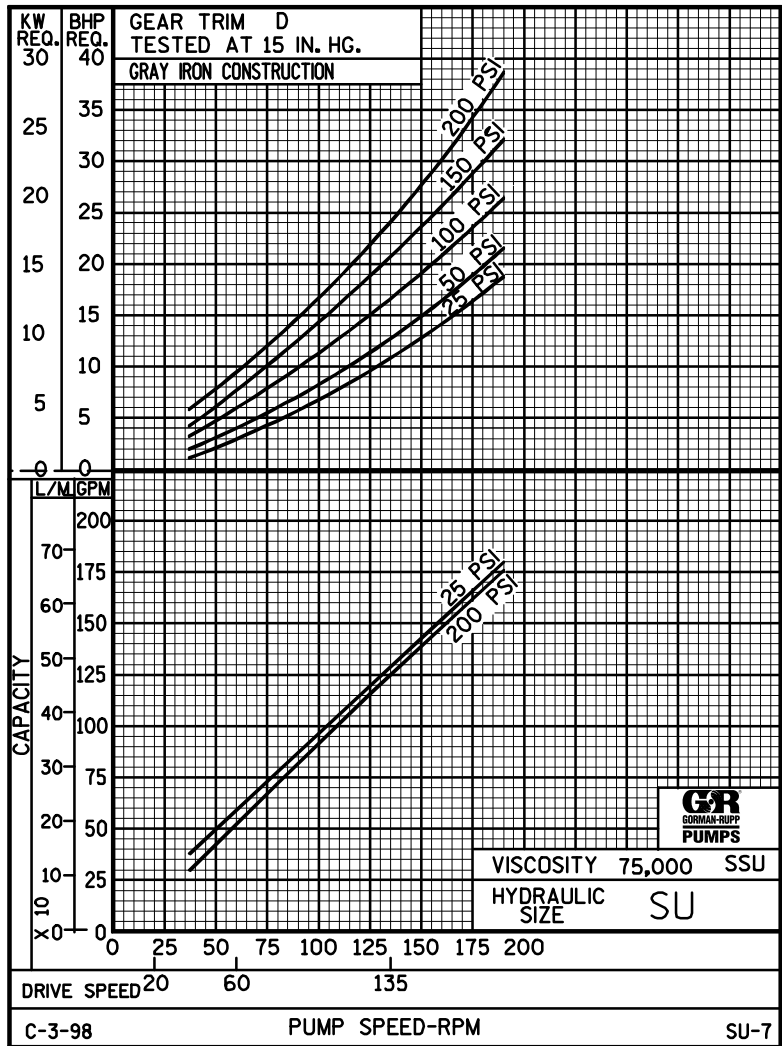

THE GORMAN-RUPP COMPANY • MANSFIELD, OHIO  
GORMAN-RUPP OF CANADA LIMITED • ST. THOMAS, ONTARIO, CANADA

Printed in U.S.A.



# SU

## PUMP HYDRAULIC SIZE CHART

SEC. 500

Page 135.1

February 2025

**572 GPM**

**520 RPM**

NOMINAL		VISCOSITY		N.I.P.R	FRICTION PIPE LOSS (PSI/FT) <small>(Schedule 40 Steel Pipe)</small>					CAPACITY (GPM)				H.P. REQUIRED					
GPM	RPM	ROTOR TRIM	(SSU)	(PSIa)	PIPE DIAMETER					MEDIUM-DUTY & HEAVY-DUTY				HEAVY-DUTY ONLY					
					2½"	3"	4"	5"	6"	DIFFERENTIAL PRESSURE (PSI)									
						25	50	75	100	150	200	300	400						
<b>572</b>	<b>520</b>	STD	28	5.5	0.90	0.29	0.07	0.02	0.01	507	498	488	480						
			32		0.93	0.30	0.08	0.02	0.01	15	24	32	43						
			38	5.5	0.96	0.32	0.08	0.03	0.01	509	500	490	482	473					
			50		1.02	0.34	0.09	0.03	0.01	16	25	32	44	52					
			70	5.5	1.10	0.38	0.10	0.03	0.01	513	504	495	488	475	468				
			100		1.19	0.41	0.11	0.04	0.02	17	25	32	45	53	62				
			150	5.5	1.29	0.45	0.12	0.04	0.02	522	515	507	500	490	480				
			200		1.37	0.48	0.13	0.04	0.02	18	27	33	46	55	67				
			300	5.5	1.50	0.53	0.15	0.05	0.02	546	543	538	534	522	515				
			500		1.71	0.61	0.17	0.06	0.02	23	31	39	48	62	80				
			750	5.5	1.92	0.69	0.19	0.07	0.02	557	555	552	549	540	531				
			1,000		2.09	0.75	0.21	0.05	0.02	25	33	41	49	65	86				
		2,000	7.7	1.81	0.76	0.26	0.10	0.05	577	576	575	573	569	564					
		3,500		3.17	1.33	0.45	0.18	0.09	31	39	47	55	71	88					
				"C"	5,000														
					7,500														
					10,000														
					15,000														
		20,000																	
		25,000																	
		"D"	50,000																
			75,000																
			100,000																
			150,000																
			200,000																
		250,000																	

(NOTE) For speeds not shown on the pump hydraulic charts, consult factory.



# SU

## PUMP HYDRAULIC SIZE CHART

SEC. 500

Page 135.2

February 2025

**489 GPM**

**440 RPM**

NOMINAL		VISCOSITY		N.I.P.R	FRICTION PIPE LOSS (PSI/FT) <small>(Schedule 40 Steel Pipe)</small>					CAPACITY (GPM)					H.P. REQUIRED					
GPM	RPM	ROTOR TRIM	(SSU)	(PSIa)	PIPE DIAMETER					MEDIUM-DUTY & HEAVY-DUTY					HEAVY-DUTY ONLY					
					2½"	3"	4"	5"	6"	DIFFERENTIAL PRESSURE (PSI)										
										25	50	75	100	150	200	300	400			
<b>489</b>	<b>440</b>	STD	28	3.9	0.66	0.21	0.05	0.02	0.01	413	407	402	396							
			32		0.68	0.22	0.06	0.02	0.01	13	19	27	35							
			38	3.9	0.71	0.24	0.06	0.02	0.01	415	409	402	398	392						
			50		0.76	0.26	0.07	0.02	0.01	13	19	27	35	43						
			70	3.9	0.82	0.28	0.08	0.03	0.01	420	417	410	401	397	390					
			100		0.89	0.31	0.08	0.03	0.01	13	20	28	36	45	53					
			150	3.9	0.97	0.34	0.09	0.03	0.01	431	423	420	417	408	400					
			200		1.03	0.36	0.10	0.03	0.01	14	21	29	37	46	56					
			300	3.9	1.14	0.40	0.11	0.04	0.02	462	459	458	450	440	430					
			500		1.30	0.47	0.13	0.05	0.02	16	24	32	38	51	63					
		750	3.9	1.47	0.53	0.15	0.03	0.02	475	472	470	465	455	445						
		1,000		1.60	0.58	0.11	0.04	0.02	17	25	33	39	53	66						
		2,000	5.5	1.55	0.65	0.22	0.09	0.04	492	491	491	489	487	484						
		3,500		2.71	1.14	0.38	0.16	0.07	25	30	37	44	59	75						
		5,000	6.6	3.87	1.62	0.55	0.22	0.11	494	493	491	490	488	485						
		7,500		5.81	2.44	0.82	0.33	0.16	28	34	40	47	61	75						
		10,000																		
		15,000																		
		20,000																		
		25,000																		
50,000																				
75,000																				
100,000																				
150,000																				
200,000																				
250,000																				

(NOTE) For speeds not shown on the pump hydraulic charts, consult factory.



# SU

## PUMP HYDRAULIC SIZE CHART

SEC. 500

Page 135.3

February 2025

**389 GPM**

**350 RPM**

NOMINAL		VISCOSITY		N.I.P.R.	FRICTION PIPE LOSS (PSI/FT) <small>(Schedule 40 Steel Pipe)</small>					CAPACITY (GPM)				H.P. REQUIRED				
GPM	RPM	ROTOR TRIM	(SSU)	(PSIa)	PIPE DIAMETER					MEDIUM-DUTY & HEAVY-DUTY				HEAVY-DUTY ONLY				
					2½"	3"	4"	5"	6"	DIFFERENTIAL PRESSURE (PSI)				150	200	300	400	
<b>389</b>	<b>350</b>	STD	28	2.7	0.42	0.14	0.03	0.01	0.00	329	320	315	309					
			32		0.44	0.14	0.04	0.01	0.00	9.5	16	22	28					
			38	2.7	0.46	0.15	0.04	0.01	0.01	330	320	319	310	305				
			50		0.49	0.17	0.04	0.01	0.01	9.8	16	23	28	40				
			70	2.7	0.54	0.19	0.05	0.02	0.01	333	325	320	316	310	305			
			100		0.59	0.21	0.06	0.02	0.01	10	16	23	29	40	49			
			150	2.7	0.64	0.23	0.06	0.02	0.01	342	335	330	325	320	312			
			200		0.69	0.24	0.07	0.02	0.01	11	17	24	29	41	50			
			300	2.7	0.77	0.27	0.08	0.03	0.01	365	362	360	356	349	340			
			500		0.88	0.32	0.09	0.03	0.01	12	18	24	29	41	51			
		750	2.7	1.00	0.36	0.07	0.03	0.01	376	374	372	370	360	354				
		1,000		1.09	0.26	0.09	0.04	0.02	13	19	24	30	41	52				
		2,000	3.8	1.23	0.52	0.17	0.07	0.03	392	391	390	389	387	385				
		3,500		2.16	0.90	0.30	0.12	0.06	17	23	28	33	45	57				
		5,000	4.6	3.08	1.29	0.44	0.18	0.08	391	390	388	387	385	382				
		7,500		4.62	1.94	0.65	0.27	0.13	20	25	30	35	46	58				
		10,000	5.7	6.16	2.58	0.87	0.35	0.17	391	390	388	387	385	372				
		15,000		9.24	3.87	1.31	0.53	0.25	23	28	34	43	49	61				
		20,000	7.3	12.32	5.17	1.74	0.71	0.34	372	371	371	370	366	363				
		25,000		15.40	6.46	2.18	0.88	0.42	30	34	39	45	54	64				
50,000	"D"																	
75,000																		
100,000																		
150,000																		
200,000																		
250,000																		

(NOTE) For speeds not shown on the pump hydraulic charts, consult factory.



# SU

## PUMP HYDRAULIC SIZE CHART

SEC. 500

Page 135.4

February 2025

**310 GPM**  
**280 RPM**

NOMINAL		VISCOSITY		N.I.P.R.	FRICTION PIPE LOSS (PSI/FT) <small>(Schedule 40 Steel Pipe)</small>					CAPACITY (GPM)				H.P. REQUIRED				
GPM	RPM	ROTOR TRIM	(SSU)	(PSIa)	PIPE DIAMETER					MEDIUM-DUTY & HEAVY-DUTY				HEAVY-DUTY ONLY				
					2½"	3"	4"	5"	6"	DIFFERENTIAL PRESSURE (PSI)				150	200	300	400	
<b>310</b>	<b>280</b>	STD	28	1.8	0.27	0.09	0.02	0.01	0.00	260	251	247	239					
			32		0.28	0.09	0.02	0.01	0.00	6.7	12	18	23					
			38	1.8	0.30	0.10	0.03	0.01	0.00	261	252	259	240	236				
			50		0.32	0.11	0.03	0.01	0.00	7.0	12	18	23	29				
			70	1.8	0.36	0.12	0.03	0.01	0.00	264	256	252	245	240	235			
			100		0.39	0.14	0.04	0.01	0.01	7.3	12	18	23	29	34			
			150	1.8	0.43	0.15	0.04	0.01	0.01	271	265	260	255	250	242			
			200		0.46	0.16	0.05	0.02	0.01	7.5	13	18	23	30	36			
			300	1.8	0.52	0.18	0.05	0.02	0.01	291	287	285	280	272	269			
			500		0.60	0.22	0.06	0.01	0.01	8.2	14	19	23	32	40			
		750	1.8	0.68	0.15	0.05	0.02	0.01	301	299	297	292	285	280				
		1,000		0.49	0.21	0.07	0.03	0.01	9.5	14	19	23	32	41				
		2,000	2.5	0.98	0.41	0.14	0.06	0.03	314	313	312	310	307	301				
		3,500		1.72	0.72	0.24	0.10	0.05	12	16	21	26	35	44				
		5,000	3.1	2.45	1.03	0.35	0.14	0.07	313	312	311	310	307	305				
		7,500		3.68	1.54	0.52	0.21	0.10	14	18	23	27	35	44				
		10,000	3.8	4.91	2.06	0.69	0.28	0.13	310	309	309	309	305	303				
		15,000		7.36	3.09	1.04	0.42	0.20	17	21	24	30	38	44				
		20,000	4.9	9.82	4.12	1.39	0.56	0.27	307	306	305	304	302	300				
		25,000		12.27	5.15	1.74	0.71	0.34	21	25	28	33	41	50				
50,000	5.9	24.54	10.29	3.47	1.41	0.67	307	306	305	304	303	300						
75,000		36.81	15.44	5.21	2.12	1.01	39	44	46	51	60	66						
100,000	7.2	49.08	20.59	6.94	2.82	1.35	307	306	305	304	302	300						
150,000		73.62	30.88	10.41	4.23	2.02	66	70	72	78	85	90						
200,000																		
250,000																		

(NOTE) For speeds not shown on the pump hydraulic charts, consult factory.



# SU

## PUMP HYDRAULIC SIZE CHART

SEC. 500

Page 135.5

February 2025

220 GPM

200 RPM

NOMINAL		VISCOSITY		N.I.P.R.	FRICTION PIPE LOSS (PSI/FT) <small>(Schedule 40 Steel Pipe)</small>					CAPACITY (GPM)				H.P. REQUIRED						
GPM	RPM	ROTOR TRIM	(SSU)	(PSIa)	PIPE DIAMETER					MEDIUM-DUTY & HEAVY-DUTY				HEAVY-DUTY ONLY						
					DIFFERENTIAL PRESSURE (PSI)															
					2½"	3"	4"	5"	6"	25	50	75	100	150	200	300	400			
220	200	STD	28	1.3	0.14	0.05	0.01	0.00	0.00	180	174	169	159							
			32		0.15	0.05	0.01	0.00	0.00	5.0	9.0	13	16							
			38	1.3	0.16	0.05	0.01	0.00	0.00	181	175	170	160	150						
			50		0.17	0.06	0.02	0.01	0.00	5.2	9.0	13	16	22						
			70	1.3	0.19	0.07	0.02	0.01	0.00	184	179	173	164	154	144					
			100		0.21	0.08	0.02	0.01	0.00	5.4	9.1	13	16	22	27					
			150	1.3	0.24	0.08	0.02	0.01	0.00	190	185	180	173	163	153					
			200		0.26	0.09	0.03	0.01	0.00	5.6	9.2	13	16	22	28					
			300	1.3	0.29	0.10	0.03	0.01	0.00	209	205	200	195	190	185					
			500		0.34	0.12	0.02	0.01	0.00	5.9	9.2	13	16	22	29					
		750	1.3	0.26	0.11	0.04	0.02	0.01	215	213	209	205	202	198						
		1,000		0.35	0.15	0.05	0.02	0.01	6.1	9.2	13	16	22	29						
		2,000	1.8	0.70	0.29	0.10	0.04	0.02	225	224	223	221	218	215						
		3,500		1.22	0.51	0.17	0.07	0.03	7.0	11	14	18	24	31						
		5,000	2.2	1.74	0.73	0.25	0.10	0.05	223	222	221	220	218	215						
		7,500		2.61	1.10	0.37	0.15	0.07	8.5	12.0	15.0	18.0	24.0	31.0						
		10,000	2.7	3.48	1.46	0.49	0.20	0.10	220	220	219	219	216	214						
		15,000		5.22	2.19	0.74	0.30	0.14	9.9	14	17	19	26	32						
		20,000	3.5	6.97	2.92	0.99	0.40	0.19	218	217	217	216	214	212						
		25,000		8.71	3.65	1.23	0.50	0.24	13	17	21	22	29	35						
50,000	4.3	17.42	7.30	2.46	1.04	0.48	218	217	215	215	214	212								
75,000		26.12	10.96	3.70	1.55	0.72	24	29	33	36	39	44								
100,000	5.2	34.83	14.61	4.93	2.07	0.96	218	217	216	215	214	212								
150,000		52.25	21.92	7.39	3.11	1.43	36	47	50	55	57	65								
200,000	6.8	69.67	29.22	9.85	4.14	1.91	218	217	216	215	214	212								
250,000		87.08	36.53	12.32	5.18	2.39	55	67	72	80	85	90								

(NOTE) For speeds not shown on the pump hydraulic charts, consult factory.



# SU

## PUMP HYDRAULIC SIZE CHART

SEC. 500

Page 135.6

February 2025

**109 GPM**  
**100 RPM**

NOMINAL		VISCOSITY		N.I.P.R.	FRICTION PIPE LOSS (PSI/FT) <small>(Schedule 40 Steel Pipe)</small>					CAPACITY (GPM)				H.P. REQUIRED					
GPM	SPEED RPM	ROTOR TRIM	(SSU)	(PSIa)	PIPE DIAMETER					MEDIUM-DUTY & HEAVY-DUTY				HEAVY-DUTY ONLY					
					2½"	3"	4"	5"	6"	DIFFERENTIAL PRESSURE (PSI)				150	200	300	400		
<b>109</b>	<b>100</b>	<b>STD</b>	28	0.8	0.04	0.01	0.00	0.00	0.00	82	75	64	56						
			32		0.04	0.01	0.00	0.00	0.00	2.5	4.1	5.7	7.2						
			38	0.8	0.04	0.01	0.00	0.00	0.00	83	76	65	58	51					
			50		0.05	0.02	0.00	0.00	0.00	2.5	4.1	5.7	7.2	10.5					
			70	0.8	0.05	0.02	0.01	0.00	0.00	84	78	68	61	55	49				
			100		0.06	0.02	0.01	0.00	0.00	2.5	4.1	5.7	7.2	11	14				
			150	0.8	0.07	0.03	0.01	0.00	0.00	89	84	75	69	64	57				
			200		0.08	0.03	0.01	0.00	0.00	2.5	4.1	5.7	7.2	11.0	14				
			300	0.8	0.09	0.02	0.01	0.00	0.00	102	98	94	93	88	84				
			500		0.09	0.04	0.01	0.00	0.00	2.5	4.1	5.7	7.2	11	14				
		750	0.8	0.13	0.05	0.02	0.01	0.00	107	104	102	100	98	95					
		1,000		0.17	0.07	0.02	0.01	0.00	2.5	4.1	5.7	7.2	11	14					
		2,000	1.1	0.35	0.14	0.05	0.02	0.01	112	111	110	109	107	105					
		3,500		0.60	0.25	0.09	0.03	0.02	3.0	4.8	7.1	9.0	12	16					
		5,000	1.4	0.86	0.36	0.12	0.05	0.02	112	111	110	109	107	105					
		7,500		1.29	0.54	0.18	0.07	0.04	3.5	5.0	6.4	8.0	11	14					
		10,000	1.7	1.73	0.72	0.24	0.10	0.05	109	109	108	107	105	103					
		15,000		2.59	1.09	0.37	0.15	0.07	4.3	5.5	7.0	8.5	12	15					
		20,000	2.2	3.45	1.45	0.49	0.20	0.09	107	106	105	104	103	101					
		25,000		4.31	1.81	0.61	0.25	0.12	5.0	6.4	8.0	9.6	13	16					
50,000	2.6	8.63	3.62	1.22	0.50	0.24	108	106	105	104	103	101							
75,000		12.94	5.43	1.83	0.74	0.36	7.2	8.1	10	11	13	17							
100,000	3.2	17.26	7.24	2.44	0.99	0.47	108	106	105	104	103	101							
150,000		25.89	10.86	3.66	1.49	0.71	9	11	13	15	18	21							
200,000	4.2	34.52	14.48	4.88	1.98	0.95	108	106	105	104	103	101							
250,000		43.15	18.10	6.10	2.48	1.18	13	15	17	19	21	25							

(NOTE) For speeds not shown on the pump hydraulic charts, consult factory.

