



Standard Centrifugal Pump

Basic Pedestal

Model 66B52-B

Size 6" x 6"

PUMP SPECIFICATIONS

Size: 6" (152 mm) Female NPT Suction x 6" (152mm) Flanged Discharge.

Volute Casing: Gray Iron No. 30. Maximum Operating Pressure 170 psi (1172 kPa).*

Enclosed Type, Six Vane Impeller: Gray Iron No. 30. Handles 11/16" (17,5 mm) Diameter Spherical Solids.

Impeller Shaft: Alloy Steel No. 4140.

Replaceable Wear Ring: Copper Alloy No. C83600.

Replaceable Balance Ring: Copper Alloy No. C83600.

Pedestal: Gray Iron No. 30.

Shaft Sleeve: Alloy Steel No. 4140.

Radial/Thrust Bearings: Single Row Ball.

Bearing Lubrication: No. 2 Lithium Base Grease.

Suction Head: Gray Iron No. 30.

Gaskets: Vegetable Fiber.

Hardware: Standard Plated Steel.

Strainer.

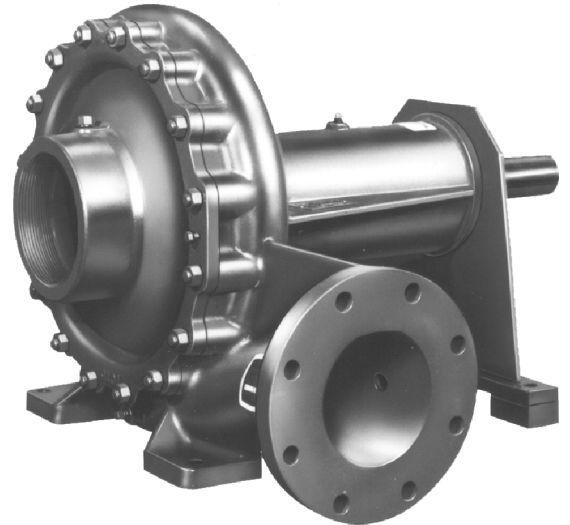

Optional Equipment: 6" NPT Discharge Flange. Discharge Check Valve. Hand Primer.

SEAL SPECIFICATIONS

Type 43, Mechanical Self-Lubricated. Silicone Carbide Rotating Face and Stationary Seat. Fluorocarbon Elastomers (DuPont Viton® or Equivalent). Stainless Steel 18-8 Cage and Spring. Maximum Temperature of Liquid Pumped, 160°F (71°C).*

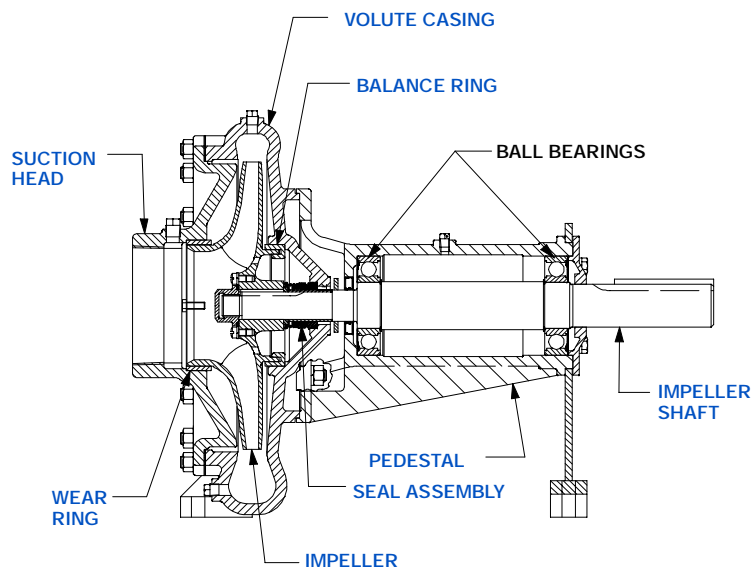

SEAL DETAIL

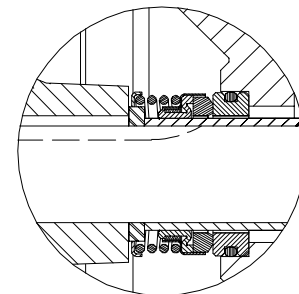

* Consult Factory for Applications Exceeding Maximum Pressure and/or Temperature Indicated.



THE GORMAN-RUPP COMPANY • MANSFIELD, OHIO

GORMAN-RUPP OF CANADA LIMITED • ST. THOMAS, ONTARIO, CANADA

www.gormanrupp.com

Specifications Subject to Change Without Notice

Printed in U.S.A.

Specification Data

APPROXIMATE
DIMENSIONS and WEIGHTS

NET WEIGHT: 490 LBS. (222,3 KG.)
SHIPPING WEIGHT: 515 LBS. (233,6 KG.)
EXPORT CRATE: 27.6 CU. FT. (0,78 CU. M.)

SECTION 70, PAGE 1202

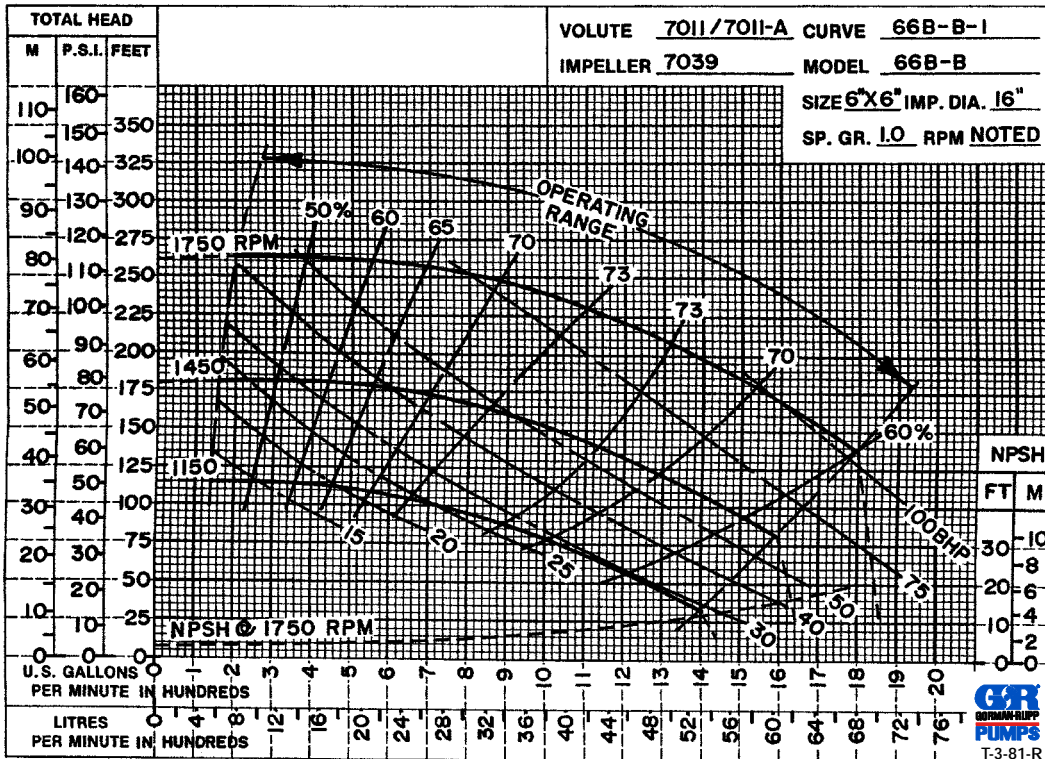
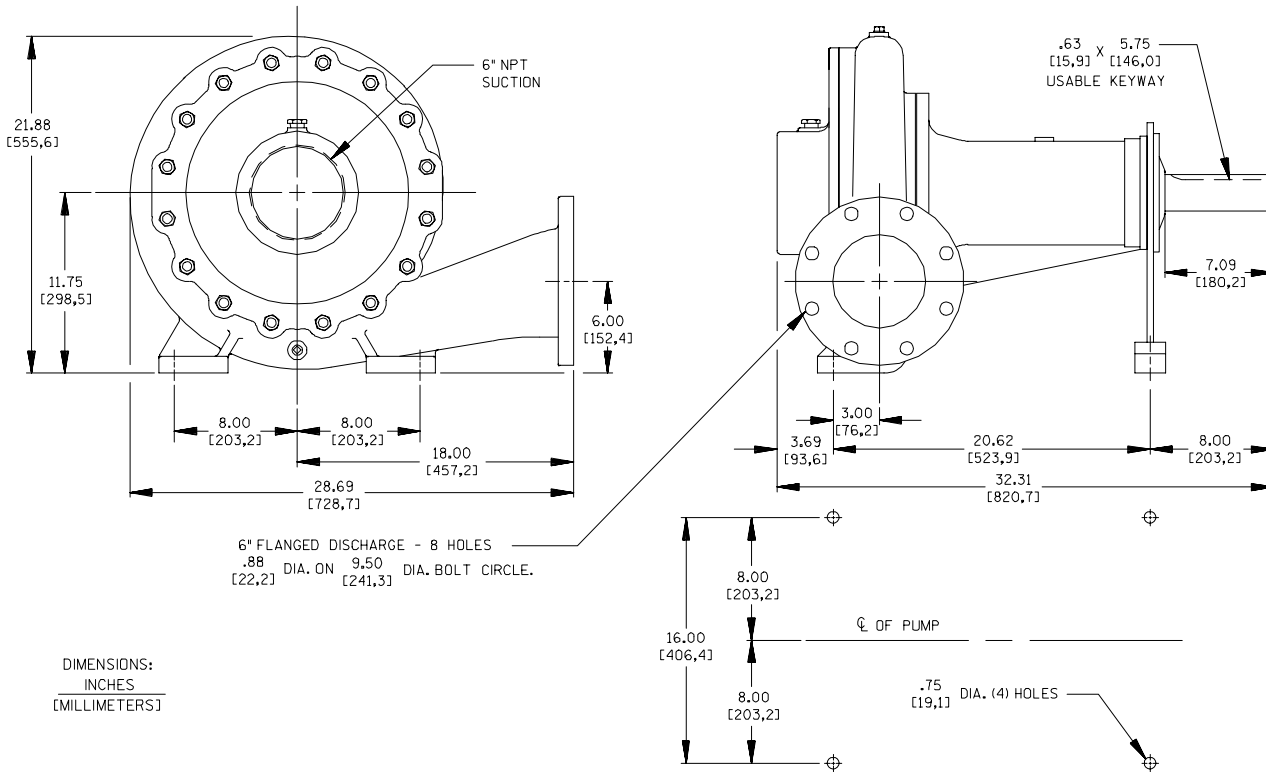

THE GORMAN-RUPP COMPANY • MANSFIELD, OHIO

GORMAN-RUPP OF CANADA LIMITED • ST. THOMAS, ONTARIO, CANADA

Specifications Subject to Change Without Notice

Printed in U.S.A.