



Standard Centrifugal Pump

Model 6408C60-B

Size 8" x 8"



PUMP SPECIFICATIONS

- Size:** 8" x 8" (203,2 mm x 203,2 mm) Flanged.
- Casing:** Ductile Iron 65-45-12.
Maximum Operating Pressure 57 psi (393 kPa).*
- Impeller:** Ductile Iron 65-45-12.
Handles 3" (76,2 mm) Diameter Spherical Solids.
- Impeller Shaft:** Alloy Steel 4150.
- Shaft Sleeve:** Alloy Steel 4130.
- Seal Plate:** Ductile Iron 65-45-12.
- Bearing Housing:** Gray Iron 30.
- Radial Bearing:** Open Double Row Ball.
- Thrust Bearing:** Open Double Row Ball.
- Bearing and Seal Cavity Lubrication:** SAE 30 Non-Detergent Oil.
- Gaskets:** Cork.
- O-Rings:** Buna-N. Fluorocarbon FKM, (Viton® or Equivalent)
- Hardware:** Standard Plated Steel.
- Bearing and Seal Cavity Oil Level Sight Gauges.**
- Optional Equipment:** Suction Spool w/Clean-out.



**Consult Factory for Applications Exceeding Maximum Pressure and/or Temperature Indicated.*

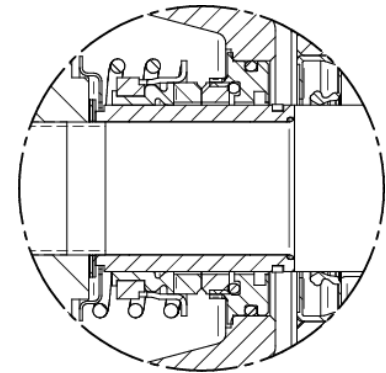
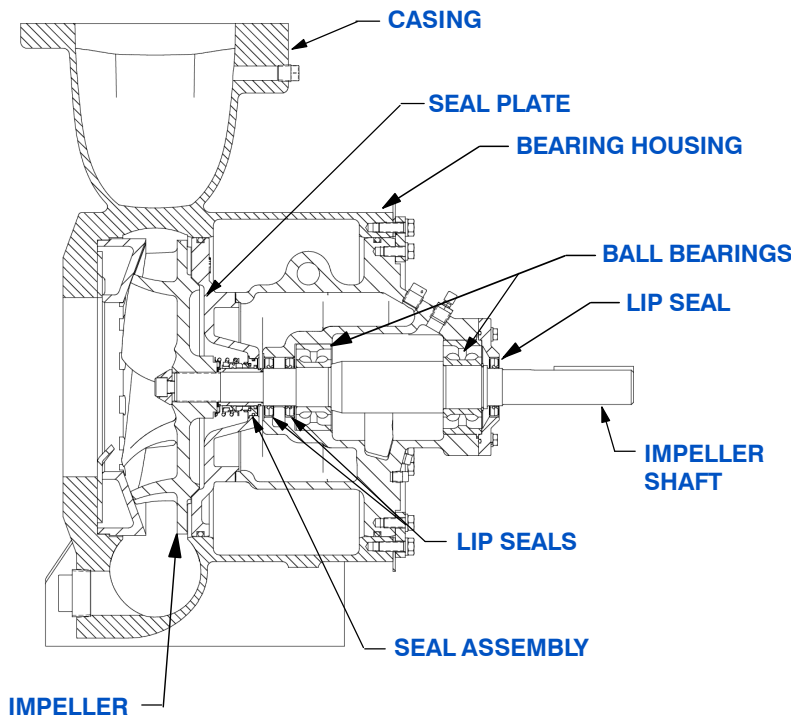

SEAL DETAIL

Cartridge Type, Mechanical, Oil-Lubricated, Double Floating, Self-Aligning. Silicon Carbide Rotating and Stationary Faces. Stainless Steel 316 Stationary Seat. Fluorocarbon Elastomers (DuPont Viton® or Equivalent). Stainless Steel 18-8 Cage and Spring. Maximum Temperature of Liquid Pumped, 160°F (71°C).*



GORMAN-RUPP PUMPS

www.grpumps.com

Specifications Subject to Change Without Notice

Printed in U.S.A.

Specification Data

SECTION 64, PAGE 820

APPROXIMATE DIMENSIONS and WEIGHTS

NET WEIGHT: 610 LBS. (277 KG.)*
SHIPPING WEIGHT: 700 LBS. (318 KG.)*
EXPORT CRATE: 22.4 CU. FT. (0,63 CU. M.)

SUCTION:
 8.00 NOMINAL WITH 8 HOLES
 TAPPED .750-10 UNC-2B X 1.00 DEEP
 EQUALLY SPACED ON A
 11.75/[298,4] DIA BC

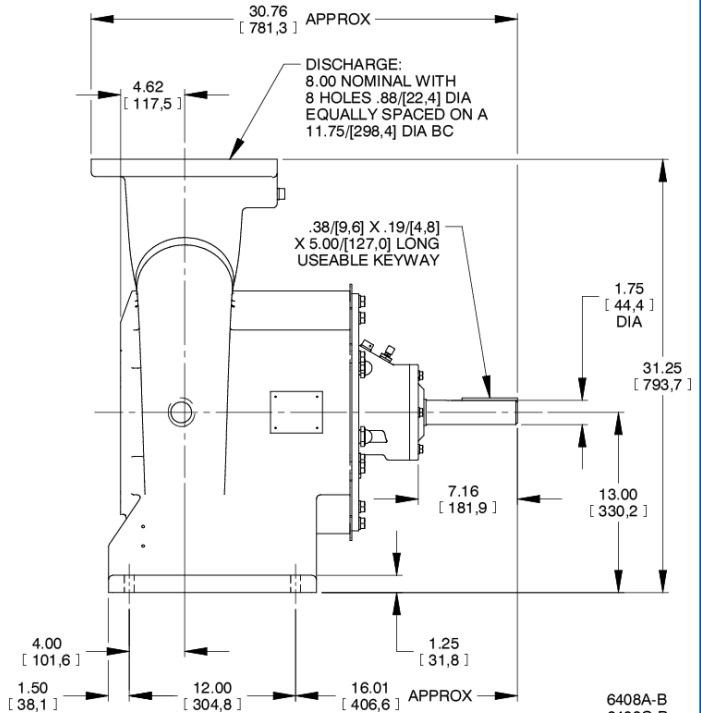
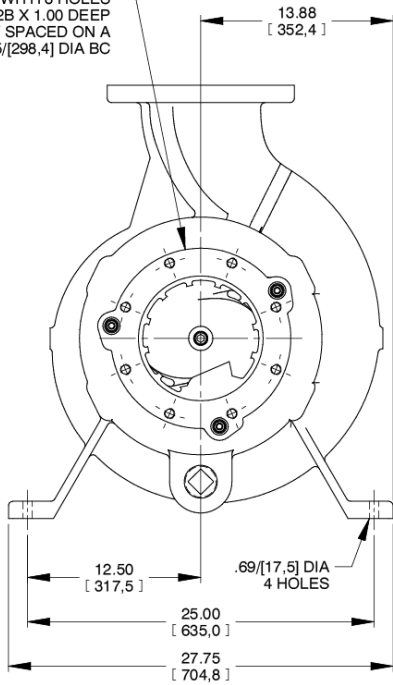

DISCHARGE:
 8.00 NOMINAL WITH
 8 HOLES .88/[22,4] DIA
 EQUALLY SPACED ON A
 11.75/[298,4] DIA BC

.38/[9,6] X .19/[4,8]
 X 5.00/[127,0] LONG
 USEABLE KEYWAY

6408A-B
 6408C-B
 6408D-B
 6408E-B

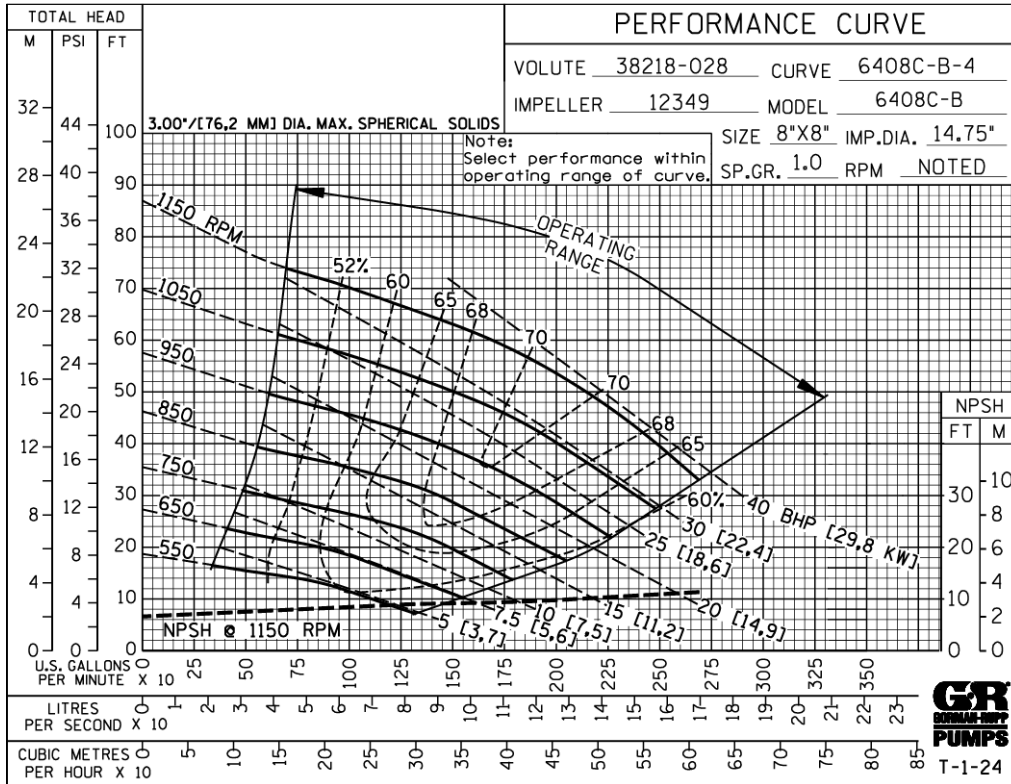

GORMAN-RUPP PUMPS

www.grpumps.com

Specifications Subject to Change Without Notice

Printed in U.S.A.