

A C D E



Self Priming Centrifugal Pump

Models 13C2-B and 13C20-B

Size 3" x 3"

PUMP SPECIFICATIONS

Size: 3" x 3" (76 mm x 76 mm) NPT - Female.

Casing: Gray Iron 30.

Maximum Operating Pressure 70 psi (483 kPa).*

Semi-Open, Two Vane Impeller: Ductile Iron 60-40-18.

Handles 2 1/2" (63,5 mm) Diameter Spherical Solids.

Impeller Shaft: Carbon Steel 1045.

Replaceable Wear Plate: Carbon Steel C1015.

Removable Cover Plate: Gray Iron 30. Weight 15 lbs. (7 kg).

Pedestal: Gray Iron 30.

Seal Plate: Gray Iron 30.

Flap Valve: Neoprene ^w/Steel Reinforcing.

Seal Liner: (13C2-B) Copper Alloy C26000.

Shaft Sleeve: (13C20-B) Alloy Steel 4150.

Radial and Thrust Bearings: Open Single Row Ball.

Bearing Lubrication: SAE 30 Non-Detergent Oil.

Flange: Gray Iron 30.

Gaskets: Buna-N, Vegetable Fiber and Rubber.

Hardware: Standard Plated Steel.

Optional Equipment: Strainer. Gray Iron 30 Suction and Discharge Flanges. Casing Heater 120 Volt / 240 Volt. High Temp Shut Down Kit.

**Consult Factory for Applications Exceeding Maximum Pressure and/or Temperature Indicated.*

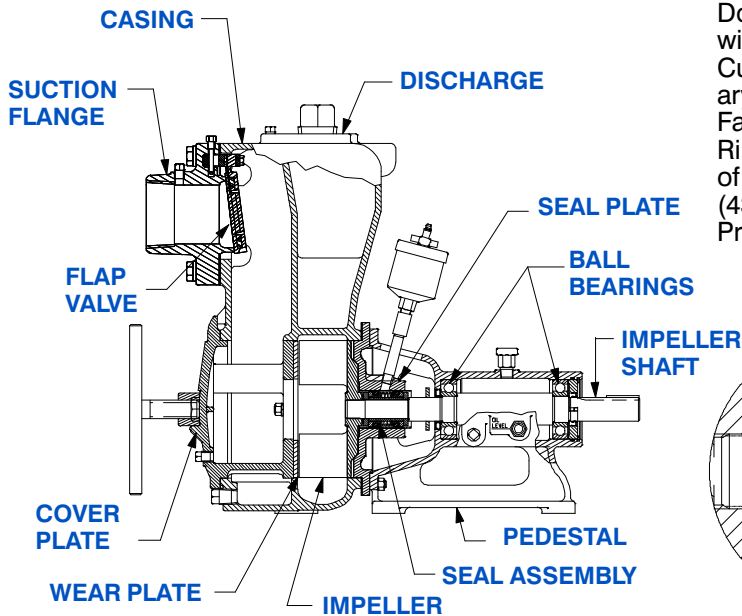

13C2-B SHOWN

13C2-B SEAL DETAIL

Double, Grease-Lubricated with Spring-Loaded Grease Cup. Sintered Bronze Stationary Seal Seats. Steel Rotating Faces. Neoprene Packing Rings. Maximum Temperature of Liquid Pumped, 110°F (43°C). Maximum Suction Pressure 10 PSI (69 kPa).*

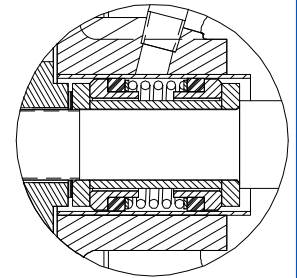

13C20-B SEAL DETAIL

Mechanical, Oil-Lubricated, Double Floating, Self-Aligning. Tungsten Titanium Carbide Rotating and Stationary Faces. Stainless Steel 316 Stationary Seat. Fluorocarbon Elastomers (DuPont Viton® or Equivalent). Stainless Steel 18-8 Cage and Spring. Maximum Temperature of Liquid Pumped, 160°F (71°C).*

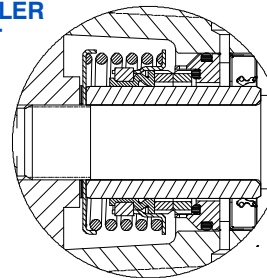

THE GORMAN-RUPP COMPANY • MANSFIELD, OHIO

GORMAN-RUPP OF CANADA LIMITED • ST. THOMAS, ONTARIO, CANADA

www.grpumps.com

Specifications Subject to Change Without Notice

Printed in U.S.A.

Specification Data

SECTION 55, PAGE 500

APPROXIMATE
DIMENSIONS and WEIGHTS

NET WEIGHT: 207 LBS. (94 KG.)

SHIPPING WEIGHT: 217 LBS. (98 KG.)

EXPORT CRATE SIZE: 7.9 CU. FT. (0,22 CU. M.)

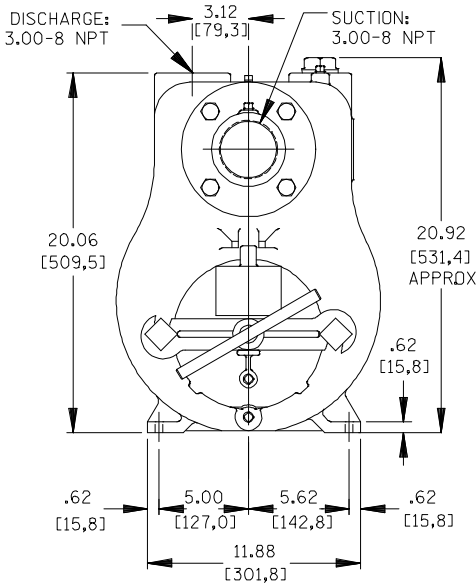

DIMENSIONS:
INCHES
[MILLIMETERS]

*18.00/[457,2] RECOMMENDED FOR
REMOVAL OF BACK COVER PLATE
7.50/[190,5] REQUIRED FOR
REMOVAL OF BACK COVER PLATE

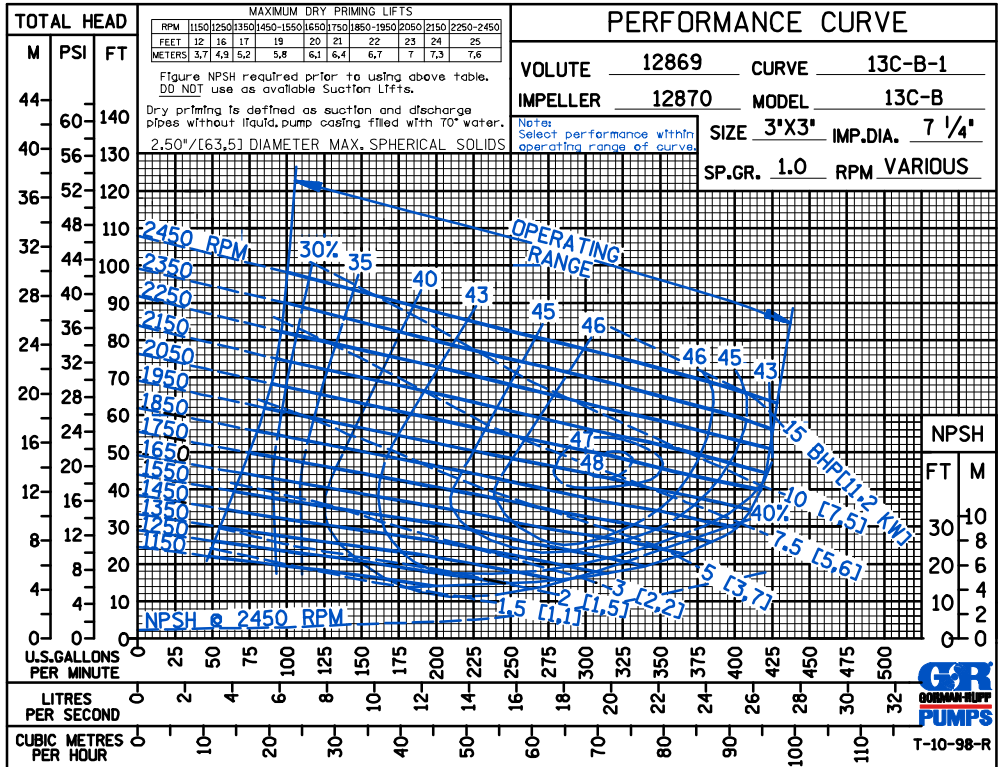
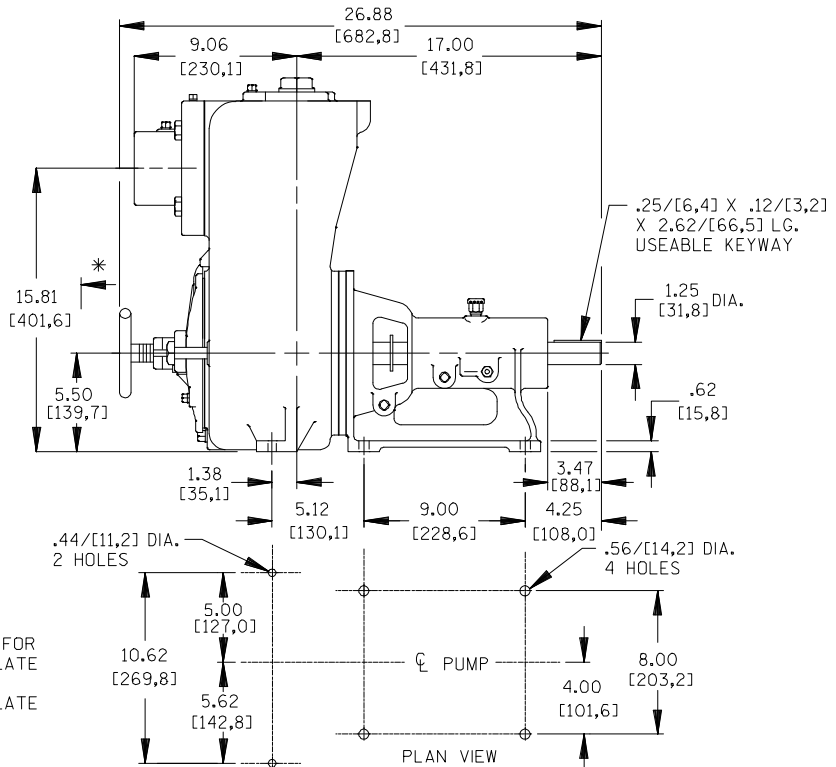

THE GORMAN-RUPP COMPANY • MANSFIELD, OHIO

GORMAN-RUPP OF CANADA LIMITED • ST. THOMAS, ONTARIO, CANADA

Specifications Subject to Change Without Notice

Printed in U.S.A.

ACDE

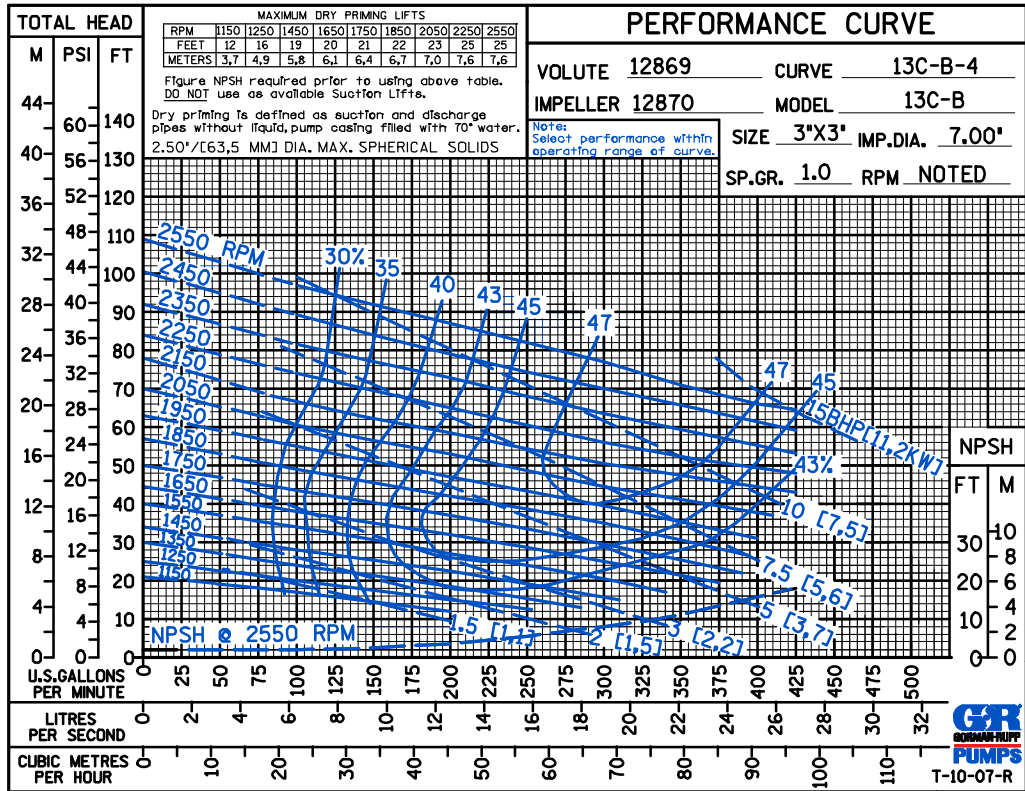

PERFORMANCE
BASED ON
WATER

TRIMMED
IMPELLER

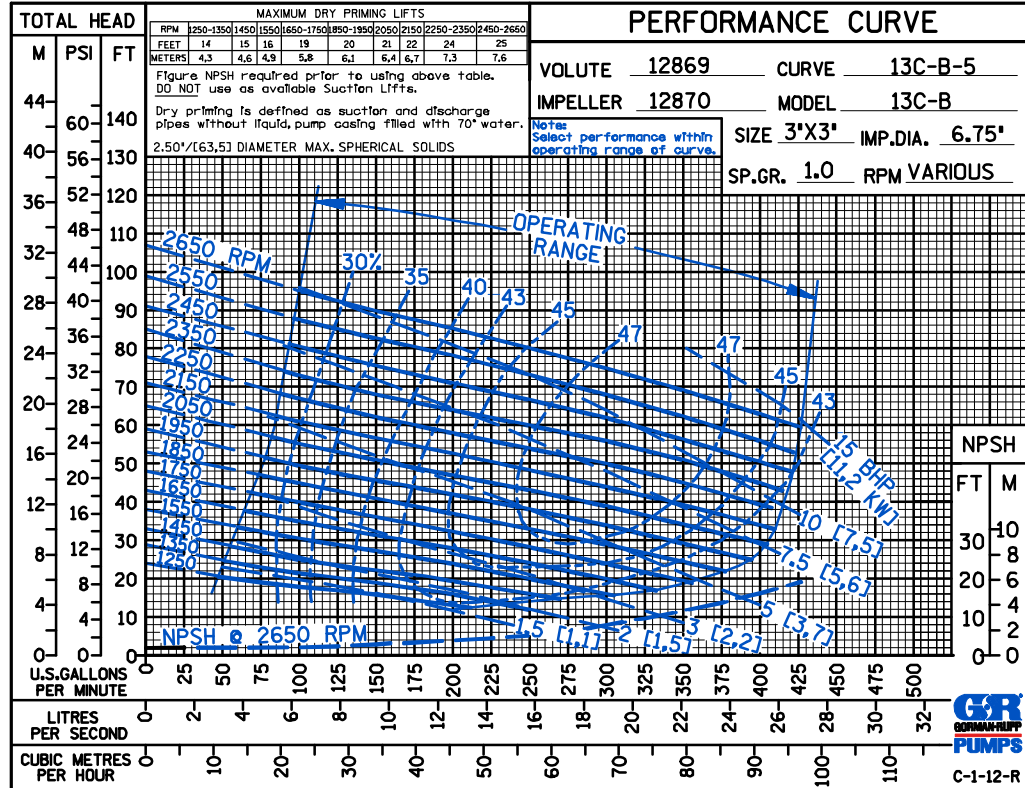

PERFORMANCE
BASED ON
WATER

TRIMMED
IMPELLER



THE GORMAN-RUPP COMPANY • MANSFIELD, OHIO

GORMAN-RUPP OF CANADA LIMITED • ST. THOMAS, ONTARIO, CANADA

Specifications Subject to Change Without Notice

Printed in U.S.A.

ACDE

PERFORMANCE
BASED ON
WATER

TRIMMED
IMPELLER

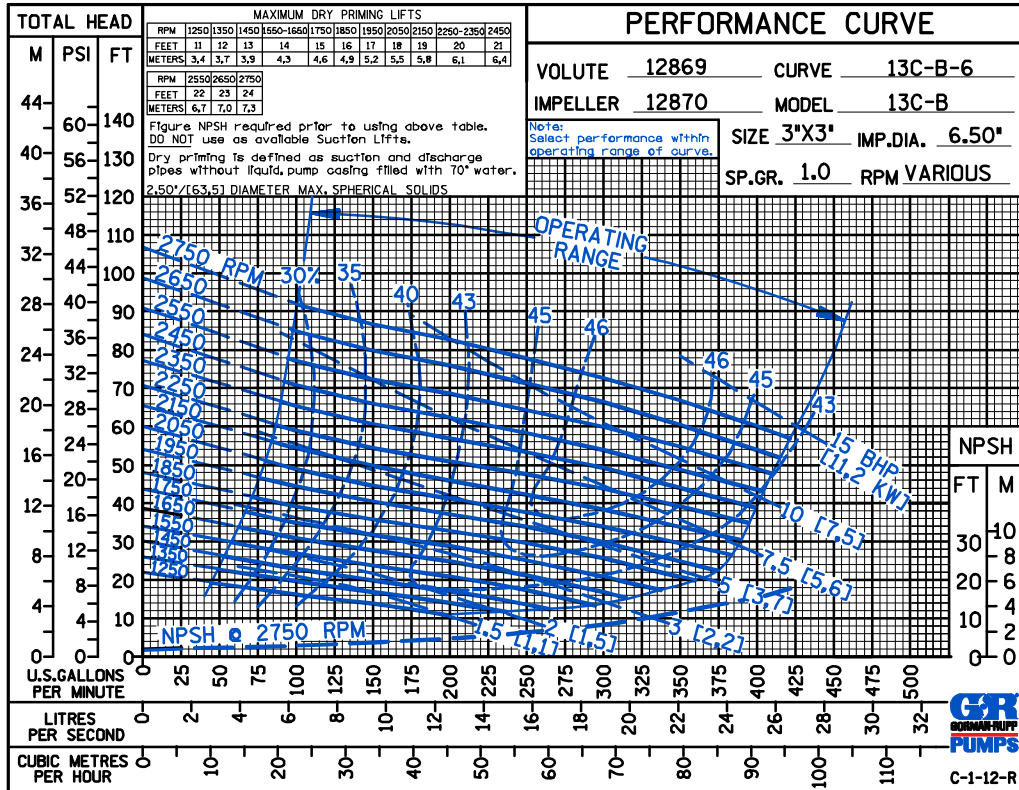

PERFORMANCE
BASED ON
WATER

TRIMMED
IMPELLER

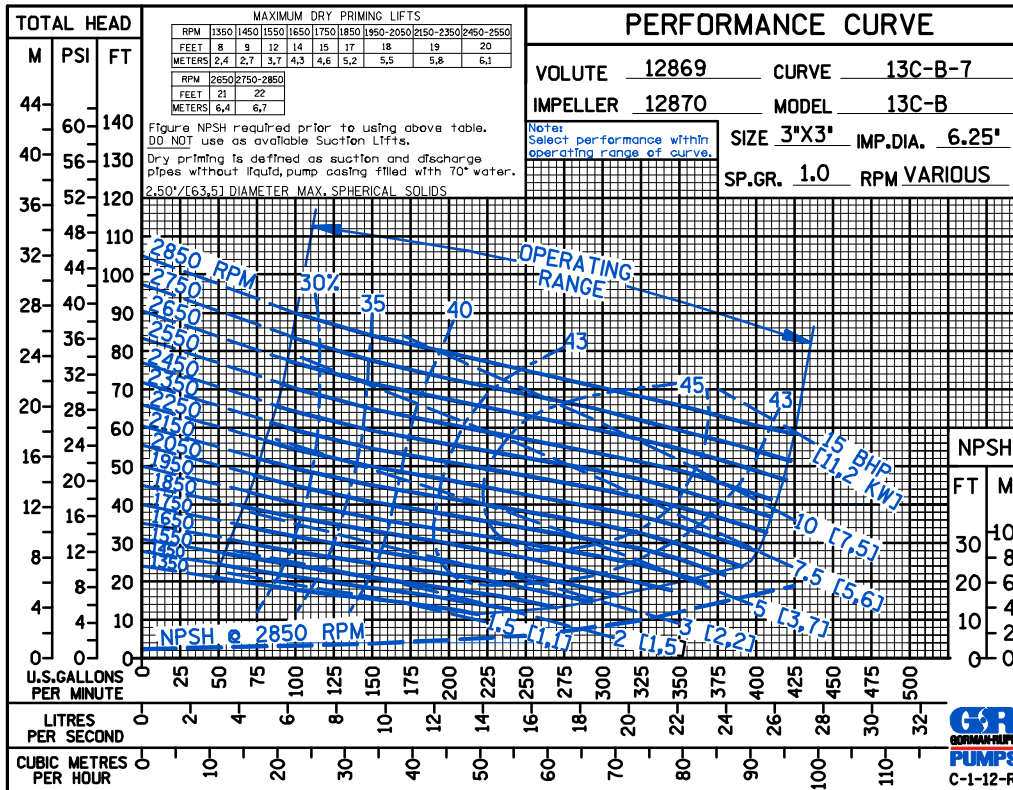

THE GORMAN-RUPP COMPANY • MANSFIELD, OHIO

GORMAN-RUPP OF CANADA LIMITED • ST. THOMAS, ONTARIO, CANADA

Specifications Subject to Change Without Notice

Printed in U.S.A.

ACDE

PERFORMANCE
BASED ON
WATER

TRIMMED
IMPELLER

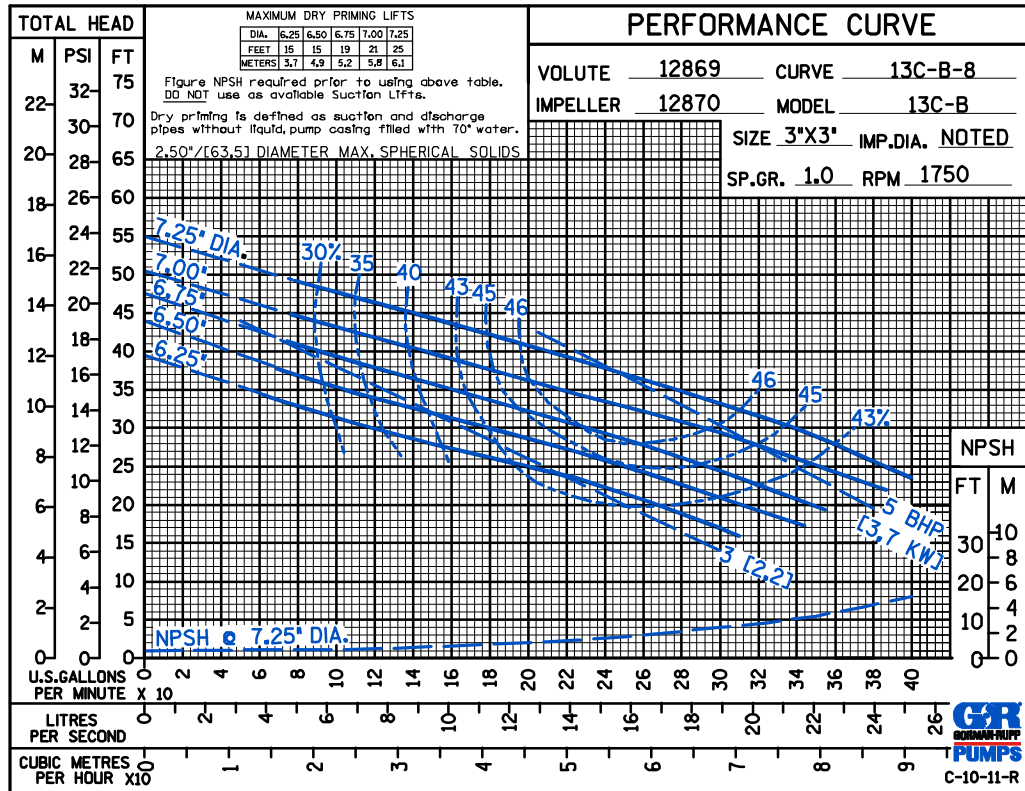

PERFORMANCE
BASED ON
WATER

TRIMMED
IMPELLER

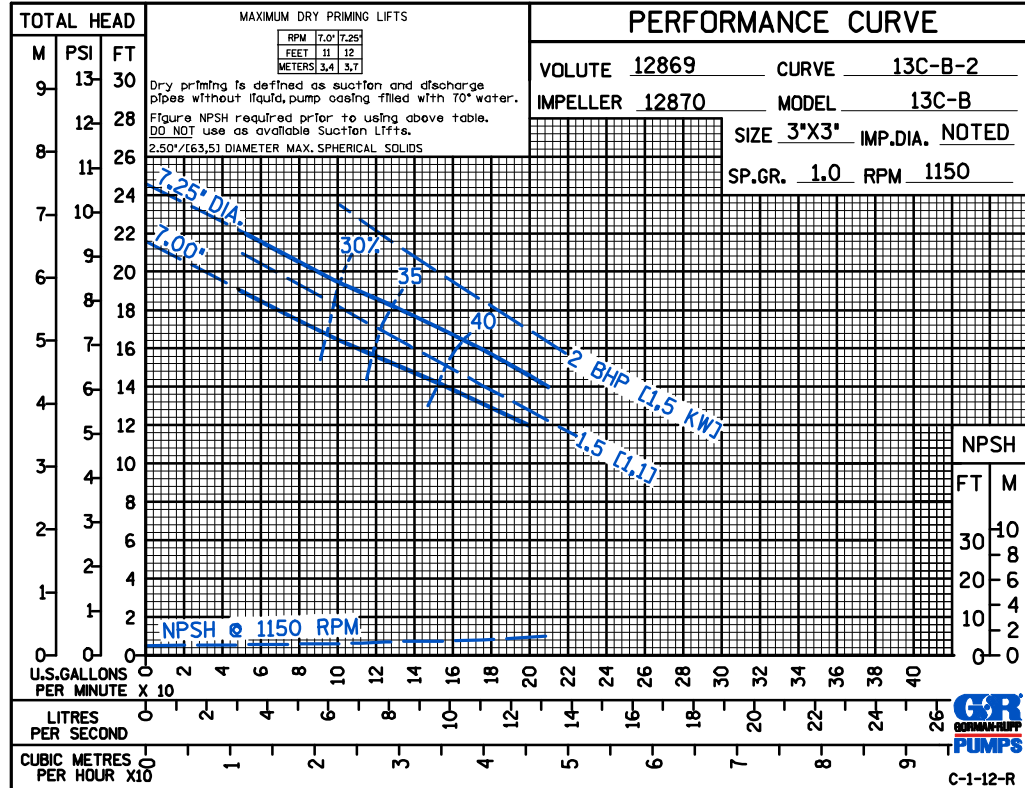

THE GORMAN-RUPP COMPANY • MANSFIELD, OHIO

GORMAN-RUPP OF CANADA LIMITED • ST. THOMAS, ONTARIO, CANADA

Specifications Subject to Change Without Notice

Printed in U.S.A.