



***PRIME-AIRE<sup>®</sup>* SERIES**  
**PUMP MODEL**  
**PA6C60-4045T-ESP**

**MANUAL**  
**PART 2 of 3**

**PARTS**  
**LIST**  
**WITH**  
**PERFORMANCE CURVE**

**THE GORMAN-RUPP COMPANY • MANSFIELD, OHIO**

GORMAN-RUPP OF CANADA LIMITED • ST. THOMAS, ONTARIO, CANADA Printed in U.S.A.

[www.gormanrupp.com](http://www.gormanrupp.com)

©Copyright by the Gorman-Rupp Company



**The engine exhaust from this product contains chemicals known to the State of California to cause cancer, birth defects or other reproductive harm.**

## PERFORMANCE CURVE – SECTION A

### RECORDING MODEL AND SERIAL NUMBERS

Please record the pump model and serial number in the spaces provided below and in the separate Installation/Operation Manual accompanying your pump. Your Gorman-Rupp distributor needs this information when you require parts or service.

Pump Model: \_\_\_\_\_

Serial Number: \_\_\_\_\_

### WARRANTY INFORMATION

The pump warranty is provided as part of Gorman-Rupp's support program for customers who operate and maintain their equipment as described in this manual and other accompanying literature. Please note that should the equipment be abused or modified to change its performance beyond the original factory specifications, the warranty will become void and any claim will be denied.

### PERFORMANCE CURVE

The performance curve on the following page is based on 70° F (21° C) clear water at sea level, with minimum suction lift. Since pump installations are seldom identical, your performance may be different due to such factors as viscosity, specific gravity, elevation, temperature, and impeller trim.

If your pump serial number is followed by an "N", your pump is **NOT** a standard production model. Contact the Gorman-Rupp Company to verify performance or part numbers.

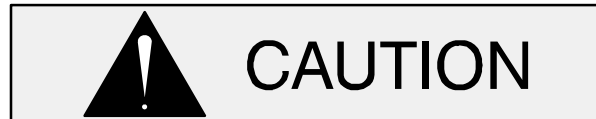

Pump speed and operating condition points must be within the continuous performance range shown on the curve.

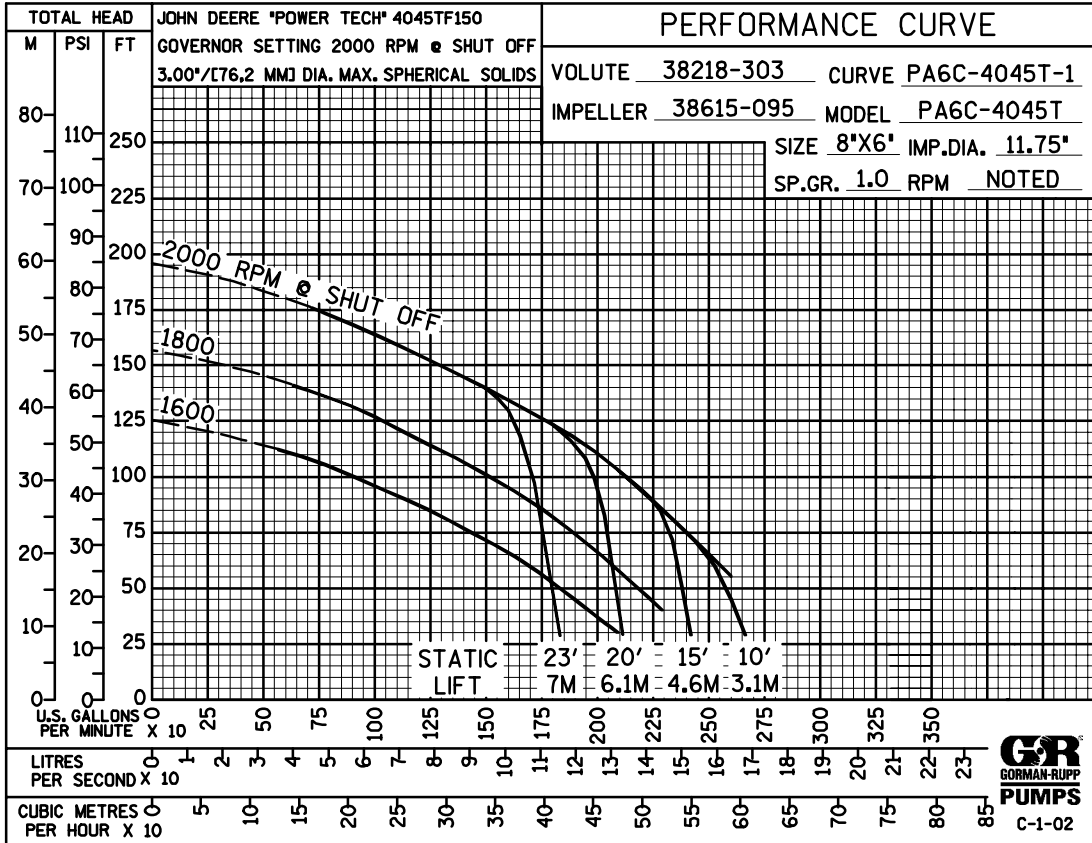

Performance Curve – Model PA6C60-4045T-ESP

**This Page Intentionally Blank**

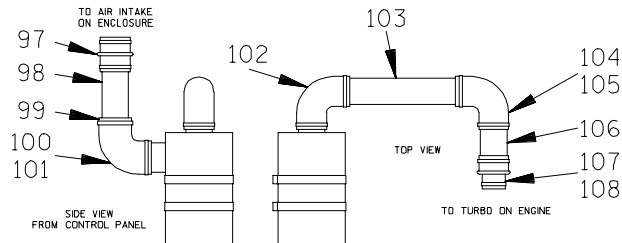
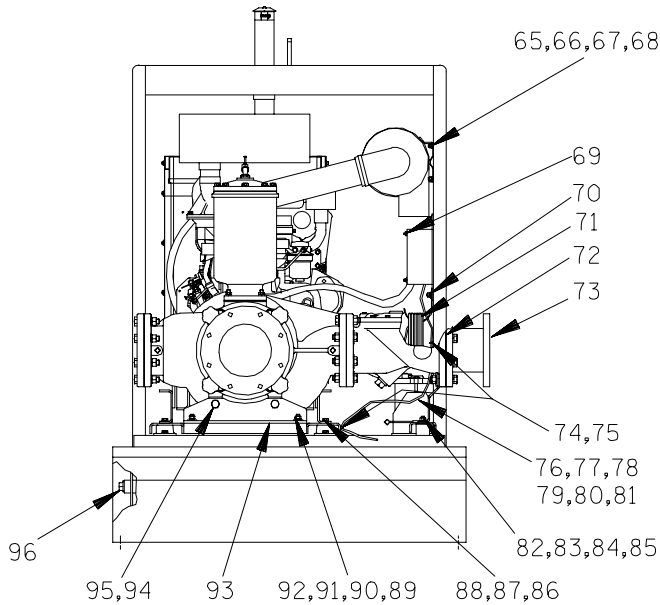
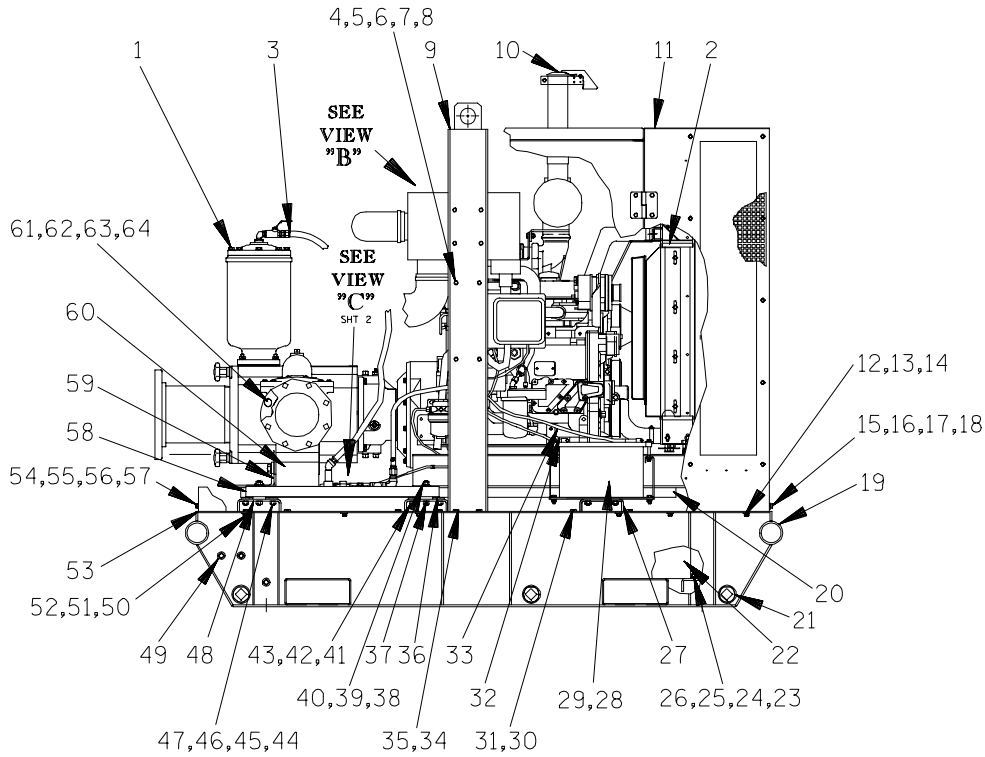

VIEW B  
ROTATED 90°

**THE GORMAN-RUPP COMPANY • MANSFIELD, OHIO**

GORMAN-RUPP OF CANADA LIMITED • ST. THOMAS, ONTARIO, CANADA

Printed in U.S.A.

S/N 1302082N Up  
PUMP ISSUE 1

**PARTS LIST**  
**Pump Model PA6C60-4045T-ESP**

If your pump serial number is followed by an "N", your pump is **NOT** a standard production model. Contact the Gorman-Rupp Company to verify part numbers.

ITEM NO.	PART NAME	PART NUMBER	MAT'L CODE	QTY	ITEM NO.	PART NAME	PART NUMBER	MAT'L CODE	QTY
1	PUMP END ASSY	PA6C60-(4045T)		1	54	HEX HD CAPSCREW	B0504	15991	3
2	ENGINE MODIFICATION	44311-019	----	1	55	FLAT WASHER	K05	15991	3
3	HOSE BARB FITTING	26523-047	----	1	56	LOCK WASHER	J05	15991	3
4	HEX HD CAPSCREW	B0605	15991	4	57	ENCLOSURE MTG ASSY	41881-788	----	1
5	LOCK WASHER	J06	15991	4	58	CROSS RAIL	34414-098	15080	1
6	FLAT WASHER	K06	15991	4	59	PUMP SUPPORT	34265-040	15080	1
7	HEX NUT	D06	15991	4	60	CHK VALVE SUPPORT	34561-009	15080	1
8	MOUNTING BRACKET	34515-012	----	1	61	HEX HD CAPSCREW	B1214	15991	8
9	HOISTING BAIL ASSY	44713-036	24150	1	62	FLAT WASHER	K12	15991	2
10	WEATHER CAP	W/ENGINE	----	REF	63	LOCK WASHER	J12	15991	8
11	ENCLOSURE ASSY	42164-014	----	1	64	HEX NUT	K12	15991	8
	-DOOR W/WINDOW	42142-134	----	1	65	HEX HD CAPSCREW	B0604	15991	4
	-DOOR W/O WINDOW	42142-135	----	1	66	LOCK WASHER	J06	15991	4
12	HEX HD CAPSCREW	B0505	15991	20	67	HEX NUT	D06	15991	4
13	FLAT WASHER	K05	15991	20	68	AIR CLEANER	W/ENGINE	----	REF
14	LOCK WASHER	J05	15991	29	69	FLAT WASHER	K04	15991	4
15	HEX HD CAPSCREW	B0504	15991	5	70	BRACKET	34184-007	15120	1
16	FLAT WASHER	K05	15991	5	71	FLOAT SWITCH KIT	48312-980	----	1
17	LOCK WASHER	J05	15991	5	72	FLANGE GASKET	25113-036	----	1
18	ENCLOSURE MTG ASSY	41881-789	----	1	73	DISCH PIPE ASSY	46353-203	24150	1
19	BASE ASSEMBLY	41565-587	24150	1	74	CABLE TIE MTG BLOCK	27111-352	----	2
20	BASE FRAME	41437-064	24150	1	75	CABLE TIE	27111-205	----	2
21	PIPE PLUG	P32	10009	3	76	PLUG CONNECTOR	27261-301	----	1
22	FUEL TANK ASSY	46711-092	24150	1	77	80" EXTENSION CABLE	18141-147	----	1
23	FLAT WASHER	K07	15991	6	78	SOCKET CONNECTOR	27263-001	----	1
24	LOCK WASHER	J06	15991	6	79	HEX HD CAPSCREW	B0404	15991	2
25	HEX NUT	D06	15991	6	80	LOCK WASHER	J04	15991	2
26	14' FOAM TAPE	18668-003	----	1	81	FLAT WASHER	K04	15991	2
27	CROSS RAIL ASSY	41581-026	24150	1	82	HEX HD CAPSCREW	B0606	15991	2
28	12V BATTERY	SEE OPTIONS		1	83	LOCK WASHER	J06	15991	2
29	BATTERY BOX ASSY	42432-004	----	1	84	FLAT WASHER	K06	15991	2
30	HEX HD CAPSCREW	B0805	15991	4	85	HEX NUT	K06	15991	2
31	LOCK WASHER	J08	15991	4	86	HEX HD CAPSCREW	B0804	15991	6
32	POS BATTERY CABLE	47311-111	----	1	87	LOCK WASHER	J08	15991	6
33	NEG BATTERY CABLE	47311-189	----	1	88	FLAT WASHER	K08	15991	6
34	HEX HD CAPSCREW	B0805	15991	4	89	HEX HD CAPSCREW	B0806	15991	2
35	LOCK WASHER	J08	15991	4	90	LOCK WASHER	J08	15991	2
36	COMPRESSION MOUNT	24631-104	----	6	91	FLAT WASHER	K08	15991	2
37	CROSS RAIL ASSY	41581-027	24150	1	92	HEX NUT	K08	15991	2
38	HEX NUT	K08	15991	4	93	PUMP SHIM SET	48261-045	----	4
39	LOCK WASHER	J08	15991	4	94	HEX HD CAPSCREW	B1206	15991	2
40	FLAT WASHER	K08	15991	4	95	LOCK WASHER	J12	15991	2
41	HEX HD CAPSCREW	B0805	15991	4	96	PIPE PLUG	P20	10009	1
42	LOCK WASHER	J08	15991	4	97	STRAIGH HUMP	W/ENGINE	----	REF
43	FLAT WASHER	K08	15991	4	98	PIPE	W/ENGINE	----	REF
44	STUD MOUNT	24631-011	----	2	99	REDUCING INSERT	W/ENGINE	----	REF
45	LOCK WASHER	J08	15991	4	100	ELBOW	W/ENGINE	----	REF
46	FLAT WASHER	K08	15991	4	101	CLAMP	W/ENGINE	----	REF
47	HEX NUT	D08	15991	4	102	ELBOW	W/ENGINE	----	REF
48	CROSS RAIL ASSY	41581-028	24150	1	103	PIPE	W/ENGINE	----	REF
49	PIPE PLUG	P08	15079	3	104	ELBOW	W/ENGINE	----	REF
50	HEX HD CAPSCREW	B0805	15991	4	105	CLAMP	W/ENGINE	----	REF
51	LOCK WASHER	J08	15991	4	106	PIPE	E/ENGINE	----	REF
52	FLAT WASHER	K08	15991	4	107	HUMP REDUCER	W/ENGINE	----	REF
53	23' FOAM TAPE	18668-003	----	1	108	CLAMP	W/ENGINE	----	REF

**THE GORMAN-RUPP COMPANY • MANSFIELD, OHIO**

GORMAN-RUPP OF CANADA LIMITED • ST. THOMAS, ONTARIO, CANADA

Printed in U.S.A.

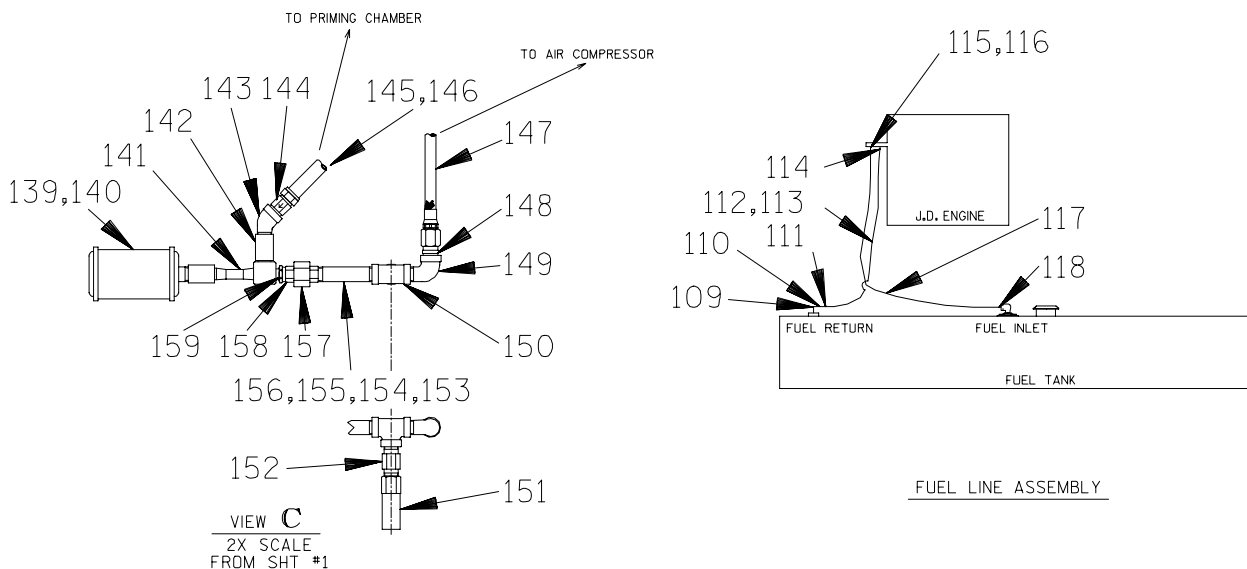
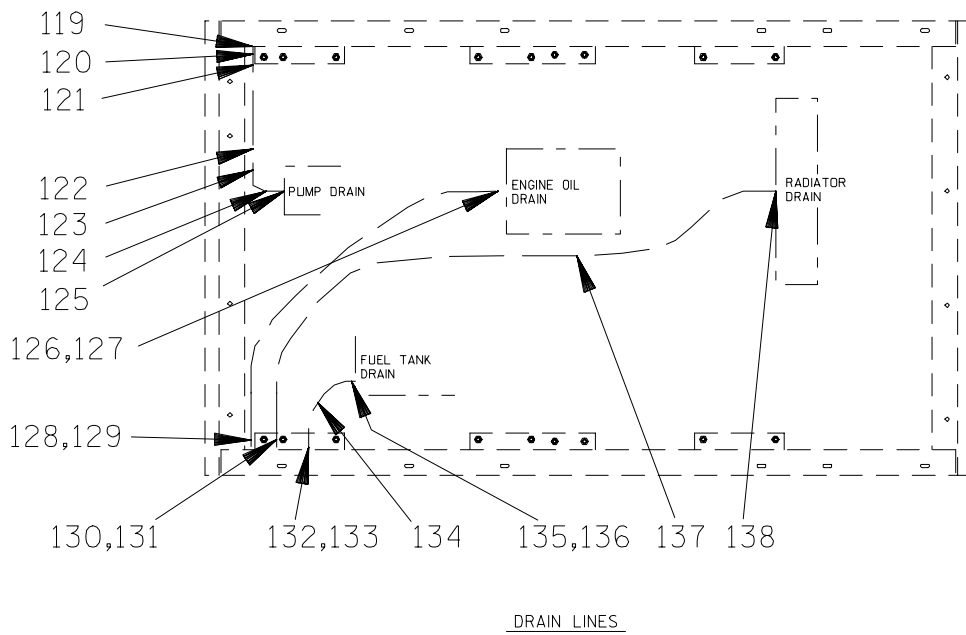
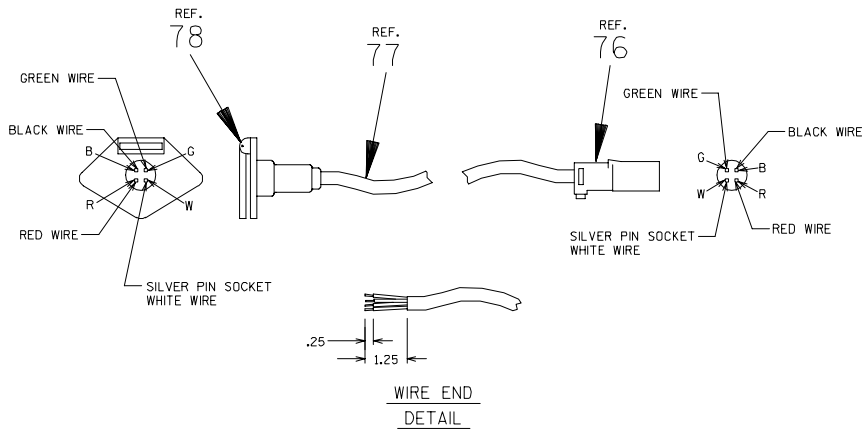

**THE GORMAN-RUPP COMPANY • MANSFIELD, OHIO**

GORMAN-RUPP OF CANADA LIMITED • ST. THOMAS, ONTARIO, CANADA

Printed in U.S.A.

December 21, 2004

© Copyright by the Gorman-Rupp Company



S/N 1302082N Up  
PUMP ISSUE 1

**PARTS LIST**  
**Pump Model PA6C60-4045T-ESP**

If your pump serial number is followed by an "N", your pump is **NOT** a standard production model. Contact the Gorman-Rupp Company to verify part numbers.

ITEM NO.	PART NAME	PART NUMBER	MAT'L CODE	QTY	ITEM NO.	PART NAME	PART NUMBER	MAT'L CODE	QTY
109	STREET ELBOW	RS06	11999	1	156	FLAT WASHER	K08	15991	1
110	RED PIPE BUSHINIG	AP0604	15079	1	157	HEX NUT	D08	15991	1
111	HOSE BARB FITTING	26523-386	----	1	158	PIPE UNION	AH08	11999	1
112	45" HOSE	18513-301	----	1	159	RED PIPE BUSHING	AP0806	15079	1
113	HOSE CLAMP	26518-641	----	2	NOT SHOWN:				
114	HOSE BARB FITTING	26523-386	----	1		WARNING DECAL	38816-319	----	2
115	CONNECTOR	S1447	----	1		PUMP DRAIN LABEL	38816-320	----	1
116	HOSE END	26523-015	----	1		FUEL TANK DRAIN LABEL	38816-321	----	1
117	43" HOSE	18513-054	----	1		RADIATOR DRAIN LABEL	38816-322	----	1
118	MALE HOSE BARB	26523-333	----	1		OIL DRAIN LABEL	38816-323	----	1
119	BUSHING	AP2008	11999	1		LEVEL CONTROL LABEL	38816-332	----	2
120	MALE HOSE END	26525-020	----	2		WARNING DECAL	38816-330	----	2
121	HOSE CLAMP	26518-642	----	2		WARNING DECAL	38816-218	----	1
122	24" LG. HOSE	18513-056	----	2		ENGINE STARTUP TAG	38816-269	----	1
123	BALL VALVE	26631-023	----	1		INSTRUCTION TAG	38817-085	----	1
124	PIPE NIPPLE	T08	15079	1		CAUTION DECAL	2613FJ	----	1
125	STREET ELBOW	RS08	11999	1		SUCTION STICKER	6588AG	----	1
126	HOSE CLAMP	26518-642	----	1		DISCHARGE STICKER	6588BJ	----	1
127	75" LG. HOSE	18513-056	----	1		DECAL KIT	48154-807	----	1
128	HOSE CLAMP	26518-642	----	1		WARNING DECAL	38816-023	----	2
129	MALE HOSE END	26525-020	----	1		INSTRUCTION DECAL	38818-144	----	1
130	HOSE CLAMP	26518-642	----	1		"PRIME AIRE" DECAL	38812-078	----	2
131	HOSE FITTING	26523-335	----	1		HEX HD CAPSCREW	B0602	15991	4
132	PIPE NIPPLE	T08	15079	1	OPTIONS:				
133	BALL VALVE	26631-023	----	1		12V BATTERY (DRY)	29331-517	----	1
134	10" LG. HOSE	18513-056	----	1		12V BATTERY (WET)	29331-527	----	1
135	HOSE CLAMP	26518-642	----	2		EPS/TRANSDUCER CTRL PANEL KIT			
136	MALE HOSE END	26525-020	----	2			48122-522	----	1
137	88" LG. HOSE	18513-054	----	1		GAUGE KIT	48213-112	----	1
138	HOSE CLAMP	26518-642	----	1		2-5/16" BALL TANDEM HIGHWAY			
139	AIR SILENCER/MUFFLER	W/ENGINE	----	1		TRAILER W/SURGE BRAKES			
140	PIPE COUPLING	AE08	15079	1		-JACK W/FOOT PAD	29313-011	----	1
141	VENTURI	26817-002	----	1		-JACK W/DOLLY WHEEL	29313-012	----	1
142	PIPE COUPLING	AE08	15079	1		3" I.D. LUNETTE EYE TANDEM			
143	STREET ELBOW	AGS08	11999	1		HIGHWAY TRAILER W/SURGE BRAKES			
144	BALL CHECK VALVE	26641-091	----	1		-JACK W/FOOT PAD	29313-013	----	1
145	HOSE BARB FITTING	26523-446	----	1		-JACK W/DOLLY WHEEL	29313-014	----	1
146	56" LG. HOSE	18513-113	----	1		2-5/16" BALL TANDEM HIGHWAY			
147	HOSE ASSY	46341-426	----	1		TRAILER W/ELECTRIC BRAKES			
148	MALE ADAPTOR	26351-065	----	2		-JACK W/FOOT PAD	29313-015	----	1
149	STREET ELBOW	RS08	11999	1		-JACK W/DOLLY WHEEL	29313-016	----	1
150	1/2" TEE	U08	11999	1		3" I.D. LUNETTE EYE TANDEM			
151	AIR SILENCER/MUFFLER	26662-901	----	1		HIGHWAY TRAILER W/ELECTRIC BRAKES			
152	PRESS RELIEF VALVE	26662-028	----	1		-JACK W/FOOT PAD	29313-017	----	1
153	41881-706	----	24150	1		-JACK W/DOLLY WHEEL	29313-018	----	1
154	HEX HD CAPSCREW	B0805	15991	1		TWO FLOAT SWITCH KIT	48312-981	----	1
155	LOCK WASHER	J08	15991	1		FUEL FILTER KIT	48122-914	----	1

**THE GORMAN-RUPP COMPANY • MANSFIELD, OHIO**

GORMAN-RUPP OF CANADA LIMITED • ST. THOMAS, ONTARIO, CANADA

Printed in U.S.A.

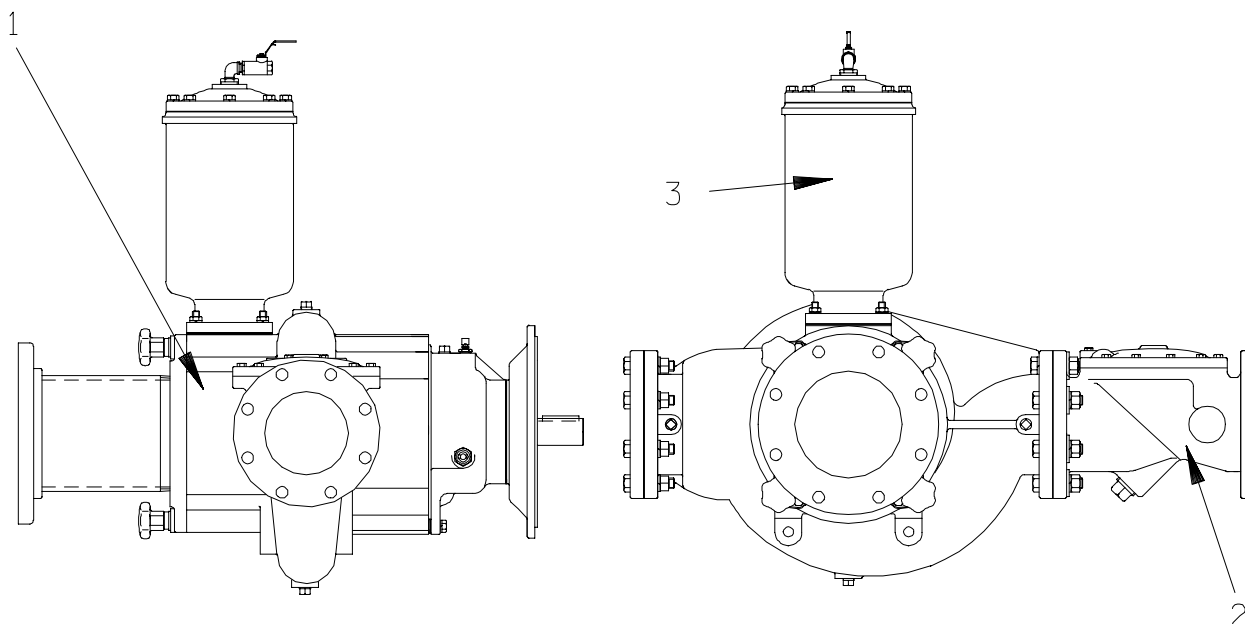

### PARTS LIST

#### PA6C60-(4045T) Pump End Assembly

ITEM NO.	PART NAME	PART NUMBER	MAT'L CODE	QTY
1	PUMP END ASSY	66F60-(4045T)	---	1
2	CHECK VALVE KIT	48274-015	---	1
	-CHECK VALVE	26642-126	---	1
	* -FLAPPER	26688-001	---	1
	* -COVER O-RING	25152-377	---	1
	* -FLANGE GASKET	25113-036	---	1
3	PRIMING CHAMBER KIT	48275-005	---	1

#### NOT SHOWN

STRAINER	46641-010	24150	1
SUCTION STICKER	6588AG	---	1
DISCHARGE STICKER	6588BJ	---	1
WARNING DECAL	2613FE	---	1
G-R DECAL	GR-06	---	1
LUBE DECAL	11421A	---	1
OIL LEVEL DECAL	38816-123	---	1
ROTATION DECAL	2613M	---	1

\* INDICATES PARTS RECOMMENDED FOR STOCK

**THE GORMAN-RUPP COMPANY • MANSFIELD, OHIO**

December 21, 2004

GORMAN-RUPP OF CANADA LIMITED • ST. THOMAS, ONTARIO, CANADA

Printed in U.S.A.

© Copyright by the Gorman-Rupp Company

5 of 12  
Page 64.6 C18

# PA6C60-4045T-ESP

ACDEU

S/N 1302082N Up  
PUMP ISSUE 1

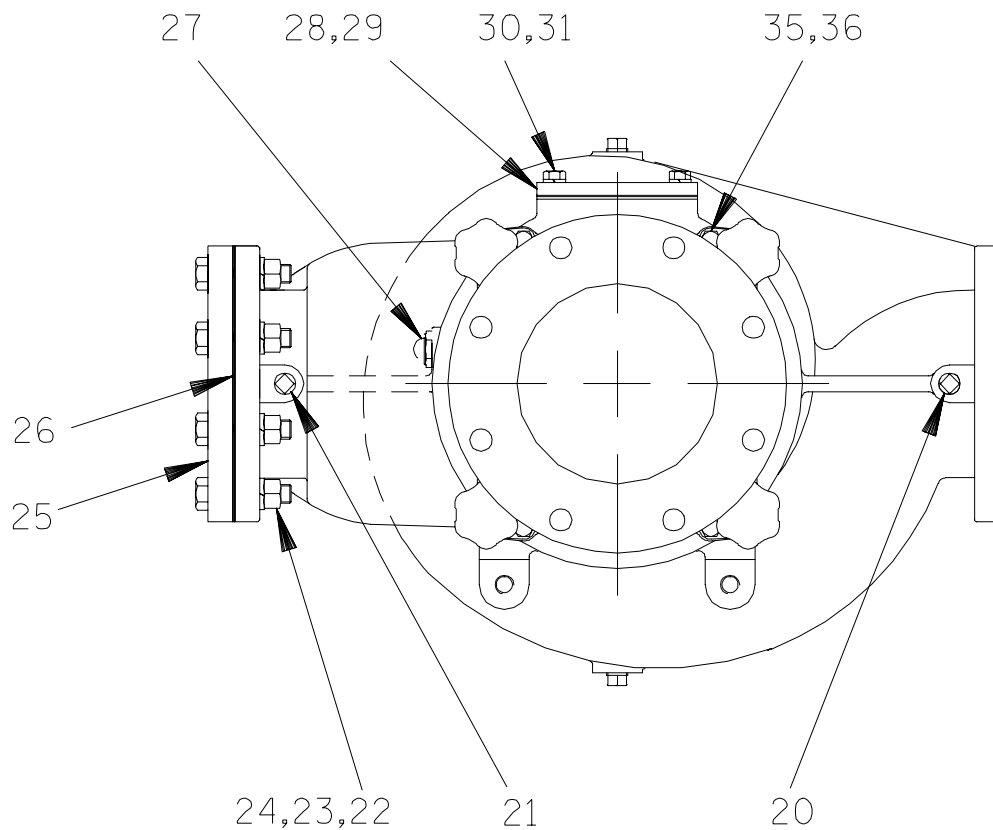
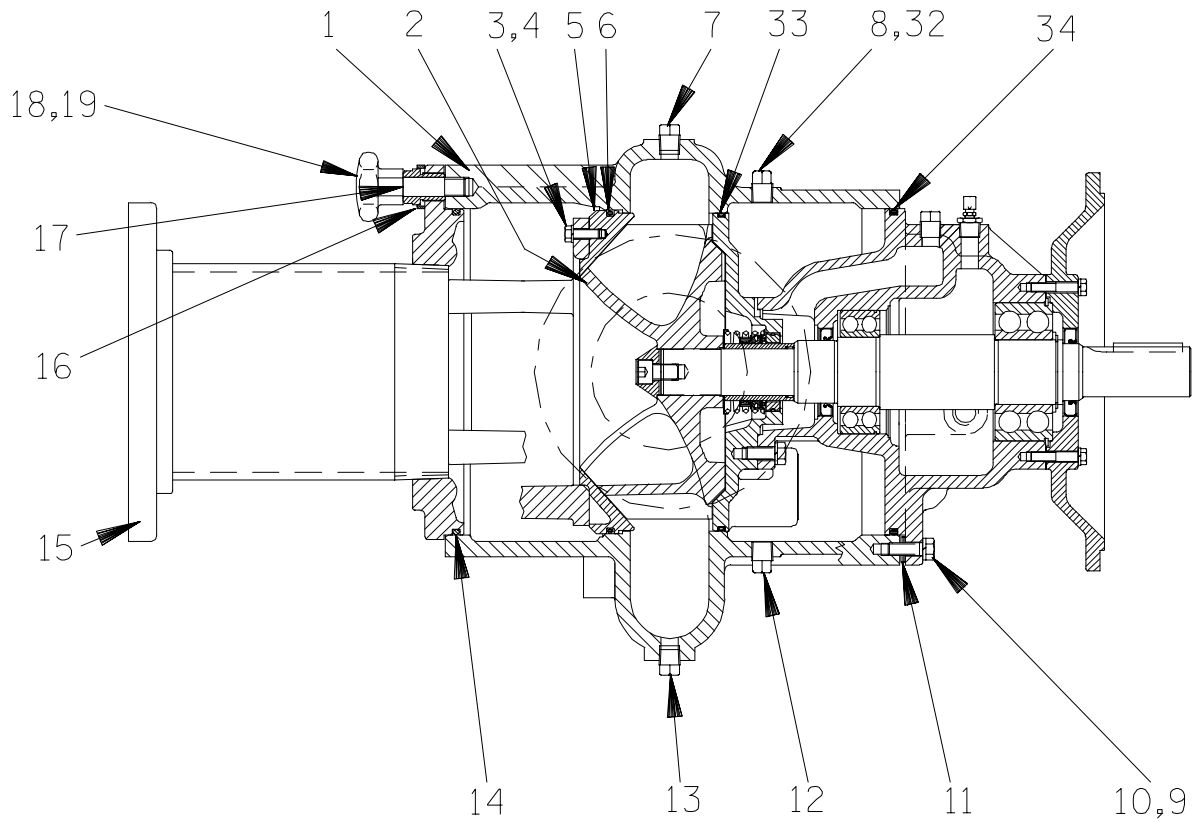

**THE GORMAN-RUPP COMPANY • MANSFIELD, OHIO**

GORMAN-RUPP OF CANADA LIMITED • ST. THOMAS, ONTARIO, CANADA

Printed in U.S.A.

**PARTS LIST**  
**66F60-(4045T) Pump End Assembly**

ITEM NO.	PART NAME	PART NUMBER	MAT'L CODE	QTY
1	VOLUTE	38218-303	11010	1
2	REPAIR ROTATING ASSY	44163-431	---	1
3	HEX HD CAP SCREW	B0604-1/2	17000	4
4	LOCK WASHER	J06	17090	4
5	WEAR PLATE	38691-864	11010	1
6	* O-RING	25152-453	---	1
7	PIPE PLUG	P08	15079	1
8	VENTED PLUG	4823A	15079	1
9	HEX HD CAP SCREW	B0806	15991	4
10	LOCK WASHER	J08	15991	4
11	ADJUSTING SHIM	13131-3	17040	12
12	PIPE PLUG	P08	15079	1
13	PIPE PLUG	P08	15079	1
14	* O-RING	S1676	---	1
15	BACK COVER PLATE ASSY	42111-812	11010	1
16	LOCKING COLLAR	38115-551	15001	4
17	ADJUSTING SCREWS	31871-070	1500X	4
18	STUD	C1213	15991	4
19	HAND KNOB	38115-901	10000	4
20	PIPE PLUG	P08	15079	1
21	PIPE PLUG	P08	15079	1
22	HEX HD CAP SCREW	B1213	15991	8
23	LOCK WASHER	J12	15991	8
24	HEX NUT	D12	15991	8
25	BLIND FLANGE ASSY	42111-349	---	1
26	* GASKET	25113-036	---	1
27	SIGHT GAUGE	S1471	---	1
28	COVERPLATE	33541-045	15080	1
29	* GASKET	38687-053	19060	1
30	HEX HEAD CAP SCREW	B0805	15991	4
31	LOCK WASHER	J08	15991	4
32	SHIP PLUG	11495B	15079	1
33	* O-RING	25152-381	---	1
34	* O-RING	S1676	---	1
35	HEX HD CAP SCREW	B0804-1/2	15991	4
36	LOCK WASHER	J08	15991	4

## NOT SHOWN:

DRIVE ASSY	44162-159	---	1
PIPE PLUG	P12	15079	1
OIL LEVEL DECAL	38816-123	---	1
NAME PLATE	38818-127	13000	1
DRIVE SCREW	BM#04-03	17000	4

\* INDICATES PARTS RECOMMENDED FOR STOCK

**THE GORMAN-RUPP COMPANY • MANSFIELD, OHIO**

December 21, 2004

GORMAN-RUPP OF CANADA LIMITED • ST. THOMAS, ONTARIO, CANADA

Printed in U.S.A.

© Copyright by the Gorman-Rupp Company

7 of 12  
Page 64.6 C18

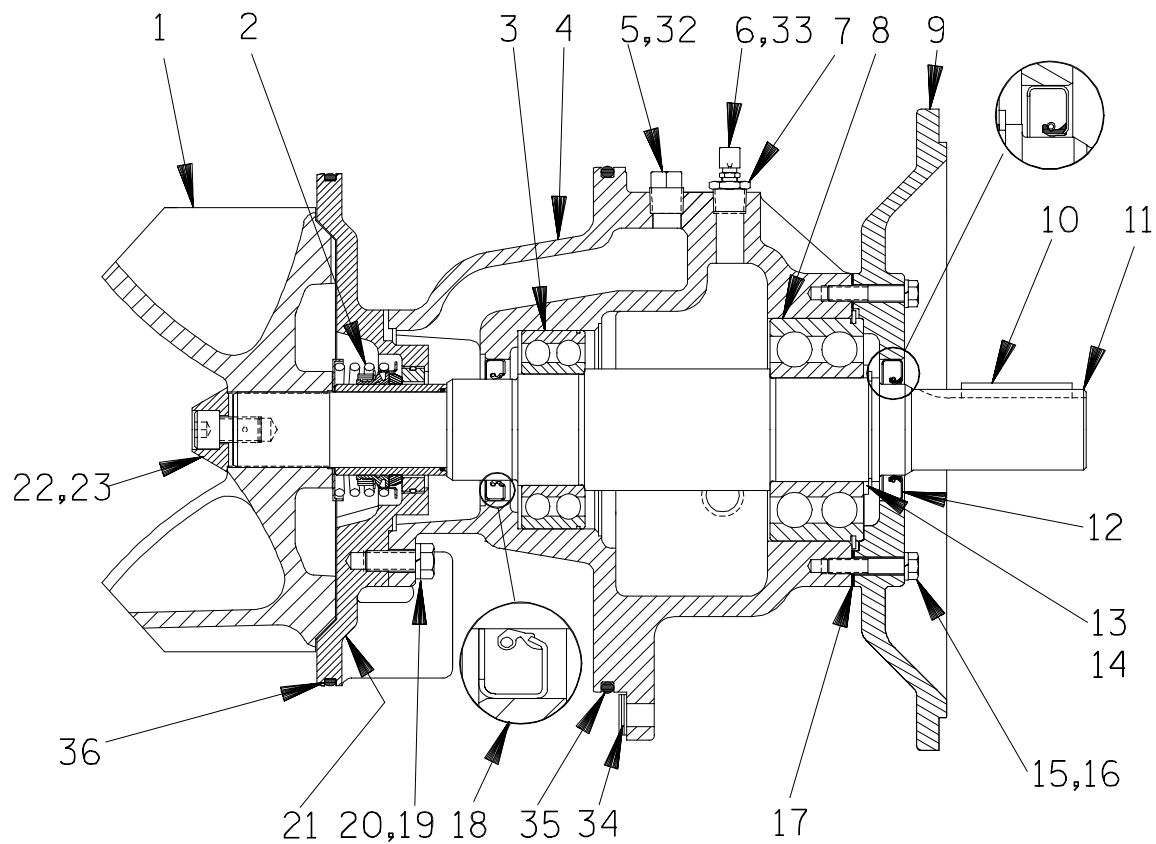
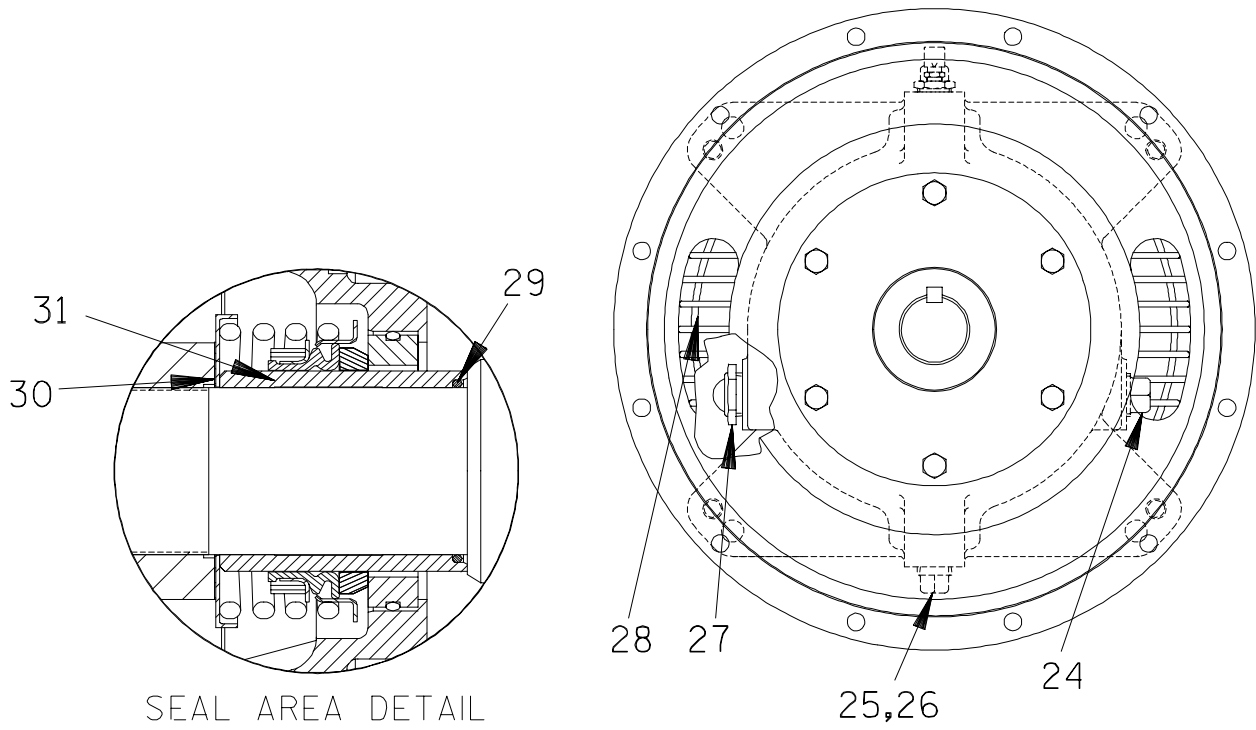

**THE GORMAN-RUPP COMPANY • MANSFIELD, OHIO**

GORMAN-RUPP OF CANADA LIMITED • ST. THOMAS, ONTARIO, CANADA

Printed in U.S.A.

**PARTS LIST**  
**44163-431 Repair Rotating Assembly**

ITEM NO.	PART NAME	PART NUMBER	MAT'L CODE	QTY
1	* IMPELLER	38615-095	11010	1
2	* SEAL ASSY	46512-149	---	1
3	* INBOARD BALL BEARING	23422-019	---	1
4	BEARING HOUSING	38251-513	10000	1
5	VENTED PLUG	4823A	15079	1
6	AIR VENT	S1530	---	1
7	RED PIPE BUSHING	AP0802	15079	1
8	* OUTBOARD BALL BRG	23422-414	---	1
9	DRIVE FLANGE	38545-004	10000	1
10	* IMP SHAFT KEY	24133-603	---	REF
11	IMPELLER SHAFT	38515-592	1706H	1
12	* OIL SEAL	S1907	---	1
13	SNAP RING	S720	---	1
14	THRUST WASHER	31134-115	15000	1
15	HEX HD CAPSCREW	B0608	15991	6
16	LOCKWASHER	J06	15991	6
17	* BRG HOUSING GSKT	38683-474	18000	1
18	* OIL SEAL	25227-771	---	1
19	HEX HD CAPSCREW	B0805-1/2	15991	4
20	LOCKWASHER	J08	15991	4
21	SEAL PLATE	38272-256	10000	1
22	SOCKET HD CAPSCREW	DM1004S	17090	1
23	IMPELLER WASHER	31514-015	17000	1
24	PIPE PLUG	P12	15079	1
25	PIPE PLUG	P08	15079	1
26	BRG CVTY DRAIN PLUG	P08	15079	1
27	SIGHT GAUGE	S1471	---	1
28	INTERMEDIATE GUARD	42381-509	24152	2
29	* SHAFT SLEEVE O-RING	25154-131	---	REF
30	* IMPELLER ADJ SHIM SET	48261-057	---	REF
31	* SHAFT SLEEVE	31163-019	1706H	1
32	SHIP PLUG	11495B	15079	1
33	SHIP PLUG	11495B	15079	1
34	BEARING ADJ SHIM SET	13131-3	17040	12
35	* BRG HOUSING O-RING	S1676	---	1
36	* SEAL PLATE O-RING	25152-381	---	1
NOT SHOWN:				
	INSTRUCTION TAG	6588U	---	1

\* INDICATES PARTS RECOMMENDED FOR STOCK

**THE GORMAN-RUPP COMPANY • MANSFIELD, OHIO**

December 21, 2004

GORMAN-RUPP OF CANADA LIMITED • ST. THOMAS, ONTARIO, CANADA

Printed in U.S.A.

© Copyright by the Gorman-Rupp Company

9 of 12  
Page 64.6 C18

S/N 1302082N Up  
PUMP ISSUE 1

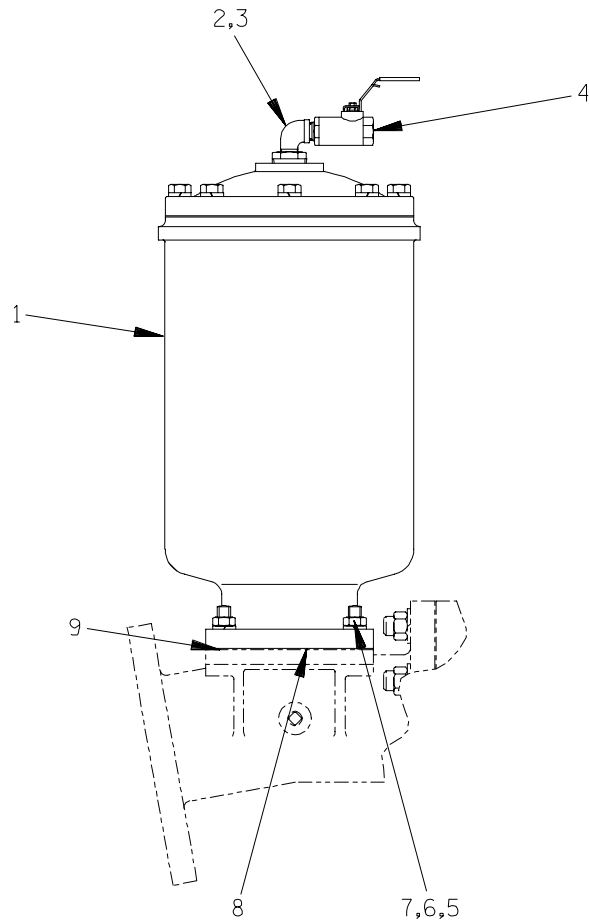

**PARTS LIST**  
**48275-005 Priming Chamber Kit**

ITEM NO.	PART NAME	PART NUMBER	MAT'L CODE	QTY
1	PRIMING CHAMBER ASSY	46112-709	---	1
2	PIPE BUSHING	AP1608	11999	1
3	STREET ELBOW	RS08	11999	1
4	BALL VALVE	26631-052	---	1
5	STUD	C0809	15991	4
6	HEX NUT	D08	15991	4
7	LOCK WASHER	J08	15991	4
8	* GASKET	38687-053	19060	1
9	BAFFLE	31113-011	17000	1

\* INDICATES PARTS RECOMMENDED FOR STOCK

**THE GORMAN-RUPP COMPANY • MANSFIELD, OHIO**

GORMAN-RUPP OF CANADA LIMITED • ST. THOMAS, ONTARIO, CANADA

Printed in U.S.A.

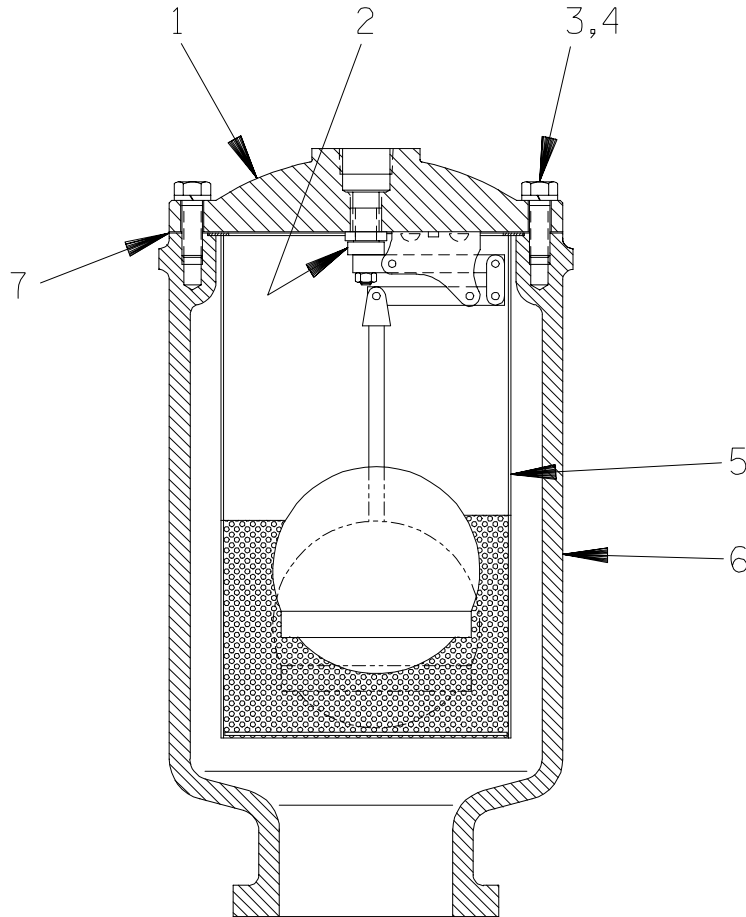

**PARTS LIST**  
**46112-709 Priming Chamber Assembly**

ITEM NO.	PART NAME	PART NUMBER	MAT'L CODE	QTY
1	PRIMING VALVE	26664-007	---	1
2	-ORIFICE BUTTON	26688-021	---	1
3	HEX HD CAPSCREW	B0806	15991	8
4	LOCKWASHER	J08	15991	8
5	STRAINER ASSY	46641-222	17000	1
6	PRIMING CHAMBER	38343-020	10000	1
7	* PRIMING VALVE GASKET	38683-657	19060	1

\* INDICATES PARTS RECOMMENDED FOR STOCK

**THE GORMAN-RUPP COMPANY • MANSFIELD, OHIO**

GORMAN-RUPP OF CANADA LIMITED • ST. THOMAS, ONTARIO, CANADA

Printed in U.S.A.



S/N 1302082N Up  
PUMP ISSUE 1

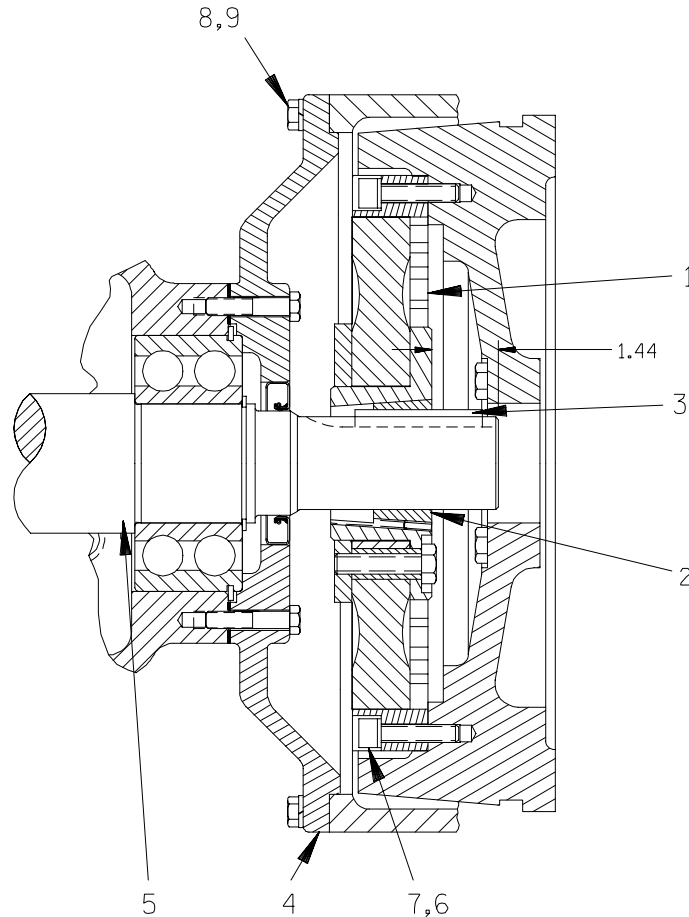

**PARTS LIST**  
**44162-159 Drive Assembly**

ITEM NO.	PART NAME	PART NUMBER	MAT'L CODE	QTY
1	COUPLING ASSY	44165-016	---	1
2	BUSHING	24131-498	---	1
3	* -KEY	24133-603	---	1
4	DRIVE FLANGE	38545-004	10000	1
5	IMPELLER SHAFT	38515-586	1706H	REF
6	LOCKWASHER	21171-536	---	8
7	SOCKET HD CAPSCREW	BD0606 1/2	15991	8
8	HEX HD CAPSCREW	B0605	15991	12
9	LOCKWASHER	J06	15991	12

\* INDICATES PARTS RECOMMENDED FOR STOCK

**THE GORMAN-RUPP COMPANY • MANSFIELD, OHIO**

GORMAN-RUPP OF CANADA LIMITED • ST. THOMAS, ONTARIO, CANADA

Printed in U.S.A.

**For U.S. and International Warranty Information,  
Please Visit [www.grpumps.com/warranty](http://www.grpumps.com/warranty)  
or call:  
U.S.: 419-755-1280  
International: +1-419-755-1352**

**For Canadian Warranty Information,  
Please Visit [www.grcanada.com/warranty](http://www.grcanada.com/warranty)  
or call:  
519-631-2870**