

ACEGU

Use With: OM--04760  
MR--04885

PUBLICATION NUMBER PL-05122-01  
June 22, 2000



**PUMP MODELS**  
**12D-L48EE**  
**12D-L48EE S/G**

**MANUAL**  
**PART 2 of 3**

**PARTS**  
**LIST**  
**WITH**  
**PERFORMANCE CURVE**

**THE GORMAN-RUPP COMPANY • MANSFIELD, OHIO**

GORMAN-RUPP OF CANADA LIMITED • ST. THOMAS, ONTARIO, CANADA Printed in U.S.A.

©Copyright by the Gorman-Rupp Company



The engine exhaust from this product contains chemicals known to the State of California to cause cancer, birth defects or other reproductive harm.

## PERFORMANCE CURVE – SECTION A

### RECORDING MODEL AND SERIAL NUMBERS

Please record the pump model and serial number in the spaces provided below and in the separate Installation/Operation Manual accompanying your pump. Your Gorman-Rupp distributor needs this information when you require parts or service.

Pump Model: \_\_\_\_\_

Serial Number: \_\_\_\_\_

### WARRANTY INFORMATION

The pump warranty is provided as part of Gorman-Rupp's support program for customers who operate and maintain their equipment as described in this manual and other accompanying literature. Please note that should the equipment be abused or modified to change its performance beyond the original factory specifications, the warranty will become void and any claim will be denied.

### PERFORMANCE CURVES

The performance curves on the following page are based on 70° F (21° C) clear water at sea level. Since pump installations are seldom identical, your performance may be different due to such factors as viscosity, specific gravity, elevation, temperature, and impeller trim.

If your pump serial number is followed by an "N", your pump is **NOT** a standard production model. Contact the Gorman-Rupp Company to verify performance or part numbers.



Pump speed and operating condition points must be within the continuous performance range shown on the curve(s).

**This Page Intentionally Blank**

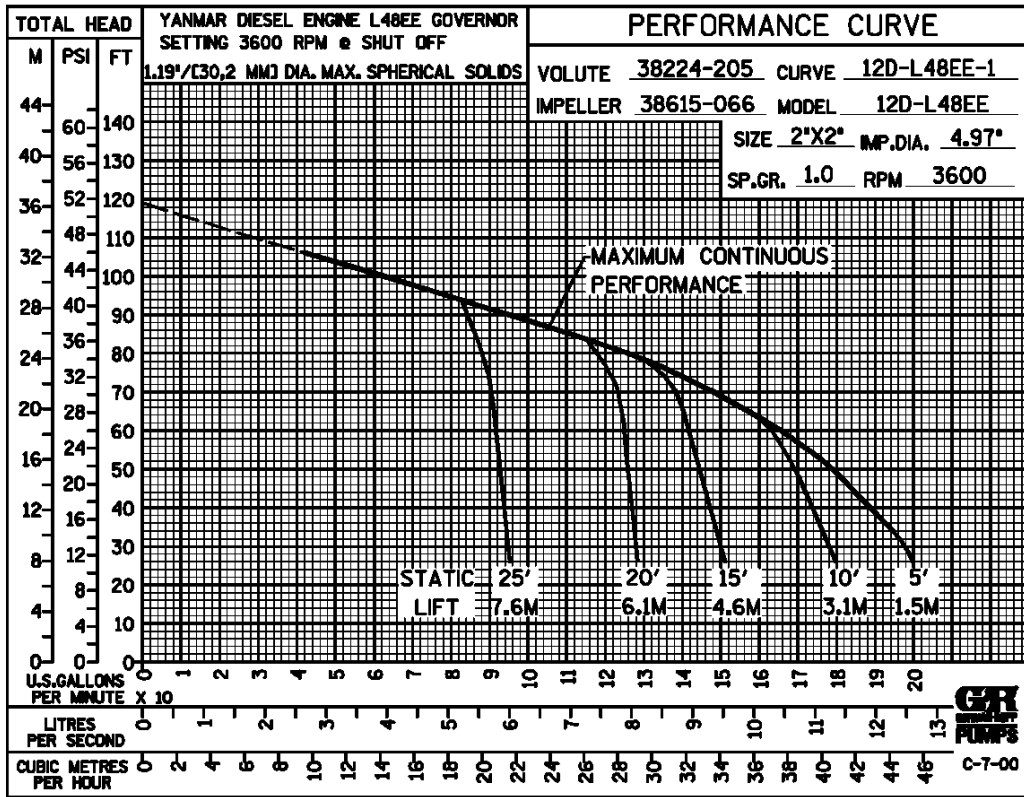

Performance Curve – Model 12D-L48EE

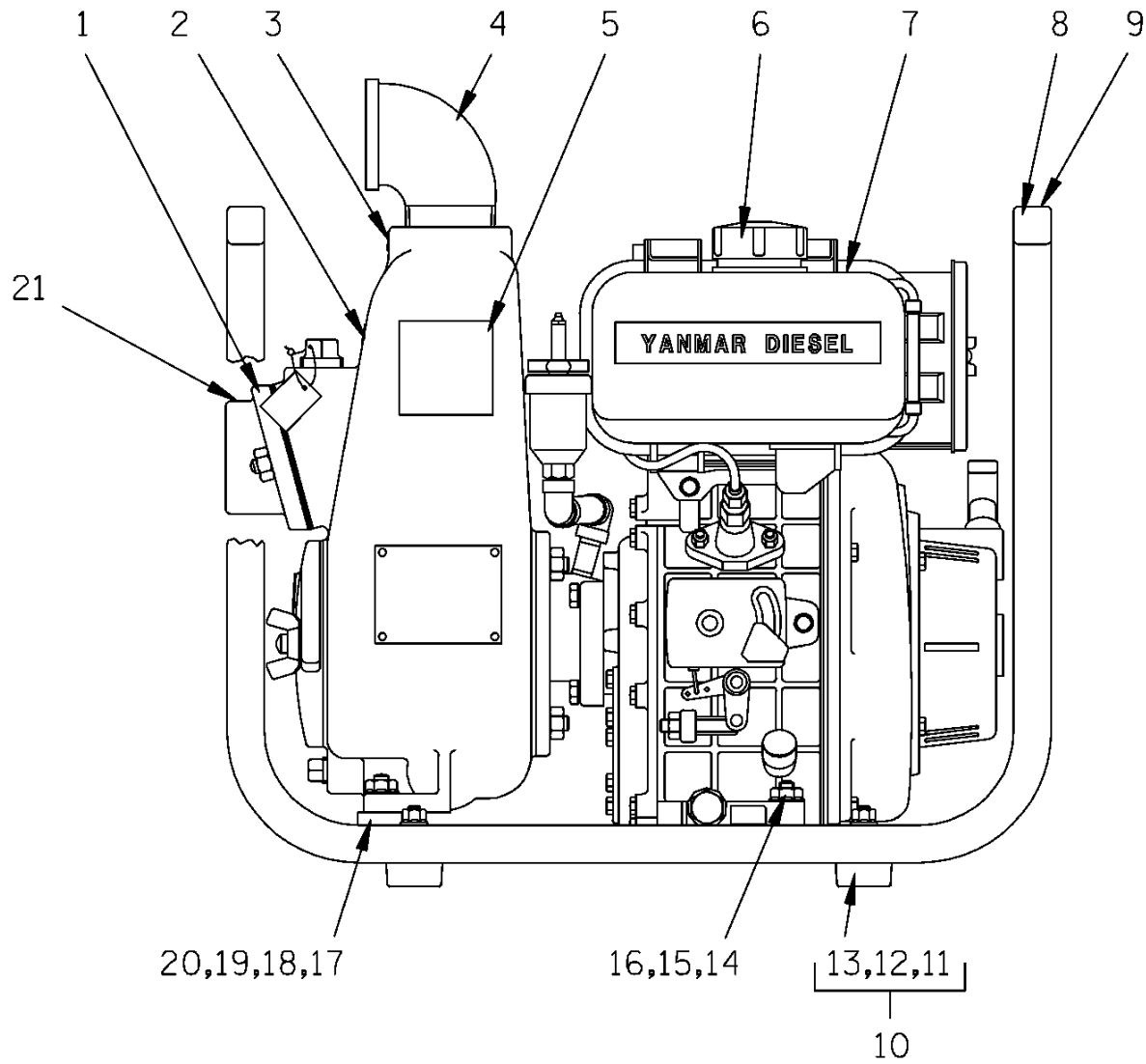

**THE GORMAN-RUPP COMPANY • MANSFIELD, OHIO**

GORMAN-RUPP OF CANADA LIMITED • ST. THOMAS, ONTARIO, CANADA

Printed in U.S.A.

1 of 6

June 22, 2000

©Copyright by the Gorman-Rupp Company

Page 10.2 D1.93

# 12D-L48EE

ACEGU

## S/N 1212969 Up PUMP ISSUE 1

If your pump serial number is followed by an "N", your pump is **NOT** a standard production model. Contact the Gorman-Rupp Company to verify part numbers.

ITEM NO.	PART NAME	PART NUMBER	MAT'L CODE	QTY	ITEM NO.	PART NAME	PART NUMBER	MAT'L CODE	QTY
1	PUMP END ASSY	12D-(L48EE) PPO		1	13	-HEX HD CAPSCREW	B0506	15991	4
2	PRIMING STICKER	6588AH	---	1	14	FLAT WASHER	KE06	15991	2
3	DISCHARGE STICKER	6588BJ	---	1	15	FLANGED HEX NUT	21765-314	---	2
4 †	STREET ELBOW	RS32	11999	1	16	HEX HD CAPSCREW	B0606	15991	2
5	GREASE CUP INSTRUCT	6588BD	---	1	17	SPACER	31141-029	13000	2
6	YANMAR L48EE ENGINE	29239-041	---	1	18	FLAT WASHER	KE06	15991	2
7	WARNING DECAL	2613FE	---	1	19	HEX HD CAPSCREW	B0607	15991	2
8	ROLLOVER BASE	41583-316	24150	1	20	FLANGED HEX NUT	21765-314	---	2
9	HAND CARRY DECAL	2613FT	---	2	21	SUCTION STICKER	6588AG	---	1
10 †	RUBBER FOOT MTG KIT	48152-607	---	1					
11	-MOUNTING FOOT	24631-401	---	4					
12	-FLANGED HEX NUT	21765-312	---	4					
						OPTIONAL:			
						WHEEL KIT	GRP30-52	---	1

\* INDICATES PARTS RECOMMENDED FOR STOCK

† ITEMS SHIPPED LOOSE WITH PUMP

## THE GORMAN-RUPP COMPANY • MANSFIELD, OHIO

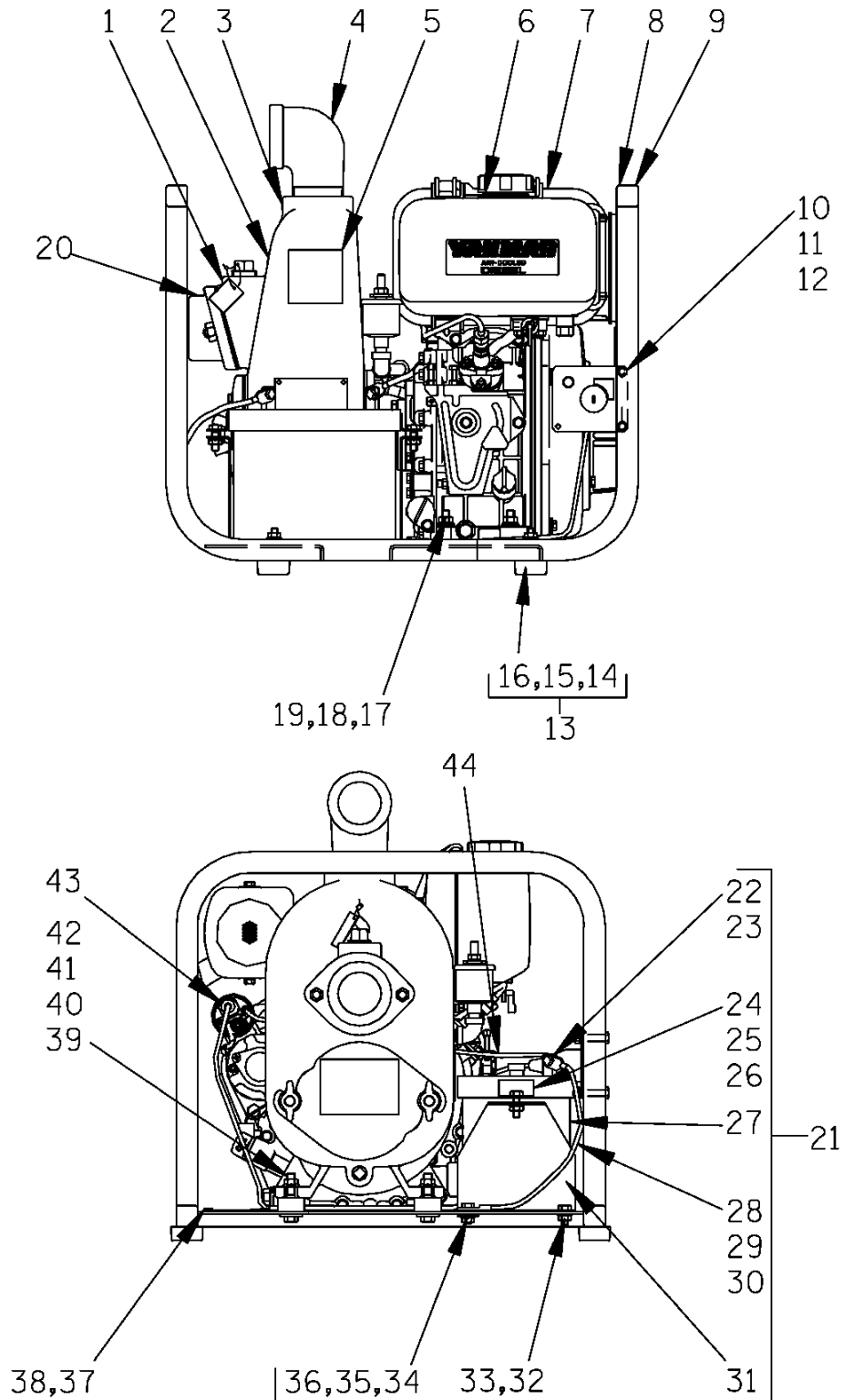

**THE GORMAN-RUPP COMPANY • MANSFIELD, OHIO**

GORMAN-RUPP OF CANADA LIMITED • ST. THOMAS, ONTARIO, CANADA

Printed in U.S.A.

3 of 6



# 12D-L48EE S/G

ACEGU

S/N 1212969 Up  
PUMP ISSUE 1

If your pump serial number is followed by an "N", your pump is **NOT** a standard production model. Contact the Gorman-Rupp Company to verify part numbers.

ITEM NO.	PART NAME	PART NUMBER	MAT'L CODE	QTY	ITEM NO.	PART NAME	PART NUMBER	MAT'L CODE	QTY
1	PUMP END ASSY	12D-(L48EE S/G)		1	27	-BATTERY	SEE OPTIONS		1
2	PRIMING STICKER	6588AH	----	1	28	-12" GROUND CABLE	47311-542	----	1
3	DISCHARGE STICKER	6588BJ	----	1	29	-HEX HD CAPSCREW	B0503	15991	1
4 †	STREET ELBOW	RS32	11999	1	30	-FLANGED HEX NUT	21765-312	----	1
5	GREASE CUP INSTR	6588BD	----	1	31	-BATTERY BOX	11281	24000	1
6	YANMAR ENGINE	29239-042	----	1	32	-HEX HD CAPSCREW	B0503	15991	3
7	WARNING DECAL	2613FE	----	1	33	-FLANGED HEX NUT	21765-312	----	3
8	ROLLOVER BASE	41583-332	24150	1	34	-HEX HD CAPSCREW	B0503	15991	1
9	HAND CARRY DECAL	2613FT	----	1	35	-FLANGED HEX NUT	21765-312	----	1
10	FLANGED HEX NUT	B0604	15991	2	36	-T TYPE LK WASHER	BL05	15991	1
11	LOCKWASHER	J04	15991	2	37	TAPSCREW	21281-444	----	1
12	HEX NUT	D04	15991	2	38	T TYPE LOCKWASHER	AL#10	15991	1
13	RUB FOOT MTG KIT	48152-607	----	1	39	SPACER	31141-029	13000	2
14	-MTG FOOT	24631-401	----	4	40	FLAT WASHER	KE06	15991	2
15	-FLANGED HEX NUT	21765-312	----	4	41	HEX HD CAPSCREW	B0608	15991	2
16	-HEX HD CAPSCREW	B0506	15991	4	42	HEX NUT	21765-314	15991	2
17	FLAT WASHER	KE06	15991	4	43	LOCKWASHER	K04	15991	1
18	FLANGED HEX NUT	21765-314	----	4	44	POS BATTERY CABLE	47311-504	----	1
19	HEX HD CAPSCREW	B0607	15991	4		NOT SHOWN:			
20	SUCTION STICKER	6588AC	----	1		BATTERY TAG	38818-680	----	1
21	BATTERY BOX ASSY	GRP40-05	----	1		† WHEEL KIT	GRP30-52	----	1
22	-HEX HD CAPSCREW	B0503	15991	1		OPTIONAL:			
23	-FLANGED HEX NUT	21765-312	----	1		BATTERY	S1680	----	1
24	-BATTERY BOX COVER	11870	24000	1					
25	-HEX HD CAPSCREW	B0504	15991	2					
26	-FLANGED HEX NUT	21765-312	----	2					

\* INDICATES PARTS RECOMMENDED FOR STOCK

† ITEMS SHIPPED LOOSE WITH PUMP

## THE GORMAN-RUPP COMPANY • MANSFIELD, OHIO

12D-(L48EE S/G) PPO  
12D-(L48EE) PPO

S/N 1212969 Up  
PUMP ISSUE 1

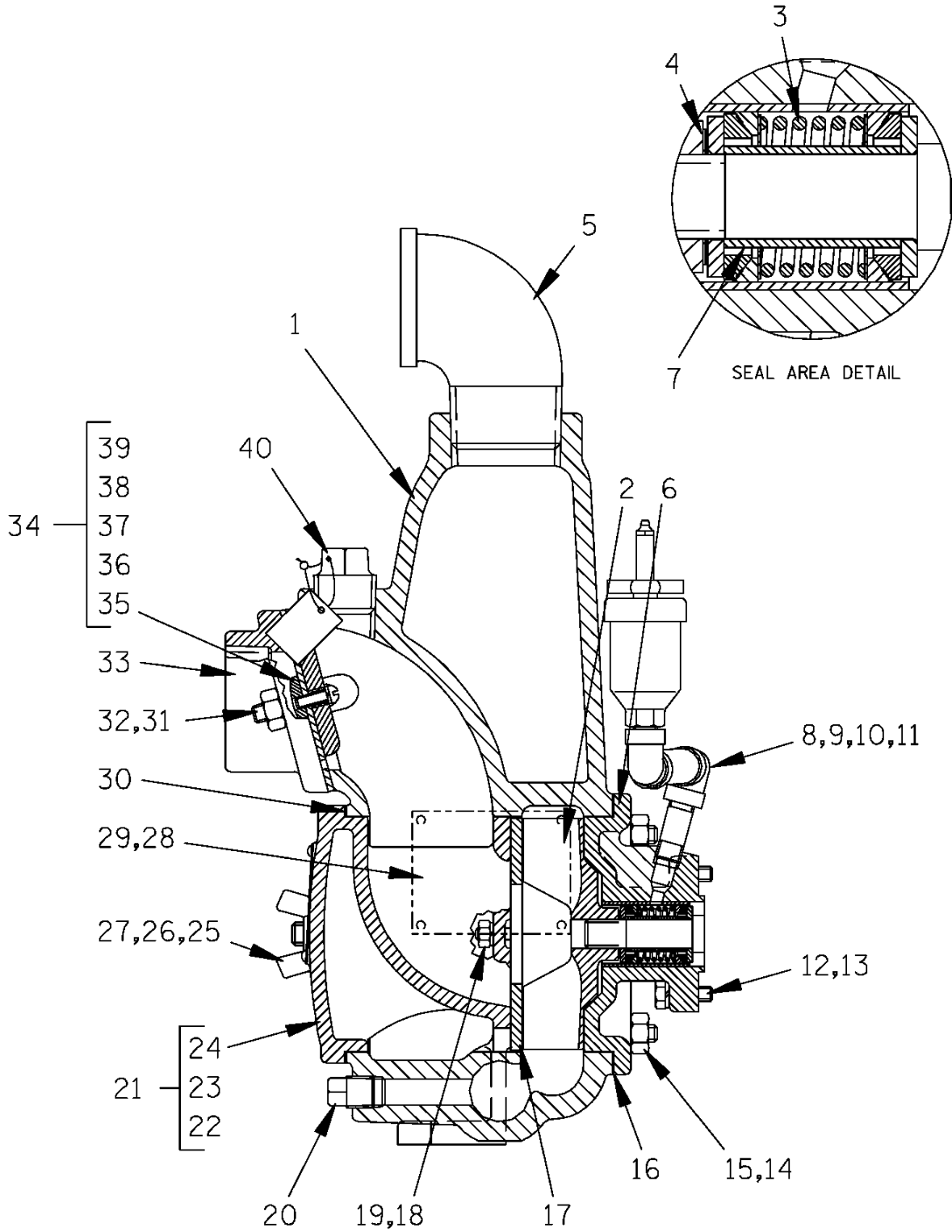

**THE GORMAN-RUPP COMPANY • MANSFIELD, OHIO**

GORMAN-RUPP OF CANADA LIMITED • ST. THOMAS, ONTARIO, CANADA

Printed in U.S.A.

5 of 6

**12D-(L48EE) PPO**  
**12D-(L48EE S/G) PPO**

ACEGU

S/N 1212969 Up  
PUMP ISSUE 1

ITEM NO.	PART NAME	PART NUMBER	MAT'L CODE	QTY	ITEM NO.	PART NAME	PART NUMBER	MAT'L CODE	QTY
1	PUMP CASING	38224-205	13040	1	22	- WARNING PLATE	2613EV	13990	1
2 *	IMPELLER	38615-066	11060	1	23	- BACK COVER PLATE	NOT AVAILABLE		1
3 *	GREASE SEAL ASSY	GS625	---	1	24	- DRIVE SCREW	BM#04-03	17000	4
4 *	IMP ADJ SHIM SET	513A	17090	REF	25	STUD	C0808	15991	2
5	STREET ELBOW	RS32	11999	1	26	FLAT WASHER	KE08	15991	2
6	INTERMEDIATE ASSY	2935	10010	1	27	WING NUT	BB08	15991	2
7 *	SEAL LINER	1904	14080	REF	28	NAME PLATE	38818-021	13990	1
8	PIPE NIPPLE	T0406	15079	1	29	DRIVE SCREW	BM#04-03	17000	4
9	PIPE NIPPLE				30 *	BACK CVR GSKT	12369G	20000	1
	-12D-(L48EE) PPO	T0418	15079	1	31	STUD	C0606	15991	2
	-12D-(L48EE S/G) PPO	T0420	15079	1	32	HEX NUT	D06	15991	2
10	PIPE ELBOW	R04	11999	2	33	SUCTION FLANGE	38645-024	13040	1
11	GREASE CUP	S36	---	1	34	CHECK VALVE ASSY	46413-028	---	1
12	HEX HD CAPSCREW	22645-130	---	4	35	-SMALL VALVE WEIGHT	19B	10010	1
13	LOCKWASHER	21171-510	---	4	36	-LRG VALVE WEIGHT	1354	15160	1
14	STUD	C0605 1/2	15991	4	37	-LOCKWASHER	J04	17090	1
15	HEX NUT	D06	15991	4	38	-RD HD MACH SCREW	X0403	17090	1
16 *	CASING GASKET SET	504G	18000	1	39 *	-CHECK VALVE GSKT	38671-630	19070	1
17 *	WEAR PLATE ASSY	46451-018	24150	1	40	FILL PLUG ASSY	48271-063	---	1
18	LOCKWASHER	J04	15991	2		NOT SHOWN:			
19	HEX NUT	D04	15991	2		STRAINER	9026D	24001	1
20	CASING DRAIN PLUG	P06	15079	1		SUCTION STICKER	6588AG	---	1
21	BACK CVR ASSY	42111-919	---	1		DISCHARGE STICKER	6588BJ	---	1

\* INDICATES PARTS RECOMMENDED FOR STOCK

**THE GORMAN-RUPP COMPANY • MANSFIELD, OHIO**



**For U.S. and International Warranty Information,  
Please Visit [www.grpumps.com/warranty](http://www.grpumps.com/warranty)**

**or call:**

**U.S.: 419-755-1280**

**International: +1-419-755-1352**

**For Canadian Warranty Information,  
Please Visit [www.grcanada.com/warranty](http://www.grcanada.com/warranty)**

**or call:**

**519-631-2870**

**THE GORMAN-RUPP COMPANY • MANSFIELD, OHIO**

**GORMAN-RUPP OF CANADA LIMITED • ST. THOMAS, ONTARIO, CANADA**