

ACDE

Use With: OM-04760
MR-04885

PUBLICATION NUMBER PL-04951-01
DECEMBER 29, 1998
REV. A 12/29/98
Supersedes: OM-03622-01



PUMP MODEL
13C2-M20 S/G

MANUAL
PART 2 of 3

PARTS
LIST
WITH
PERFORMANCE CURVE

THE GORMAN-RUPP COMPANY • MANSFIELD, OHIO

GORMAN-RUPP OF CANADA LIMITED • ST. THOMAS, ONTARIO, CANADA Printed in U.S.A.

©Copyright by the Gorman-Rupp Company



The engine exhaust from this product contains chemicals known to the State of California to cause cancer, birth defects or other reproductive harm.

PERFORMANCE CURVE – SECTION A

RECORDING MODEL AND SERIAL NUMBERS

Please record the pump model and serial number in the spaces provided below and in the separate Installation/Operation Manual accompanying your pump. Your Gorman-Rupp distributor needs this information when you require parts or service.

Pump Model: _____

Serial Number: _____

WARRANTY INFORMATION

The pump warranty is provided as part of Gorman-Rupp's support program for customers who operate and maintain their equipment as described in this manual and other accompanying literature. Please note that should the equipment be abused or modified to change its performance beyond the original factory specifications, the warranty will become void and any claim will be denied.

PERFORMANCE CURVES

The performance curves on the following page are based on 70° F (21° C) clear water at sea level. Since pump installations are seldom identical, your performance may be different due to such factors as viscosity, specific gravity, elevation, temperature, and impeller trim.

If your pump serial number is followed by an "N", your pump is **NOT** a standard production model. Contact the Gorman-Rupp Company to verify performance or part numbers.



Pump speed and operating condition points must be within the continuous performance range shown on the curve(s).

This Page Intentionally Blank

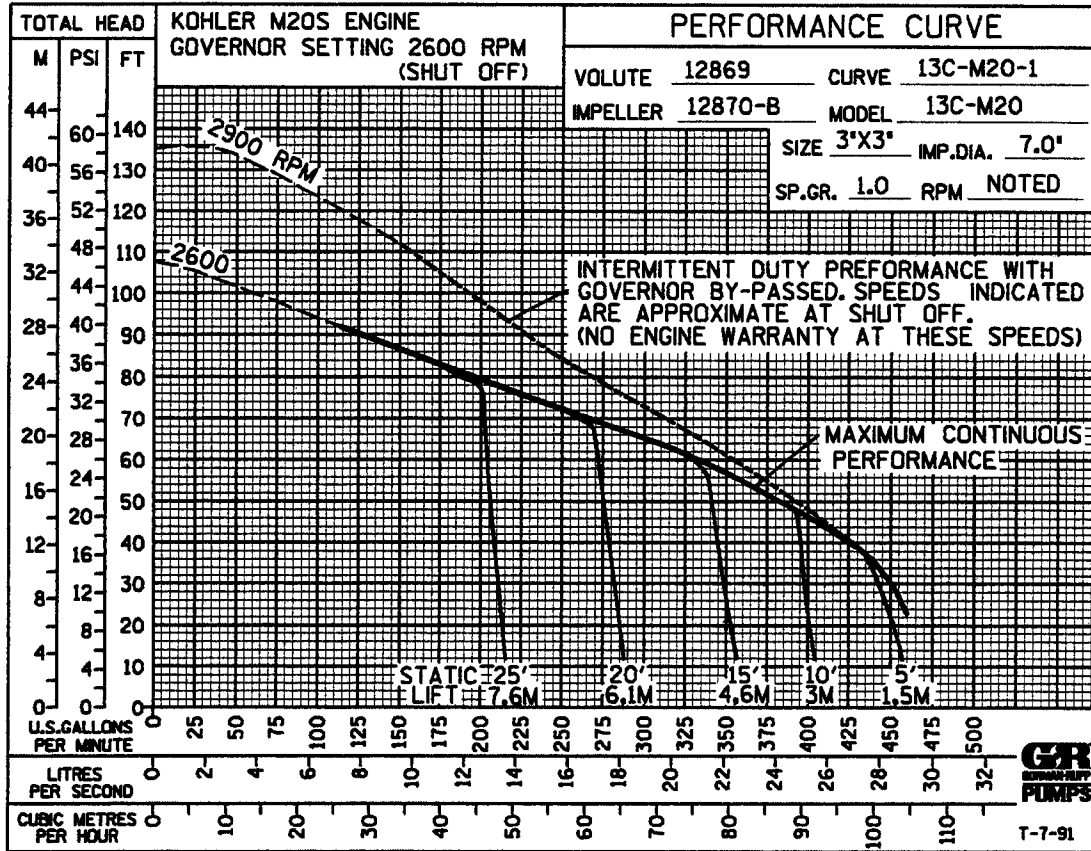

Performance Curve – Model 13C2-M20 S/G

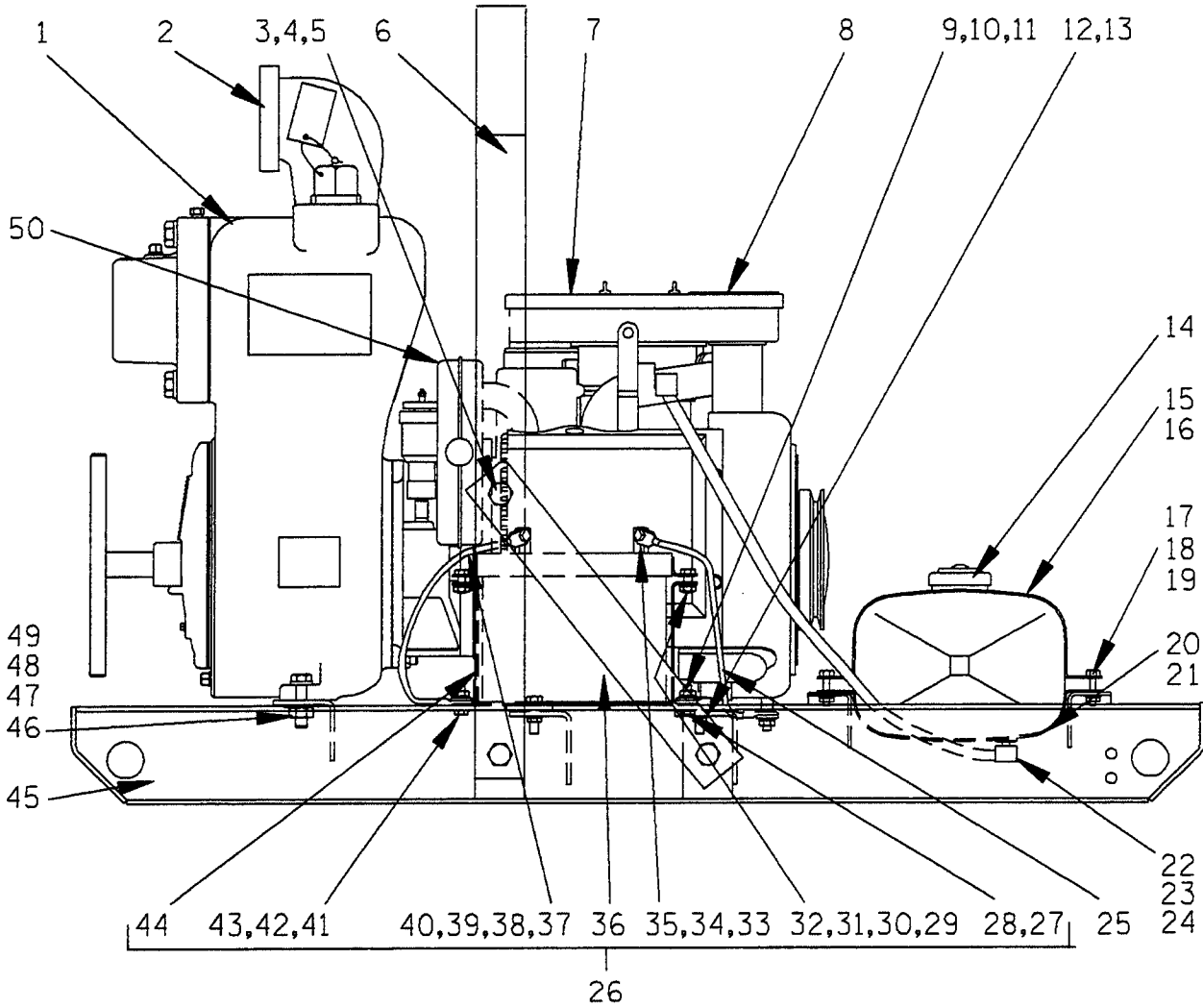

THE GORMAN-RUPP COMPANY • MANSFIELD, OHIO

GORMAN-RUPP OF CANADA LIMITED • ST. THOMAS, ONTARIO, CANADA Printed in U.S.A.

©Copyright by the Gorman-Rupp Company

NOVEMBER 30, 1991

REV. A 12/29/98

1 of 4

Page 10.3 C1.7

13C2-M20 S/G

S/N 964637 UP

PUMP ISSUE 1

If your pump serial number is followed by an "N", your pump is NOT a standard production model. Contact the Gorman-Rupp Company to verify part numbers.

ITEM NO.	PART NAME	PART NUMBER	MAT'L CODE	QTY	ITEM NO.	PART NAME	PART NUMBER	MAT'L CODE	QTY
1	PUMP END ASSY	13C2-(M20)	----	1	28	-FLANGED HEX NUT	21765-312	----	1
2	STREET ELBOW	RS48	11990	REF	29	-BATTERY TAG	38818-680	----	1
3	HEX HD CAPSCREW	B1005	15991	6	30	-BATTERY BOX COVER	11870	24000	1
4	LOCKWASHER	J10	15991	6	31	-HEX HD CAPSCREW	B0504	15991	2
5	HEX NUT	D10	15991	6	32	-FLANGED HEX NUT	21765-312	----	2
6	HOIST BAIL ASSY	44714-046	24150	1	33	-HEX HD CAPSCREW	B0503	15991	1
7	KOHLER M20 ENGINE	29127-302	----	1	34	-FLAT WASHER	K05	15991	1
8	WARNING DECAL	2613FE	----	1	35	-FLANGED HEX NUT	21765-312	----	1
9	HEX HD CAPSCREW	B0504	15991	1	36	-BATTERY	SEE OPTIONS		
10	FLANGED HEX NUT	21765-312	----	1	37	-POS CABLE ASSY	47311-542	----	1
11	FLAT WASHER	K05	15991	2	38	-HEX HD CAPSCREW	B0503	15991	1
12	HEX HD CAPSCREW	B0605	15991	4	39	-FLANGED HEX NUT	21765-312	----	1
13	FLANGED HEX NUT	21765-314	----	3	40	-FLAT WASHER	K05	15991	1
14	FUEL TANK	29332-012	----	1	41	-HEX HD CAPSCREW	B0503	15991	1
15	FUEL TANK MTG STRAP	34621-204	15080	2	42	-FLANGED HEX NUT	21765-312	----	1
16	FOAM TAPE	18668-001	----	2	43	-FLAT WASHER	K05	15991	1
17	HEX HD CAPSCREW	B0506	15991	4	44	-BATTERY BOX	11281	24000	1
18	FLAT WASHER	K05	15991	4	45	COMBINATION BASE	41566-106	24150	1
19	FLANGED HEX NUT	21765-312	----	4	46	FLAT WASHER	K06	15991	2
20	FUEL TANK MTG STRAP	34621-205	15080	2	47	HEX HD CAPSCREW	B0606	15991	2
21	FOAM TAPE	18668-001	----	2	48	LOCKWASHER	J06	15991	2
22	HOSE FITTING	26523-462	----	1	49	HEX NUT	D06	15991	2
23	HOSE CLAMP	S1788	----	2	50	MUFFLER KIT	29187-102	----	1
24	2.25 FT. HOSE	18523-366	----	1	OPTIONAL:				
25	POS CABLE ASSY	47311-502	----	1	* 12V BATTERY	S1680	----	1	
26	BATTERY BOX ASSY	GRP40-05	----	1	WHEEL KIT	GRP30-03B	----	1	
27	-HEX HD CAPSCREW	B0503	15991	1					

* INDICATES PARTS RECOMMENDED FOR STOCK

THE GORMAN-RUPP COMPANY • MANSFIELD, OHIO

GORMAN-RUPP OF CANADA LIMITED • ST. THOMAS, ONTARIO, CANADA Printed in U.S.A.

©Copyright by the Gorman-Rupp Company

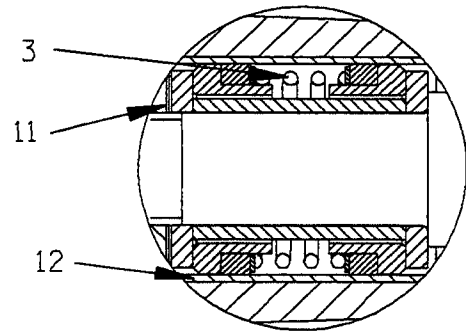

SEAL AREA DETAIL

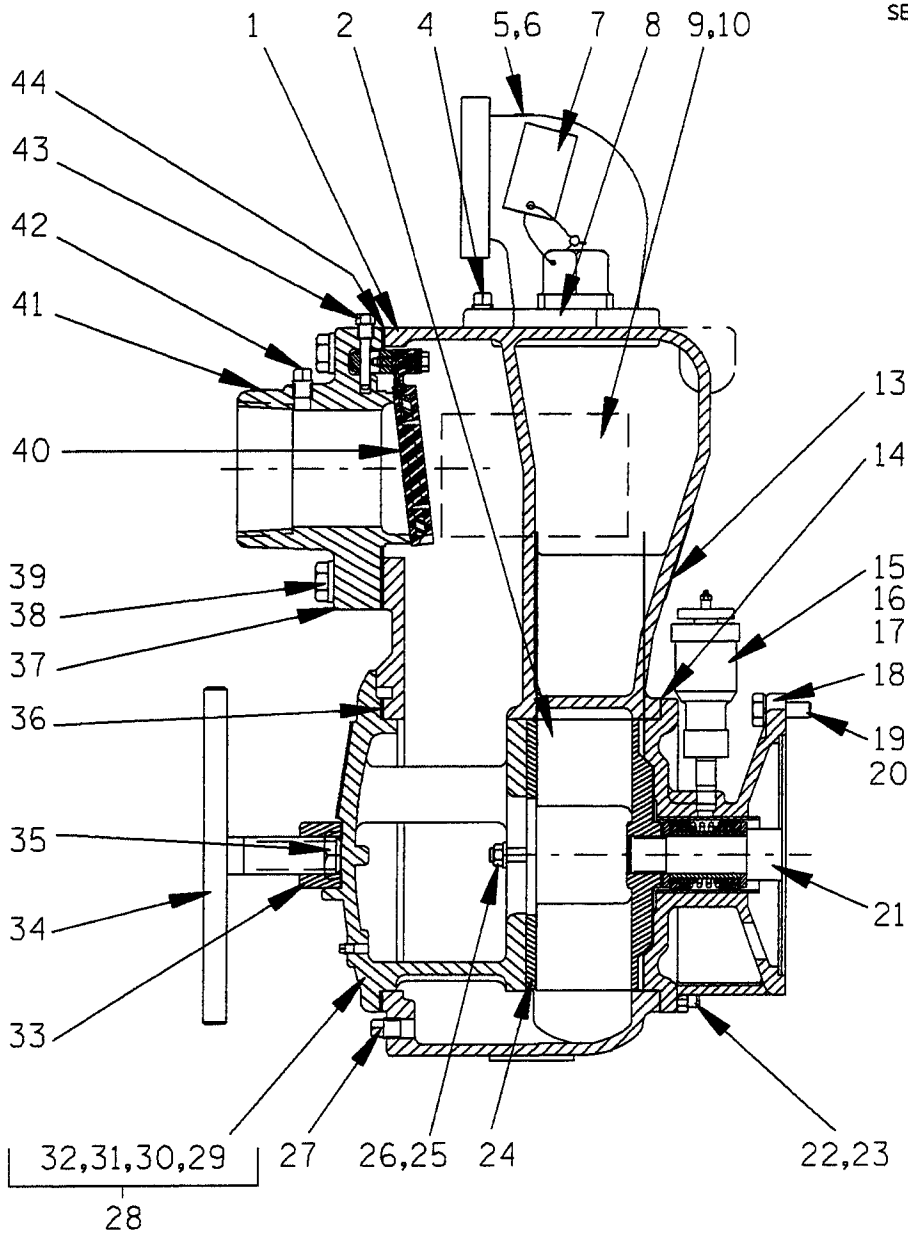

THE GORMAN-RUPP COMPANY • MANSFIELD, OHIO

GORMAN-RUPP OF CANADA LIMITED • ST. THOMAS, ONTARIO, CANADA Printed in U.S.A.

©Copyright by the Gorman-Rupp Company

13C2-M20 S/G

S/N 964637 UP

PUMP ISSUE 1

ITEM NO.	PART NAME	PART NUMBER	MAT'L CODE	QTY	ITEM NO.	PART NAME	PART NUMBER	MAT'L CODE	QTY
1	PUMP CASING	12869	10010	1	25	HEX NUT	D06	15991	2
2 *	IMPELLER	12870B	11000	1	26	LOCKWASHER	J06	15991	2
3 *	SEAL ASSY	46521-013	----	1	27	CASING DRAIN PLUG	P08	11990	1
4	PIPE PLUG	P04	11990	1	28	COVER PLATE ASSY	42111-924	----	1
5	STREET ELBOW	RS48	11990	1	29	-COVER PLATE	NOT AVAILABLE		
6	DISCHARGE STICKER	6588BJ	----	1	30	-WARNING PLATE	2613EV	13990	1
7	FILL PLUG ASSY	48271-069	----	1	31	-DRIVE SCREW	BM#04-03	15990	4
8	PRIMING STICKER	6588AH	----	1	32	-PIPE PLUG	P04	11990	1
9	NAME PLATE	38818-023	13990	1	33	CLAMP	12872	11000	1
10	DRIVE SCREW	BM#04-03	15990	4	34	SCREW	2536	24000	1
11 *	IMP ADJ SHIM SET	2X	17090	REF	35	MACHINE BOLT	A1009	15991	2
12 *	SEAL LINER	83	14080	REF	36 *	BACK COVER GASKET	2985G	19090	1
13	GREASE CUP INST	6588BD	----	1	37	SUCTION FLANGE	12874	10010	1
14 *	CASING GASKET SET	3G	18000	1	38	HEX HD CAPSCREW	B1008	15991	4
15	GREASE CUP	S36	----	1	39	LOCKWASHER	J10	15991	4
16	PIPE NIPPLE	T0408	15070	1	40 *	CHECK VALVE ASSY	46411-060	----	1
17	PIPE COUPLING	AE04	11990	1	41	SUCTION STICKER	6588AG	----	1
18	INTERMEDIATE ASSY	42111-719	----	1	42	PIPE PLUG	P04	11990	1
19	HEX HD CAPSCREW	B0705	15991	4	43	CHECK VALVE PIN	11557A	17010	1
20	LOCKWASHER	J07	15991	4	44 *	SUCTION FLANGE GSKT	11412G	19370	1
21	ENGINE CRANKSHAFT	SEE ENGINE MANUAL							
22	STUD	C0606	15991	8	NOT SHOWN:				
23	HEX NUT	D06	15991	8	STRAINER	4917D	24000		1
24 *	WEAR PLATE ASSY	2634A	15990	1					

* INDICATES PARTS RECOMMENDED FOR STOCK

THE GORMAN-RUPP COMPANY • MANSFIELD, OHIO

GORMAN-RUPP OF CANADA LIMITED • ST. THOMAS, ONTARIO, CANADA Printed in U.S.A.

©Copyright by the Gorman-Rupp Company

**For U.S. and International Warranty Information,
Please Visit www.grpumps.com/warranty
or call:
U.S.: 419-755-1280
International: +1-419-755-1352**

**For Canadian Warranty Information,
Please Visit www.grcanada.com/warranty
or call:
519-631-2870**