



PRIME-AIRE[™] **SERIES**
PUMP MODEL
PA4B60-4045T

MANUAL
PART 2 of 3

PARTS
LIST
WITH
PERFORMANCE CURVE

THE GORMAN-RUPP COMPANY • MANSFIELD, OHIO

GORMAN-RUPP OF CANADA LIMITED • ST. THOMAS, ONTARIO, CANADA Printed in U.S.A.

©Copyright by the Gorman-Rupp Company



The engine exhaust from this product contains chemicals known to the State of California to cause cancer, birth defects or other reproductive harm.

PERFORMANCE CURVE – SECTION A

RECORDING MODEL AND SERIAL NUMBERS

Please record the pump model and serial number in the spaces provided below and in the separate Installation/Operation Manual accompanying your pump. Your Gorman-Rupp distributor needs this information when you require parts or service.

Pump Model: _____

Serial Number: _____

WARRANTY INFORMATION

The pump warranty is provided as part of Gorman-Rupp's support program for customers who operate and maintain their equipment as described in this manual and other accompanying literature. Please note that should the equipment be abused or modified to change its performance beyond the original factory specifications, the warranty will become void and any claim will be denied.

PERFORMANCE CURVE

The performance curve on the following page is based on 70° F (21° C) clear water at sea level, corrected to 0.80 specific gravity, with minimum suction lift. Since pump installations are seldom identical, your performance may be different due to such factors as viscosity, specific gravity, elevation, temperature, and impeller trim.

If your pump serial number is followed by an "N", your pump is **NOT** a standard production model. Contact the Gorman-Rupp Company to verify performance or part numbers.



Pump speed and operating condition points must be within the continuous performance range shown on the curve.

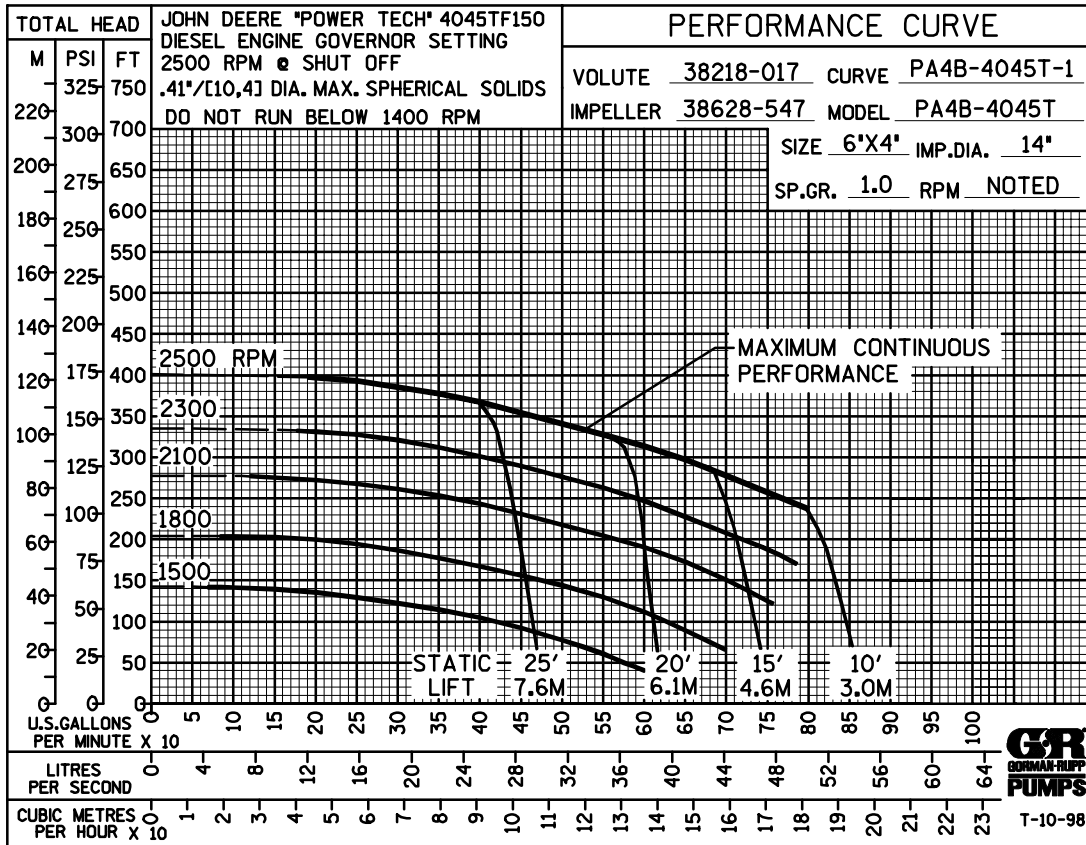

Performance Curve – Model PA4B60-4045T

This Page Intentionally Blank

S/N 1149679 Up
PUMP ISSUE 1

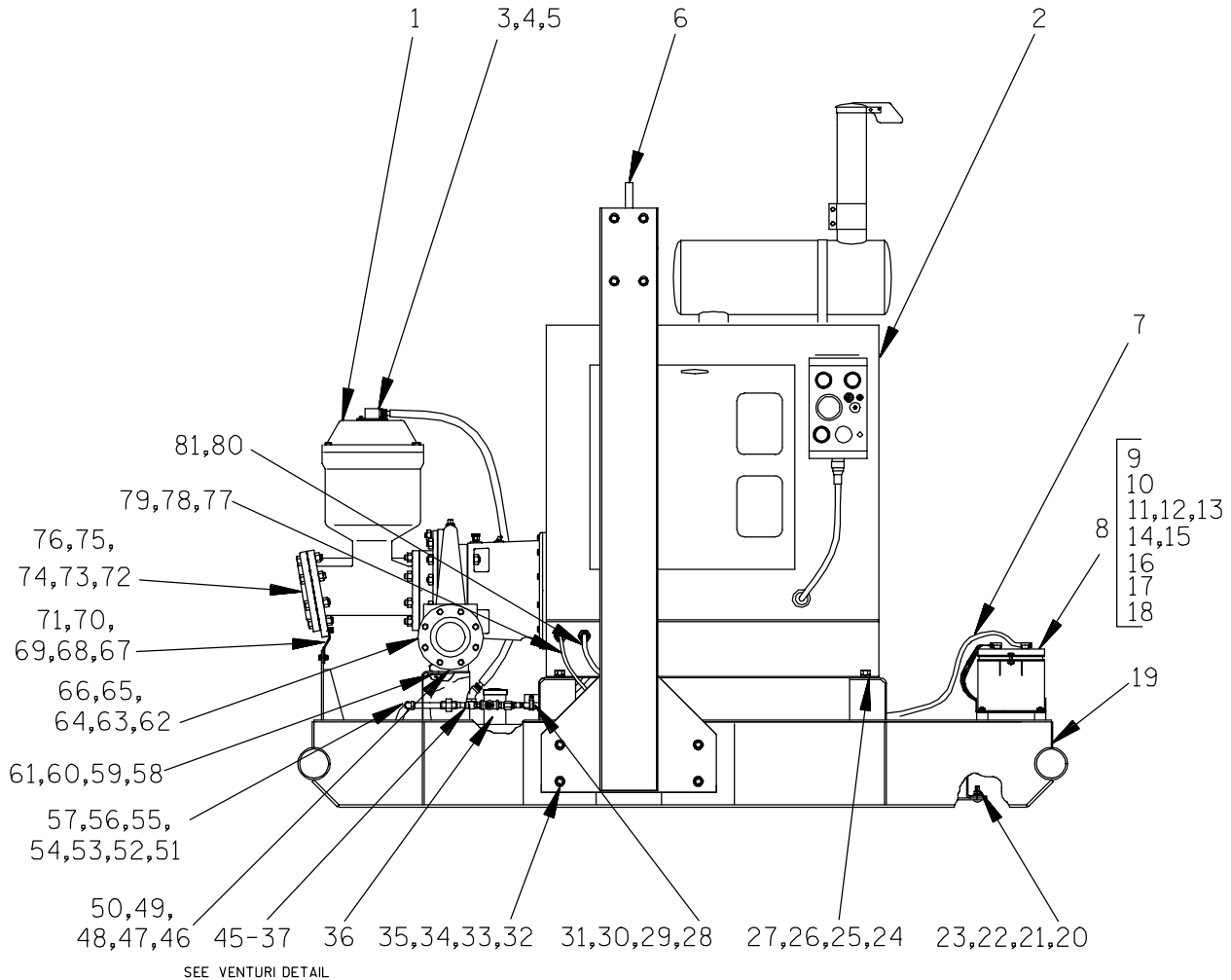

SEE VENTURI DETAIL

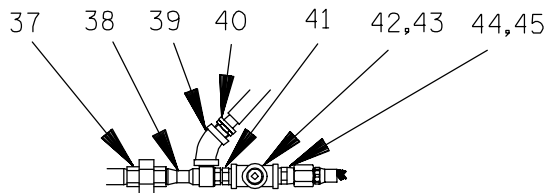

VENTURI DETAIL

THE GORMAN-RUPP COMPANY • MANSFIELD, OHIO

S/N 1149679 Up
PUMP ISSUE 1

PARTS LIST
Pump Model PA4B60-4045T

If your pump serial number is followed by an "N", your pump is **NOT** a standard production model. Contact the Gorman-Rupp Company to verify part numbers.

ITEM NO.	PART NAME	PART NUMBER	MAT'L CODE	QTY	ITEM NO.	PART NAME	PART NUMBER	MAT'L CODE	QTY
1	PUMP END ASSEMBLY	PA4B60-(SAE 4/10)		1	52	HOSE BARB	26525-020	----	1
2	J D 4045T ENGINE	292224-114	----	1	53	CABLE CLAMP	27111-346	----	1
3	REDUCER BUSHING	AP1208	15079	1	54	HEX HD CAPSCREW	B#10-03	15991	1
4	MALE CONNECTOR	26525-020	----	2	55	HEX NUT	D#10	15991	1
5	4' X 1/2" HOSE	18513-113	----	1	56	LOCKWASHER	J#10	15991	1
6	HOISTING BAIL	44714-049	----	1	57	5/8" x 1 1/4' HOSE	18513-304	----	1
7	POS BATTERY CABLE	47311-137	----	1	58	HEX HD CAPSCREW	B1008	15991	2
8	BATTERY BOX ASSY	GRP40-08C	----	1	59	HEX NUT	D10	15991	2
9	-HEX HD CAPSCREW	B0607	15991	2	60	LOCKWASHER	J10	15991	2
10	-FLAT WASHER	K06	15991	2	61	FLAT WASHER	K10	15991	2
11	-FLANGED HEX NUT	21765-314	----	2	62	DISCHARGE FLANGE	1756	10010	1
12	-GRND CABLE ASSY	47311-064	----	1	63	DISCH FLANGE GSKT	1676G	18000	1
13	-BATTERY BOX LID	42113-012	24150	1	64	HEX HD CAPSCREW	B1012	15991	8
14	-12V BATTERY	SEE OPTIONS LIST			65	HEX NUT	D10	15991	8
15	-BATTERY TAG	38818-506	----	1	66	LOCKWASHER	J10	15991	8
16	-BATTERY BOX	42431-030	----	1	67	PRIMING CHAMBER BRKT	34535-010	15120	1
17	-STUD MOUNT	24631-006	----	4	68	HEX HD CAPSCREW	B0604	15991	3
18	-FLANGED HEX NUT	21765-314	----	8	69	HEX NUT	D06	15991	3
19	SKID ASSY	41565-577	24150	1	70	LOCKWASHER	J06	15991	3
20	CARRIAGE BOLT	AB0807	15991	8	71	FLAT WASHER	K06	15991	3
21	HEX NUT	D08	15991	8	72	SUCTION FLANGE	1758	10010	1
22	LOCKWASHER	J08	15991	8	73	SUCT FLANGE GSKT	1679G	18000	1
23	FLAT WASHER	K08	15991	8	74	HEX HD CAPSCREW	B1212	15991	8
24	HEX HD CAPSCREW	B1006	15991	4	75	HEX NUT	D12	15991	8
25	HEX NUT	D10	15991	4	76	LOCKWASHER	J12	15991	8
26	LOCKWASHER	J10	15991	4	77	HOSE BARB FITTING	26523-386	----	2
27	FLAT WASHER	K10	15991	4	78	3' TUBING	18523-366	----	1
28	CABLE CLAMP	27111-346	----	1	79	HOSE CLAMP	26518-641	----	2
29	HEX HD CAPSCREW	B#10-03	15991	1	80	HOSE ASSY	46341-801	----	1
30	HEX NUT	D#10	15991	1	81	MALE CONNECTOR	S1447	----	1
31	LOCKWASHER	J#10	15991	1					
32	HEX HD CAPSCREW	B1008	15991	8		NOT SHOWN:			
33	HEX NUT	D10	15991	8		INSTRUCTION DECAL	38818-128	----	1
34	LOCKWASHER	J10	15991	8		WARNING DECAL	38816-132	----	2
35	FLAT WASHER	K10	15991	16		LUBE DECAL	38816-075	----	1
36	FUEL TANK ASSY	46711-081	----	1		WARNING DECAL	38816-096	----	1
37	PIPE UNION	AH08	11999	1		SUCTION STICKER	6588AG	----	1
38	VENTURI	26817-002	----	1		DISCHARGE STICKER	6588BJ	----	1
39	45° ELBOW	AG08	11999	1		LIFT DECAL	38816-175	----	1
40	HOSE BARB	26525-021	----	1		LIFT DECAL	38816-218	----	2
41	REDUCER BUSHING	AP0806	15079	1		PRIME-AIRE DECAL	38812-078	----	2
42	PIPE TEE	U08	11999	1		WARNING DECAL	2613FE	----	1
43	RELIEF VALVE	26662-028	----	1		RPM DECAL	2613FJ	----	1
44	MALE ADAPTOR	26351-065	----	1		ENG START-UP TAG	38816-269	----	1
45	HOSE ASSY	46341-422	----	1		INSTR TAG PAPER	38817-017	----	1
46	SUPPORT	34534-025	15120	1		NAME PLATE	38818-127	13000	1
47	HEX HD CAPSCREW	B0605	15991	2		DRIVE SCREW	BM#04-03	17000	4
48	HEX NUT	D06	15991	2		STRAINER	S1529	----	1
49	LOCKWASHER	J06	15991	2					
50	FLAT WSHER	K06	15991	2		OPTIONAL:			
51	PIPE ELBOW	R08	11999	1		12V BATTERY	29331-506	----	1

* INDICATES PARTS RECOMMENDED FOR STOCK

THE GORMAN-RUPP COMPANY • MANSFIELD, OHIO

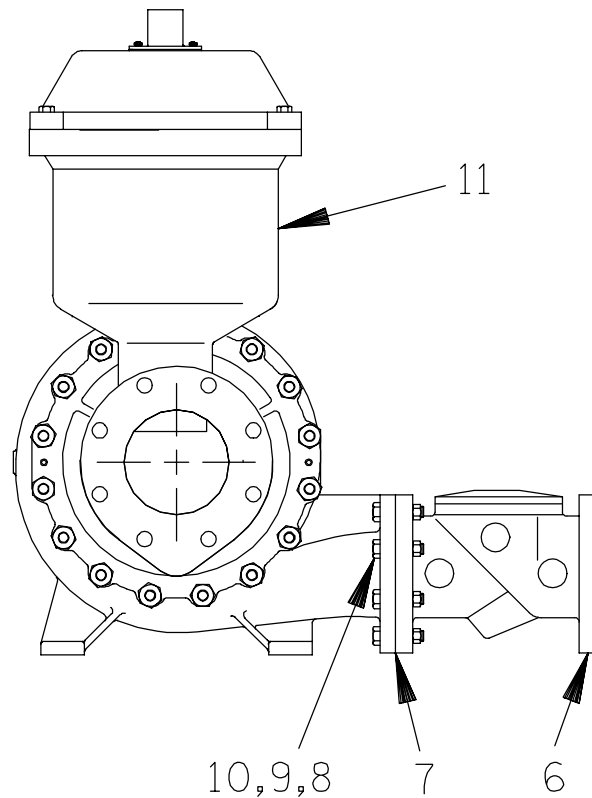
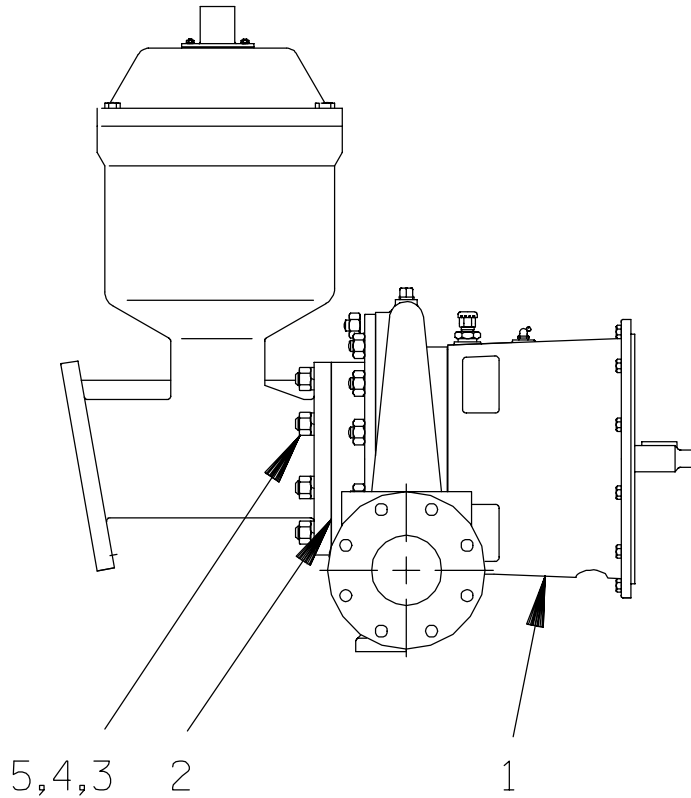

THE GORMAN-RUPP COMPANY • MANSFIELD, OHIO

S/N 1149679 Up
PUMP ISSUE 1

PARTS LIST
PA4B60-4045T Pump Assembly

ITEM NO.	PART NAME	PART NUMBER	MAT'L CODE	QTY
1	PUMP END ASSY	64B60-(SAE4/10)	---	1
2	* PUMP CASING GSKT	1679G	18000	1
3	STUD	C1211	15991	8
4	HEX NUT	D12	15991	8
5	LOCKWASHER	J12	15991	8
6	CHECK VALVE ASSY	26642-124	---	1
	-FLAPPER	26688-001	---	1
	-COVER GASKET	26688-002	---	1
7	DISCHARGE FLANGE GSKT	1676G	18000	1
8	HEX HD CAPSCREW	B1010	15991	6
9	HEX NUT	D10	15991	6
10	LOCKWASHER	J10	15991	6
11	PRIMING CHAMBER ASSY	46112-703	---	1

* INDICATES PARTS RECOMMENDED FOR STOCK

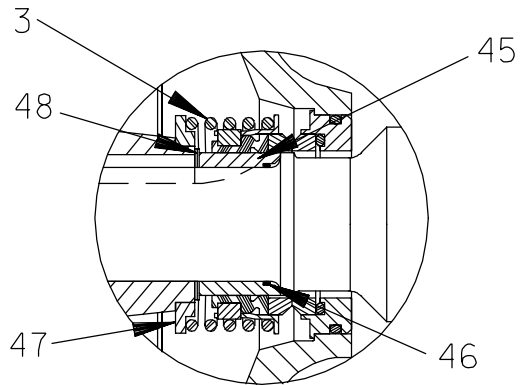
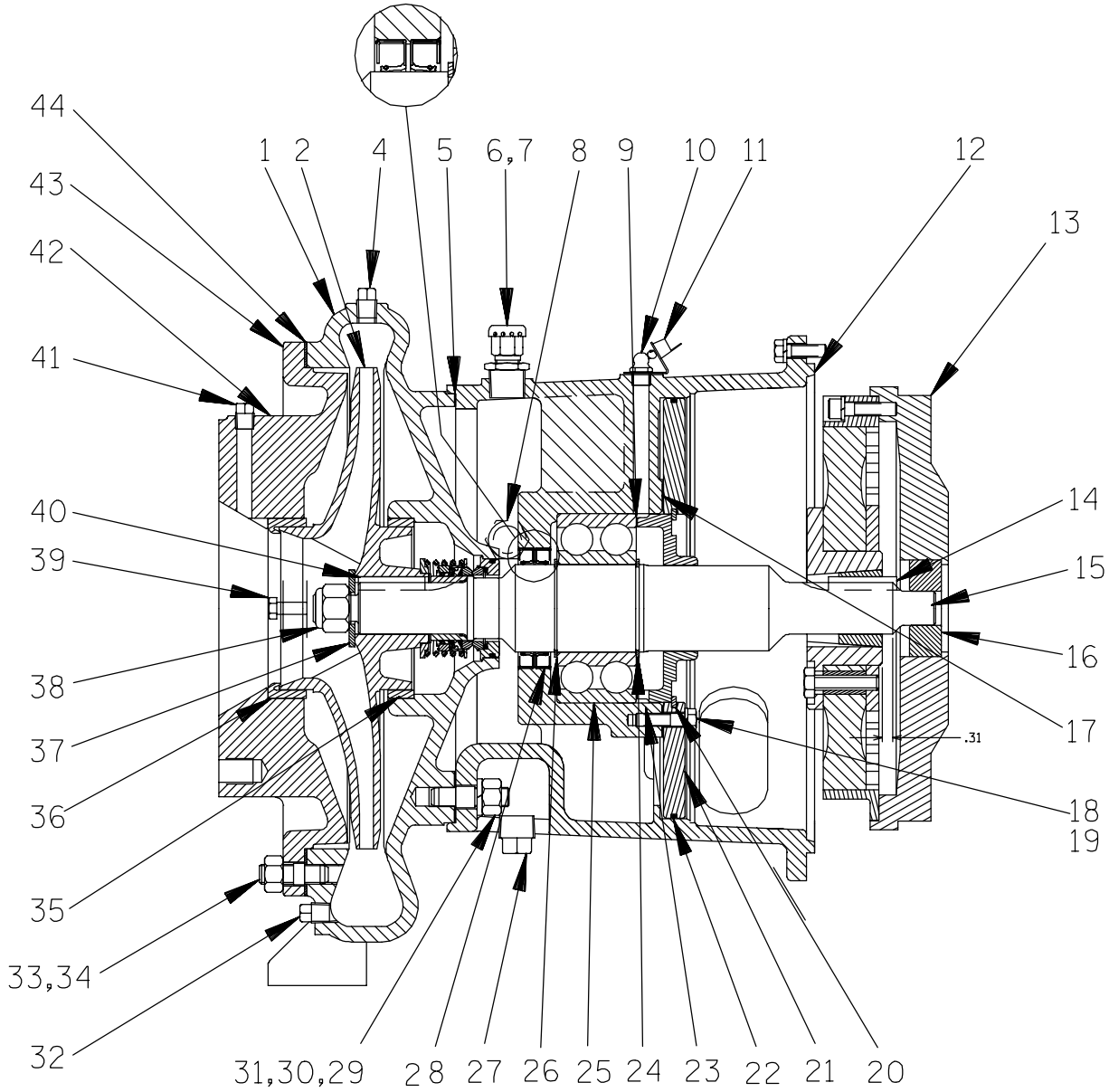

SEAL AREA DETAIL

THE GORMAN-RUPP COMPANY • MANSFIELD, OHIO

S/N 1149679 Up
PUMP ISSUE 1

PARTS LIST
64B60-(SAE4/10) Pump End Assembly

ITEM NO.	PART NAME	PART NUMBER	MAT'L CODE	QTY	ITEM NO.	PART NAME	PART NUMBER	MAT'L CODE	QTY
1	PUMP CASING	38218-017	10000	1	28 *	OIL SEAL	25227-773	----	1
2 *	IMPELLER ASSY	38628-547	10010	1	29	STUD	C1009	15991	4
3 *	SEAL ASSY	46512-048	----	1	30	HEX NUT	D10	15991	4
4	PIPE PLUG	P06	15079	1	31	LOCKWASHER	J10	15991	4
5 *	CASING GASKET SET	38684-502	18000	1	32	CASING DRAIN PLUG	P06	15079	1
6	AIR VENT	S1703	----	1	33	STUD	C1009	15991	16
7	RED PIPE BUSHING	AP1206	15079	1	34	HEXNUT	D10	15991	16
8	SIGHT GAUGE	S1471	----	1	35 *	BALANCE RING	64H6	14000	1
9 *	BRG ADJ SHIM SET	8548	15990	1	36 *	WEAR RING	64H5	14000	1
10	LUBE FITTING	S194	----	1	37	FLAT WASHER	K14	15991	1
11	CAP PLUG	25141-151	----	1	38	NYLON LOCKNUT	BC14S	15991	1
12	INTERMEDIATE	38264-703	10000	1	39	HEX HD CAPSCREW	B0604	15991	2
13	DRIVE ASSEMBLY	44162-119	----	1	40 *	IMPELLER KEY	N0608	15990	1
14 *	SHAFT KEY	N0608	15990	1	41	PIPE PLUG	P04	15079	1
15 *	IMPELLER SHAFT	38515-585	1706H	1	42	SUCTION STICKER	6588AG	----	1
16	PILOT BUSHING	8312A	15010	1	43	SUCTION HEAD	38247-418	10000	1
17 *	INTERMEDIATE GSKT	38683-446	18000	1	44 *	SUCTION HEAD GSKT	7557G	18000	1
18	HEX HD CAPSCREW	B0606	15991	3	45 *	SHAFT SLEEVE	31163-018	17060	1
19	LOCKWASHER	J06	15991	3	46 *	SHAFT SLEEVE O-RING	25152-026	----	1
20	RETAINING RING	24121-080	----	1	47	SPRING HOLDER	31167-023	15000	1
21	OIL CHAMBER PLATE	31255-009	15080	1	48	IMP SHIM SET	5091	17090	1
22	OIL CHMBR PLT O-RING	25152-278	----	1	NOT SHOWN:				
23	BEARING RETAINER	38322-526	10000	1		OIL LEVEL DECAL	38816-123	----	1
24	RETAINING RING	S720	----	1		STRAINER	S1529	----	1
25 *	DBL ROLLER BEARING	23421-414	----	1		DRIVE SCREW	BM#04-03	17000	2
26	RETAINING RING	S720	----	1		NAME PLATE	38818-127	13990	1
27	OIL CVTY DRAIN PLUG	P12	15079	1		DISCHARGE STICKER	6588BJ	----	1

* INDICATES PARTS RECOMMENDED FOR STOCK

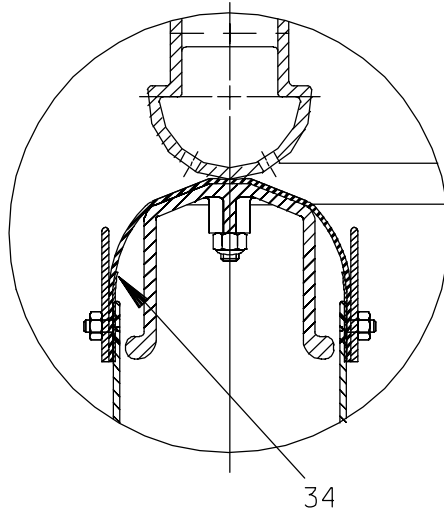

VALVE DETAIL

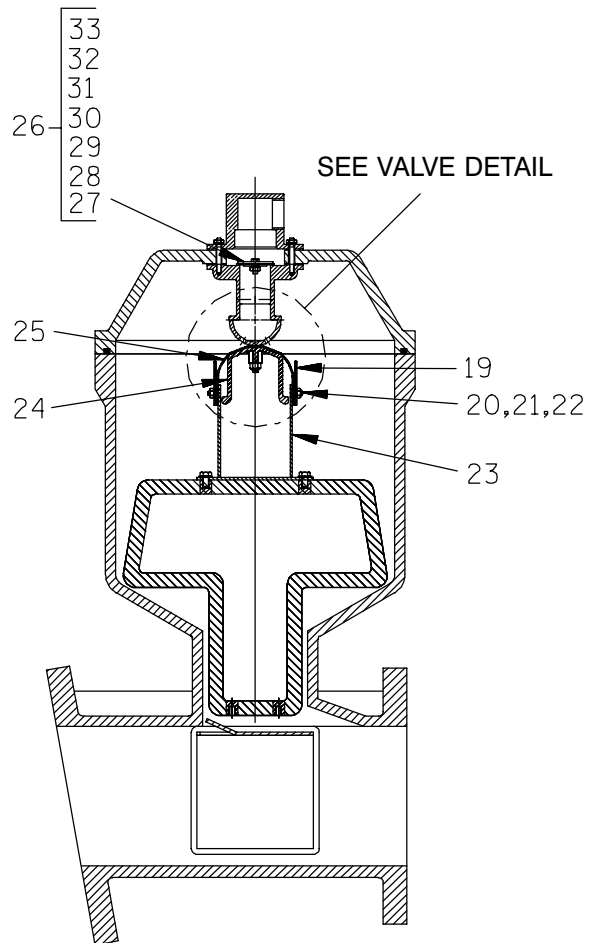
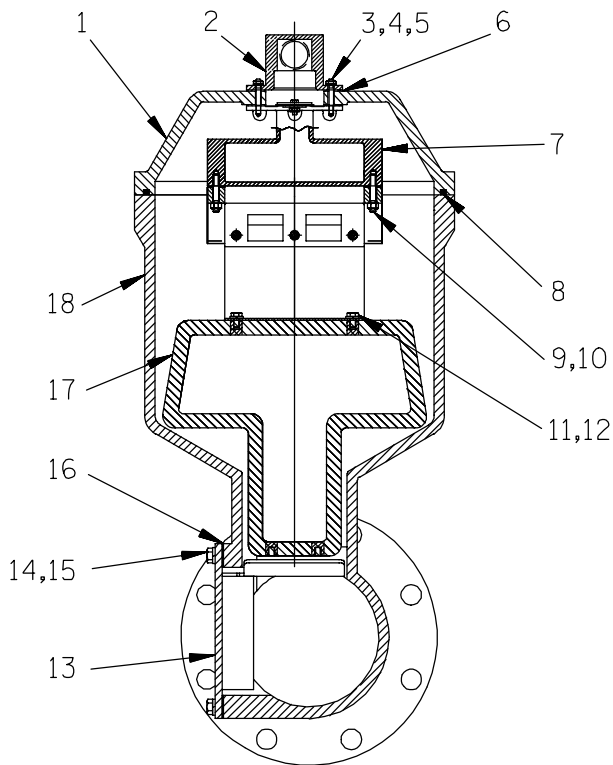

THE GORMAN-RUPP COMPANY • MANSFIELD, OHIO

S/N 1149679 Up
PUMP ISSUE 1

PARTS LIST
46112-703 Peeler Type Priming Valve

ITEM NO.	PART NAME	PART NUMBER	MAT'L CODE	QTY	ITEM NO.	PART NAME	PART NUMBER	MAT'L CODE	QTY
1	PRIMING CHAMBER LID	38346-613	13000	1	20	FLAT HD CAPSCREW	F#10-03	17000	6
2	PEELER VALVE NECK	38349-410	10000	1	21	LOCKWASHER	J#10	17000	6
3	LOCKWASHER	J#10	17000	4	22	HEX NUT	D#10	17000	6
4	HEX NUT	D#10	17000	4	23	VLV STRAP BRKT ASSY	41881-523	2415X	1
5	STUD	21332-038	---	4	24	CLAMP PLATE	38349-406	14000	1
6 *	NECK GASKET	38683-266	19020	1	25	VALVE STRAP	33276-041	19000	1
7	VALVE BODY	38343-014	14000	1	26	CHECK VALVE ASSY	46411-112	---	1
8 *	GASKET STRIP 4.06' LG	18515-031	---	1	27 *	-CHECK VALVE	38671-413	19020	1
9	STUD	C0406 1/2	17000	2	28	-LOCKWASHER	J#10	17000	1
10	HEX LOCK NUT	BC04	17000	2	29	-HEX NUT	D#10	17000	1
11	HEX HD CAPSCREW	B0403	17000	4	30	-FLATWASHER	21161-810	---	1
12	LOCKWASHER	J04	17000	4	31	-HEX HD CAPSCREW	B#10-02	17000	1
13	INDUCTOR GUARD ASSY	42381-066	24150	1	32	-FLATWASHER	21161-811	---	1
14	HEX HD CAPSCREW	B0605	15991	4	33	-SEALING WASHER	S1590	---	1
15	LOCKWASHER	J06	15991	4	34	VLV STRAP PROTECTOR	33271-019	19000	2
16 *	CHAMBER GSKT	38687-552	18000	1	NOT SHOWN:				
17 *	PRIMING VALVE FLOAT	38349-404	19220	1		HEX HD CAPSCREW	B0807	15991	4
18	PRIMING CHAMBER	38343-017	10000	1		PIPE PLUG	P04	15079	1
19	GUIDE PLATE	33522-009	17000	2					

* INDICATES PARTS RECOMMENDED FOR STOCK

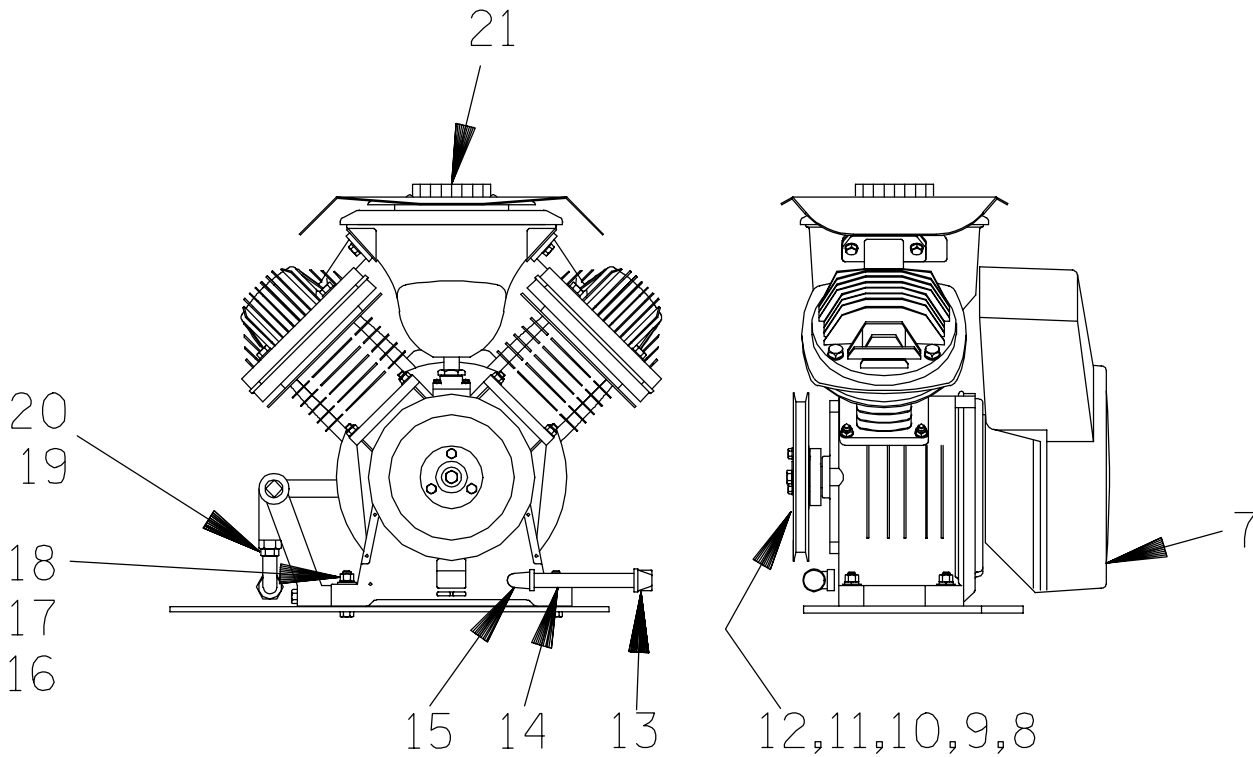
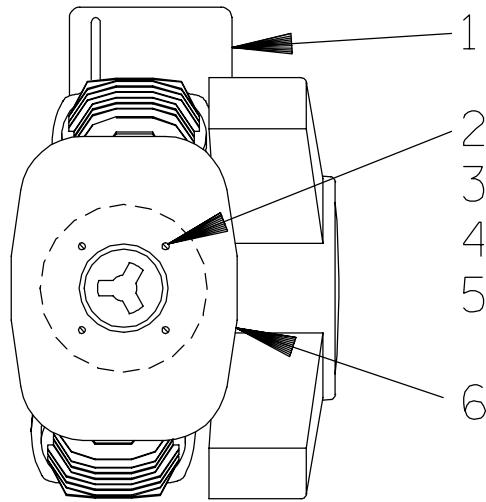

THE GORMAN-RUPP COMPANY • MANSFIELD, OHIO

S/N 1149679 Up
PUMP ISSUE 1

PARTS LIST
46181-903 Air Compressor Assembly

ITEM NO.	PART NAME	PART NUMBER	MAT'L CODE	QTY
1	AIR COMPRESSOR MOUNTING PLATE	41881-584	---	1
2	MACHINE SCREW	X#10-02	15991	4
3	HEX NUT	D#10	15991	4
4	LOCKWASHER	J#10	15991	4
5	FLAT WASHER	K#10	15991	4
6	AIR COMPRESSOR COVER	38354-043	15120	1
7	ATLAS COPCO AIR COMPRESSOR	26813-111	---	1
8	SHEAVE	24226-003	---	1
9	BUSHING	24131-611	---	1
10	CAPSCREW	22645-164	---	3
11	SHAFT EXTENSION	31412-070	15000	1
12	PULLEY KEY	24113-601	---	1
13	PIPE CAP	V06	15079	1
14	PIPE NIPPLE	T0616	15079	1
15	STREET ELBOW	RS06	11999	1
16	HEX NUT	D06	15991	4
17	LOCKWASHER	J06	15991	4
18	FLAT WASHER	K06	15991	4
19	MALE ADAPTOR	25812-243	---	1
20	PUSHLOK ELBOW	26523-035	---	1
21	AIR COMPRESSOR KNOB	38429-501	19220	1

THE GORMAN-RUPP COMPANY • MANSFIELD, OHIO

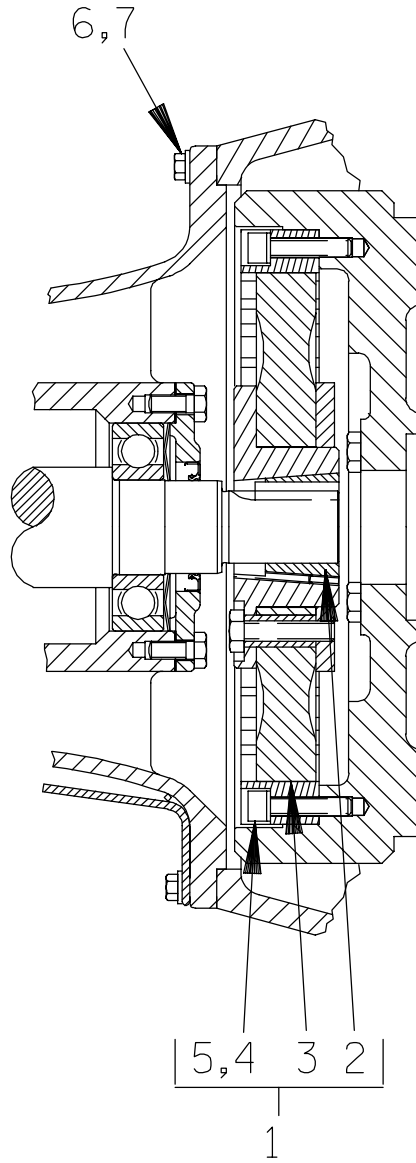

44162-119 Drive Assembly

ITEM NO.	PART NAME	PART NUMBER	MAT'L CODE	QTY
1	COUPLING KIT	48112-001	---	1
2	-BUSHING	24131-345	---	1
3	-COUPLING ASSY	44165-011	---	1
4	-LOCKWASHER	21171-536	---	8
5	-SOCKET HD CAPSCREW	B0606 1/2	15991	8
6	HEX HD CAPSCREW	B0605	15991	12
7	LOCKWASHER	J06	15991	12

THE GORMAN-RUPP COMPANY • MANSFIELD, OHIO

**For U.S. and International Warranty Information,
Please Visit www.grpumps.com/warranty
or call:
U.S.: 419-755-1280
International: +1-419-755-1352**

**For Canadian Warranty Information,
Please Visit www.grcanada.com/warranty
or call:
519-631-2870**