

ACE

Use With: OM-04760  
MR-04959

PUBLICATION NUMBER PL-04786-01

February 9, 1999

Rev. A 02/09/99

Supersedes: OM-04125-01



**PUMP MODEL**  
**13D-M8**

**MANUAL**  
**PART 2 of 3**

**PARTS**  
**LIST**  
**WITH**  
**PERFORMANCE CURVE**

**THE GORMAN-RUPP COMPANY • MANSFIELD, OHIO**

**GORMAN-RUPP OF CANADA LIMITED • ST. THOMAS, ONTARIO, CANADA** Printed in U.S.A.

©Copyright by the Gorman-Rupp Company



**The engine exhaust from this product contains chemicals known to the State of California to cause cancer, birth defects or other reproductive harm.**

## PERFORMANCE CURVE – SECTION A

### RECORDING MODEL AND SERIAL NUMBERS

Please record the pump model and serial number in the spaces provided below and in the separate Installation/Operation Manual accompanying your pump. Your Gorman-Rupp distributor needs this information when you require parts or service.

Pump Model: \_\_\_\_\_

Serial Number: \_\_\_\_\_

### WARRANTY INFORMATION

The pump warranty is provided as part of Gorman-Rupp's support program for customers who operate and maintain their equipment as described in this manual and other accompanying literature. Please note that should the equipment be abused or modified to change its performance beyond the original factory specifications, the warranty will become void and any claim will be denied.

### PERFORMANCE CURVES

The performance curves on the following page are based on 70° F (21° C) clear water at sea level. Since pump installations are seldom identical, your performance may be different due to such factors as viscosity, specific gravity, elevation, temperature, and impeller trim.

If your pump serial number is followed by an "N", your pump is **NOT** a standard production model. Contact the Gorman-Rupp Company to verify performance or part numbers.

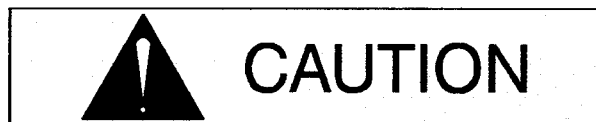

Pump speed and operating condition points must be within the continuous performance range shown on the curve(s).

**This Page Intentionally Blank**

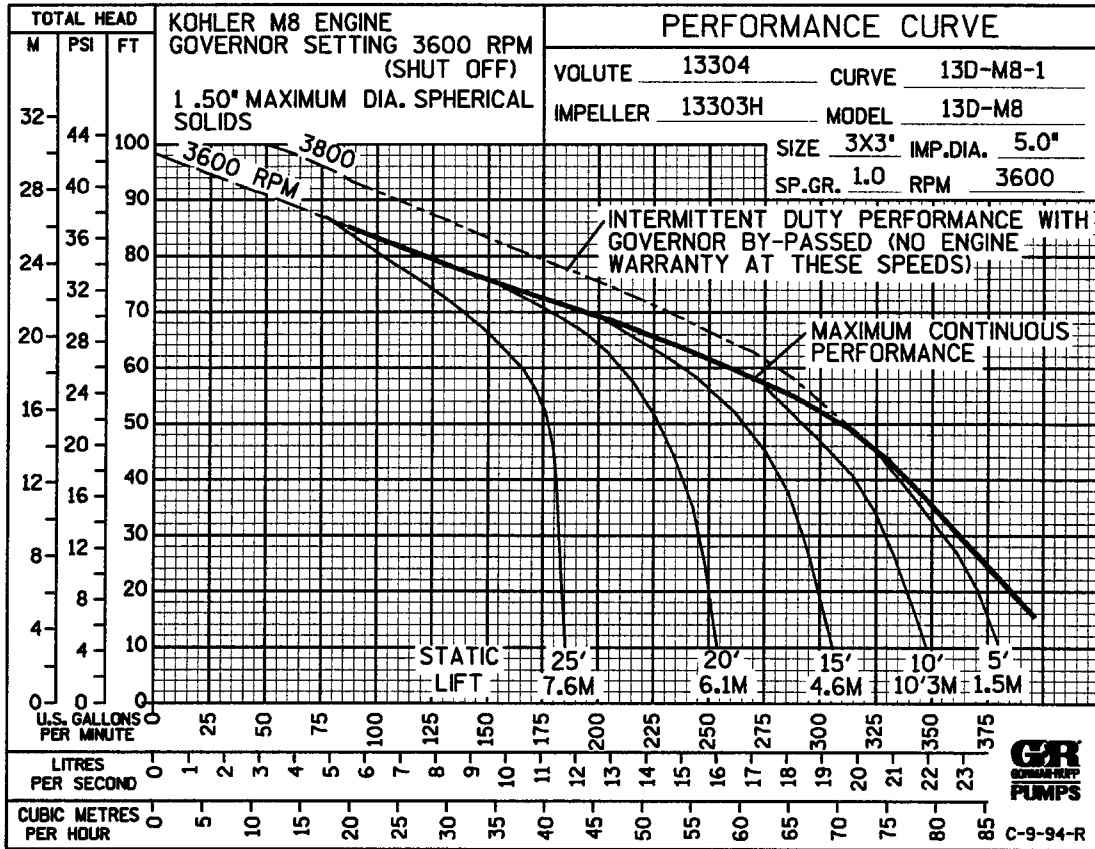

Performance Curve – Model 13D-M8

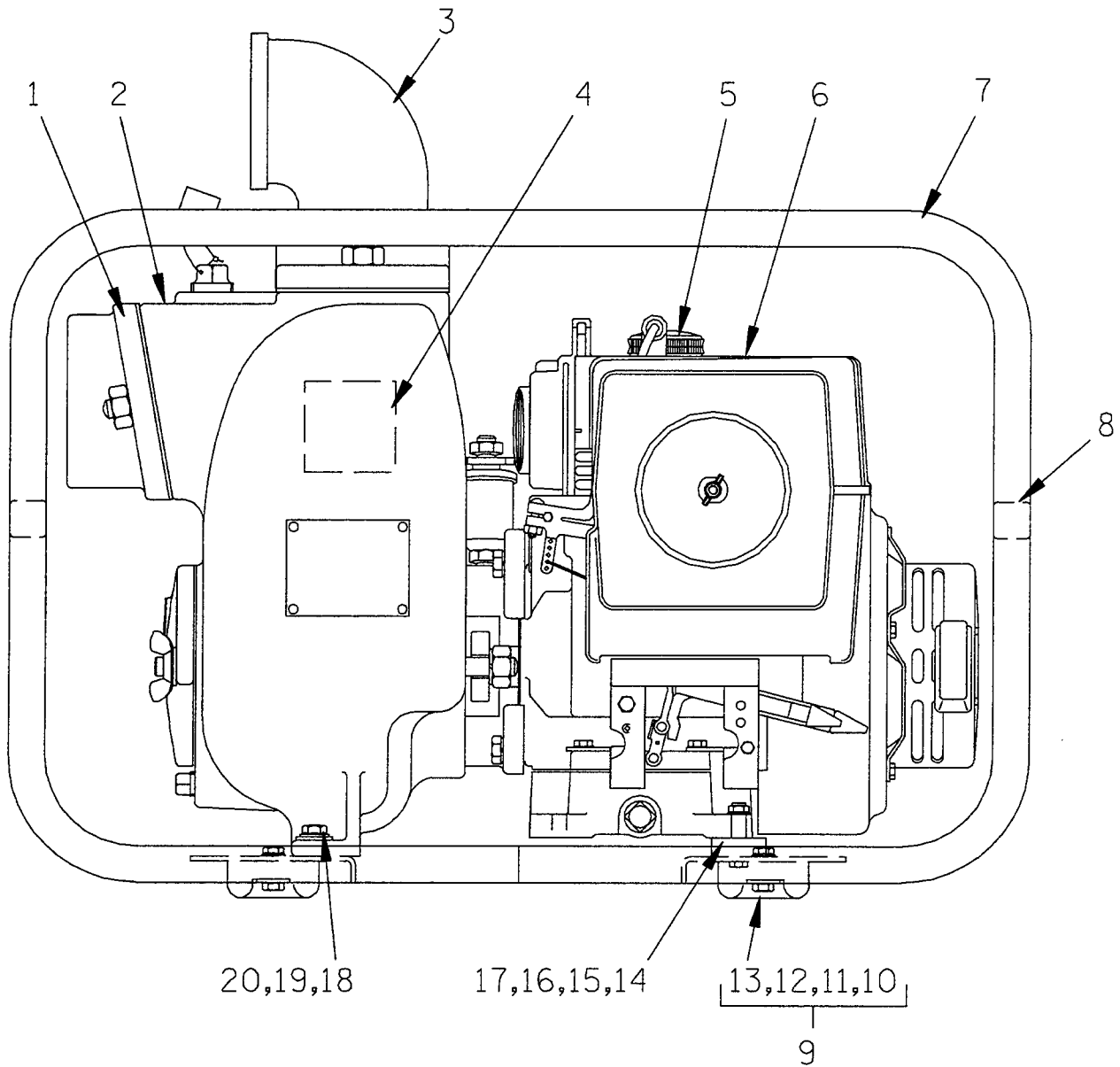

**THE GORMAN-RUPP COMPANY • MANSFIELD, OHIO**

GORMAN-RUPP OF CANADA LIMITED • ST. THOMAS, ONTARIO, CANADA Printed in U.S.A.

©Copyright by the Gorman-Rupp Company

# 13D-M8

S/N 1067420 UP

## PUMP ISSUE 1

If your pump serial number is followed by an "N", your pump is NOT a standard production model. Contact the Gorman-Rupp Company to verify part numbers.

ITEM NO.	PART NAME	PART NUMBER	MAT'L CODE	QTY
1	PUMP END ASSY	13D-(M8)	---	1
2	PRIMING STICKER	6588AH	---	1
3	STREET ELBOW	RS48	11999	REF
4	GREASE CUP INSTRUCTION	6588BD	---	1
5	KOHLER M8 ENGINE	29127-084	---	1
6	WARNING DECAL	2613FE	---	1
7	ROLLOVER BASE	41583-315	24150	1
8	HAND CARRY DECAL	2613FT	---	2
9	RUBBER FOOT MOUNTING KIT	48152-603	---	1
10	-RUBBER BUMPER	S1224	---	4
11	-FLAT WASHER	K05	15991	4
12	-HEX HD CAPSCREW	B0504	15991	4
13	-FLANGED HEX NUT	21765-312	---	2
14	FLAT WASHER	KE06	15991	2
15	SPACER	31141-027	13000	2
16	FLANGED HEX NUT	21765-314	---	2
17	HEX HD CAPSCREW	B0607	15991	2
18	FLAT WASHER	KE06	15991	2
19	HEX HD CAPSCREW	B0605	15991	2
20	FLANGED HEX NUT	21765-314	---	2

OPTIONAL:

WHEEL KIT	GRP30-51	---	1
-----------	----------	-----	---

\* INDICATES PARTS RECOMMENDED FOR STOCK

## THE GORMAN-RUPP COMPANY • MANSFIELD, OHIO

GORMAN-RUPP OF CANADA LIMITED • ST. THOMAS, ONTARIO, CANADA Printed in U.S.A.

©Copyright by the Gorman-Rupp Company

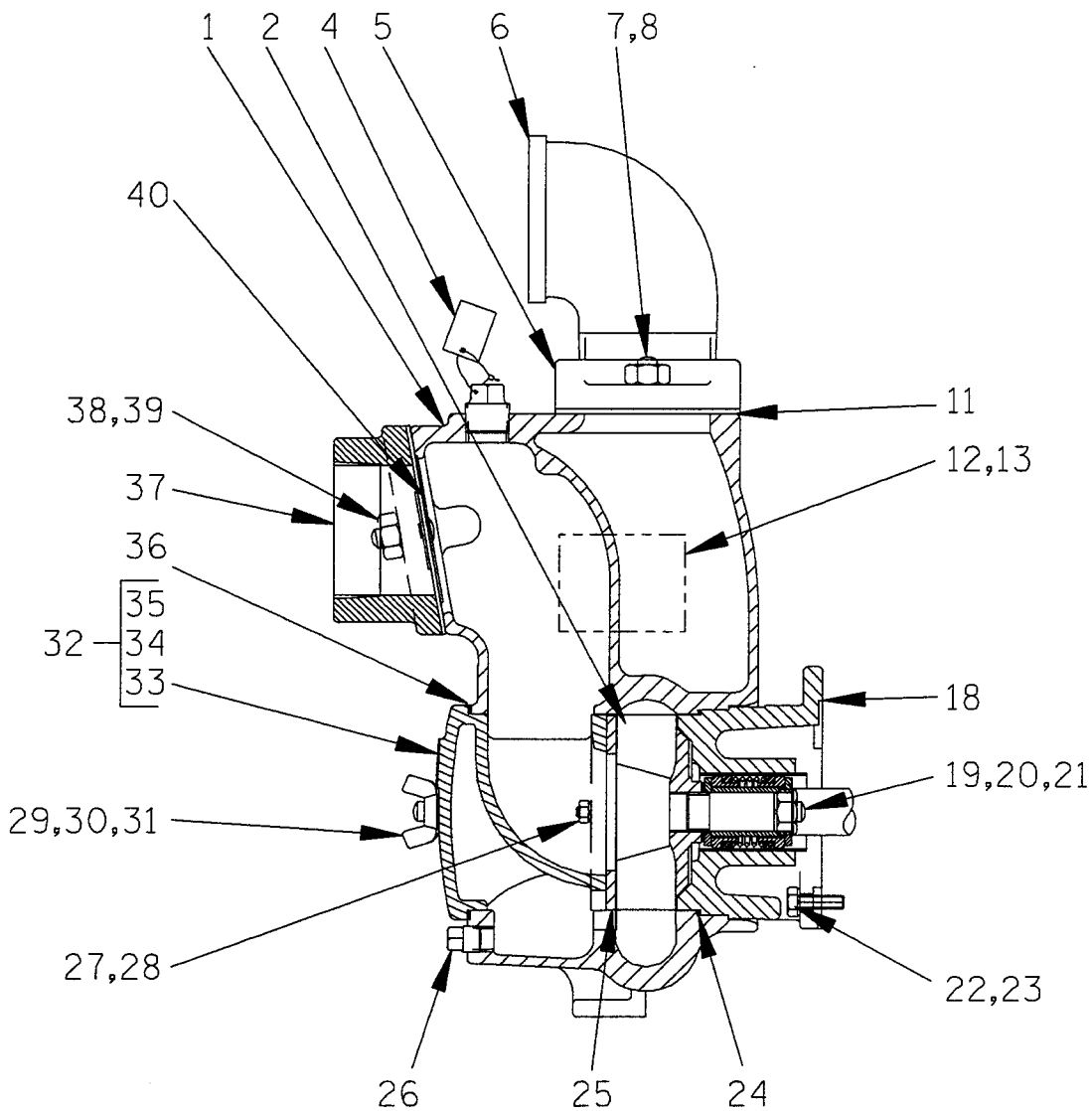
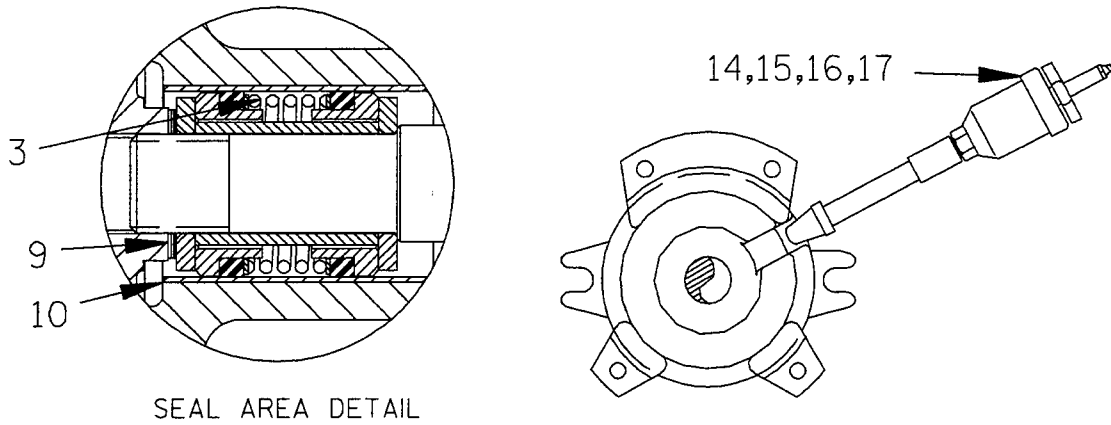

**THE GORMAN-RUPP COMPANY • MANSFIELD, OHIO**

GORMAN-RUPP OF CANADA LIMITED • ST. THOMAS, ONTARIO, CANADA Printed in U.S.A.

©Copyright by the Gorman-Rupp Company



# 13D-M8

S/N 1067420 UP

PUMP ISSUE 1

ITEM NO.	PART NAME	PART NUMBER	MAT'L CODE	QTY	ITEM NO.	PART NAME	PART NUMBER	MAT'L CODE	QTY
1	PUMP CASING	13304	13040	1	24 *	INTERMEDIATE O-RING	25152-248	---	1
2 *	IMPELLER	13303H	11060	1	25 *	WEAR PLATE	2643B	15990	1
3 *	SEAL ASSY	46521-014	---	1	26	CASING DRAIN PLUG	P06	15079	1
4	FILL PLUG ASSY	48271-063	---	1	27	LOCKWASHER	J04	15991	2
5	DISCHARGE FLANGE	13427	13040	1	28	HEX NUT	D04	15991	2
6	ST ELBOW	RS48	11999	1	29	STUD	C0808	15991	2
7	STUD	C0807	15991	2	30	FLAT WASHER	K08	15991	2
8	HEX NUT	D08	15991	2	31	COVER WING NUT	BB08	15991	2
9 *	IMP ADJ SHIM SET	2X	17090	REF	32	COVER PLATE ASSY	42111-919	---	1
10 *	SEAL LINER	83	14080	REF	33	-WARNING PLATE	2613EV	13990	1
11 *	DISCH FLANGE GSKT	13428	20000	1	34	-DRIVE SCREW	BM#04-03	17000	4
12	NAME PLATE	38818-021	13990	1	35	-BACK COVER PLATE	NOT AVAILABLE		1
13	DRIVE SCREW	BM#04-03	17000	4	36 *	COVER PLATE GSKT	12369G	20000	1
14	STREET ELBOW	AGS04	11999	1	37	SUCTION FLANGE	13425	13040	1
15	GREASE CUP	S36	---	1	38	STUD	C0807	15991	2
16	PIPE NIPPLE	T0412	15079	1	39	HEX NUT	D08	15991	2
17	COUPLING	AE04	11999	1	40 *	CHECK VALVE ASSY	13426	---	1
18	INTERMEDIATE	38264-222	13040	1	NOT SHOWN:				
19	STUD	C0808	15991	2		STRAINER	4917	24001	1
20	FLAT WASHER	K08	15991	2		SUCTION STICKER	6588AG	---	1
21	HEX NUT	D08	15991	2		DISCHARGE STICKER	6588BJ	---	1
22	HEX HD CAPSCREW	B0605	15991	4					
23	LOCKWASHER	J06	15991	4					

\* INDICATES PARTS RECOMMENDED FOR STOCK

## THE GORMAN-RUPP COMPANY • MANSFIELD, OHIO

GORMAN-RUPP OF CANADA LIMITED • ST. THOMAS, ONTARIO, CANADA Printed in U.S.A.

©Copyright by the Gorman-Rupp Company

**For U.S. and International Warranty Information,  
Please Visit [www.grpumps.com/warranty](http://www.grpumps.com/warranty)  
or call:  
U.S.: 419-755-1280  
International: +1-419-755-1352**

**For Canadian Warranty Information,  
Please Visit [www.grcanada.com/warranty](http://www.grcanada.com/warranty)  
or call:  
519-631-2870**