

AC

Use With: OM-04151
MR-04152

PUBLICATION NUMBER PL-04684-01

Pump Issue 1
May 1, 1997



**PUMP MODEL
S4H1 - E10 575/3**

**MANUAL
PART 2 of 3**

**PARTS
LIST
WITH
PERFORMANCE CURVE**

THE GORMAN-RUPP COMPANY • MANSFIELD, OHIO

GORMAN-RUPP OF CANADA LIMITED • ST. THOMAS, ONTARIO, CANADA Printed in U.S.A.

©Copyright by the Gorman-Rupp Company

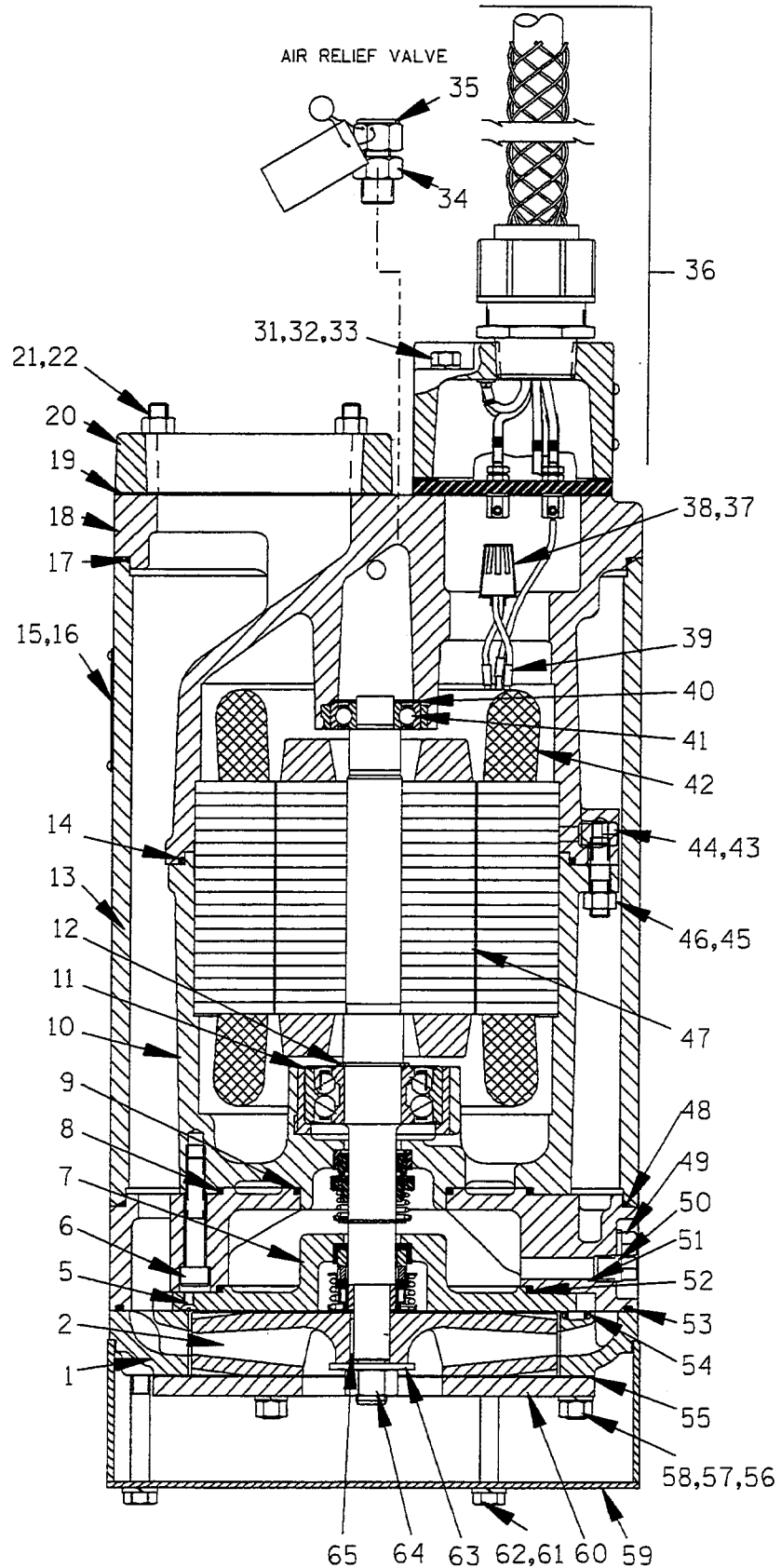
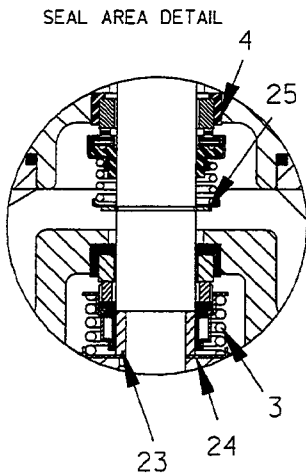
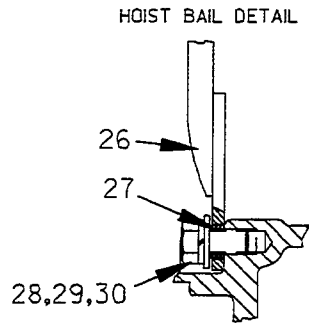

THE GORMAN-RUPP COMPANY • MANSFIELD, OHIO

GORMAN-RUPP OF CANADA LIMITED • ST. THOMAS, ONTARIO, CANADA

Printed in U.S.A.

S/N 1129913 Up
PUMP ISSUE 1

If your pump serial number is followed by an "N", your pump is NOT a standard production model. Contact the Gorman-Rupp Company to verify part numbers.

ITEM NO.	PART NAME	PART NUMBER	MAT'L CODE	QTY	ITEM NO.	PART NAME	PART NUMBER	MAT'L CODE	QTY
1	DIFFUSER	38632-061	1102H	1	42	STATOR	47113-846	----	1
2 *	IMPELLER	38622-519	1102H	1	43	A HD SETSCREW	GA0501 1/4	15990	2
3 *	SEAL ASSY	46512-057	----	1	44	PIPE PLUG	38649-022	17030	2
4	SEAL	S1832	----	1	45	STUD	C0606	17000	8
5	MACH SCREW	Y#10-03	17000	3	46	DEFORM LK NUT	DD06	17000	8
6	SOC HD CAPSCREW	DM0609	17000	3	47	ROTOR W/SHAFT	47112-816	----	1
7	SEAL PLATE	13882	1102H	1	48 *	O-RING	S1830	----	1
8 *	O-RING	25152-259	----	1	49	PIPE PLUG	P04	17000	1
9 *	O-RING	25152-234	----	1	50	PIPE PLUG	P04	17000	1
10	MTR HOUSING	38311-049	13040	1	51	INTERMEDIATE	13883	13040	1
11 *	BALL BEARING	23431-303	----	1	52 *	O-RING	25152-259	----	1
12	SNAP RING	S1831	----	1	53 *	O-RING	S1830	----	1
13	PUMP CASING	11982	13175	1	54 *	O-RING	25152-012	----	3
14 *	O-RING	25152-265	----	1	55 *	GASKET	38683-655	20000	1
15	NAME PLATE	38814-055	17000	1	56	STUD	C0612	17000	3
16	DRIVE SCREW	BM#04-03	17000	4	57	LOCK WASHER	J06	17000	3
17 *	O-RING	S1830	----	1	58	HEX NUT	D06	17000	3
18	UPR MOTOR HSG	38311-058	13000	1	59	STRAINER ASSY	11969	2400V	1
19 *	GASKET	11957G	20000	1	60 *	WEAR PLATE	11948A	15010	1
20	DISCH FLANGE	11957	13040	1	61	HEX HD CAPSCREW	B0612	15991	3
21	STUD	C0609	15991	4	62	LOCK WASHER	J06	15991	3
22	HEX NUT	D06	15991	4	63	FLAT WASHER	KB10	17000	1
23 *	SHAFT SLEEVE	13878	17020	1	64	HEX NUT	D10S	17000	1
24 *	ADJ SHIM SET	2Y	17090	1	65 *	KEY	N0303 1/2	17000	1
25 *	RETAINING RING	S362	----	1					
26	HOIST BAIL	11959	2400V	1	NOT SHOWN:				
27 *	BUSHING	9562	15991	2		CABLE TIE	27111-212	----	1
28	HEX HD CAPSCREW	B0804	15991	2		SUB PUMP OIL	9568	----	1
29	LOCK WASHER	J08	15991	2		VOLTAGE TAG	38816-128	----	1
30	FLAT WASHER	KE08	15991	2		INSTRUC TAG	6588AC	----	1
31	STUD	C0513	15991	4		CONTROL BOX	27515-513	----	1
32	LOCK WASHER	J05	15991	4		HEATER PACK	27521-204	----	1
33	HEX NUT	D05	15991	4					
34	RED PIPE BUSH	AP0604	15079	1	OPTIONAL:				
35	RELIEF VLV ASSY	46431-608	----	1		STAGING ADAPTOR KIT	48272-013	----	1
36	TERM HSG & CAB ASSY	47367-053	----	1		HEAT SHRINK TERM KIT	48315-006	----	1
37	CONNECTOR	S1718	----	3		ANODE PLATE ASSY	42116-003	----	1
38	HEAT SHRINK TUBE	31411-235	19450	3		REPAIR GASKET SET	11000AK	----	1
39	WIRE MARKER KIT	S2274	----	1		LIQUID LEVEL DEVICES:			
40	SPRING WASHER	S1554	----	1		-DIAPHRAGM TYPE	GRP48-03 or GRP48-06	----	1
41 *	BALL BEARING	S1044	----	1		-FLOAT SWITCH	27471-180	----	1
						-120V LIQ LVL CTRL SW	27521-321	----	1

* INDICATES PARTS RECOMMENDED FOR STOCK

Above Serial Numbers Do Not Apply To Pumps Made In Canada.

CANADIAN SERIAL NO. AND UP

THE GORMAN-RUPP COMPANY • MANSFIELD, OHIO

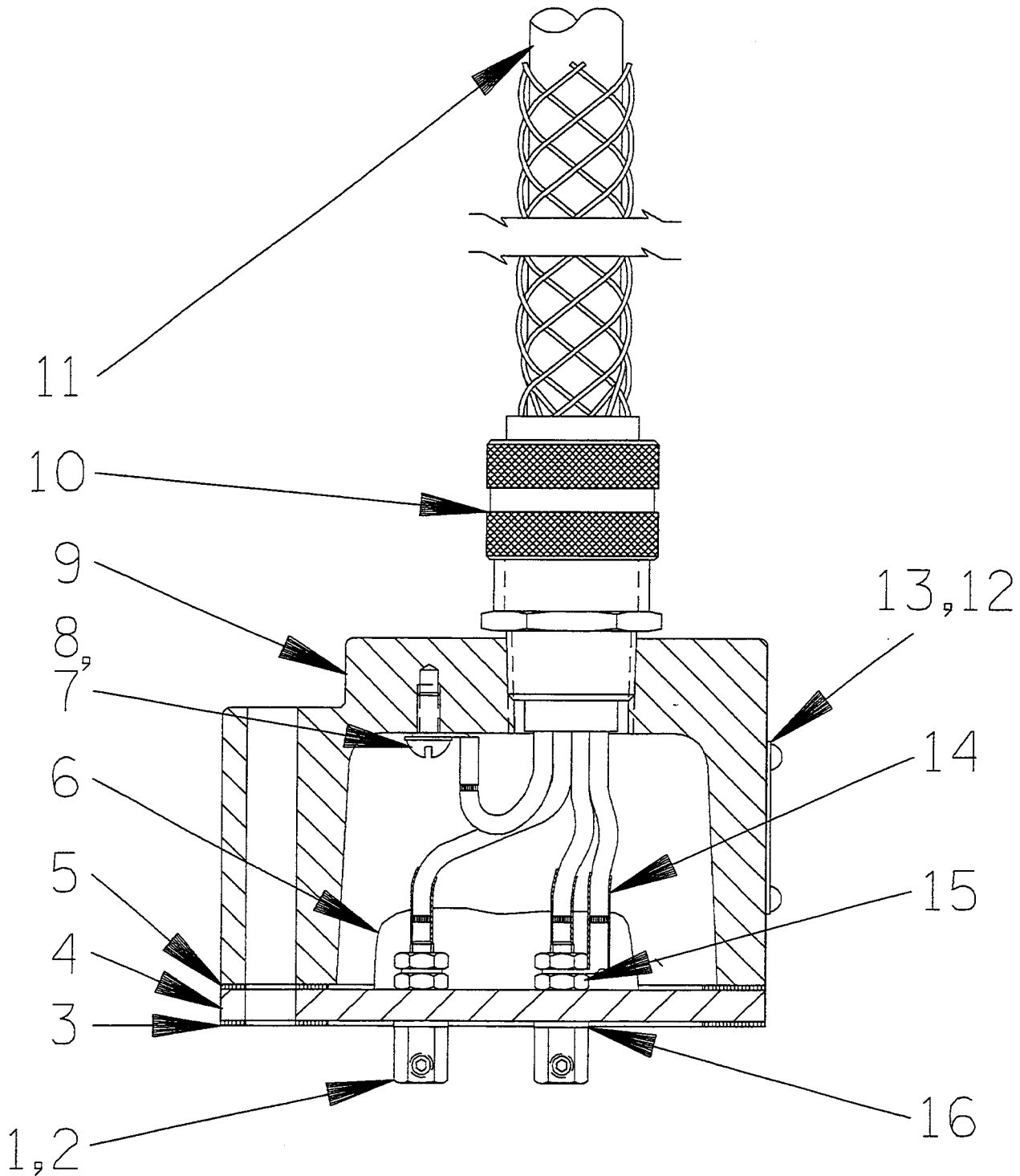

THE GORMAN-RUPP COMPANY • MANSFIELD, OHIO

GORMAN-RUPP OF CANADA LIMITED • ST. THOMAS, ONTARIO, CANADA

Printed in U.S.A.

3 of 4

S/N 1129913 Up
PUMP ISSUE 1

Terminal Housing

If your pump serial number is followed by an "N", your pump is NOT a standard production model. Contact the Gorman-Rupp Company to verify part numbers.

ITEM NO.	PART NAME	PART NUMBER	MAT'L CODE	QTY
1	TERMINAL	11181	14100	3
2	A HD SET SCREW	GA#10-01S	15991	3
3	GASKET	38687-525	20000	1
4	TERMINAL PLATE	38713-008	23010	1
5	* GASKET	38687-525	20000	1
6	RTV SEALANT	18771-106	---	1
7	RD HD MACH SCREW	X#10-02	15991	1
8	T TYPE LOCK WASHER	AK#10	15991	1
9	TERMINAL HOUSING	38381-231	13040	1
10	CABLE GRIP	27111-011	---	1
11	* CABLE ASSY	47351-053	---	1
12	INFO PLATE	38816-047	17990	1
13	DRIVE SCREW	BM#04-03	17000	4
14	* HEAT - SHRINK TUBE	31411-233	19530	3
15	HEX NUT	D#10	14990	6
16	* DYNA-SEAL WASHER	S1590	---	3

* INDICATES PARTS RECOMMENDED FOR STOCK

THE GORMAN-RUPP COMPANY • MANSFIELD, OHIO

**For U.S. and International Warranty Information,
Please Visit www.grpumps.com/warranty
or call:
U.S.: 419-755-1280
International: +1-419-755-1352**

**For Canadian Warranty Information,
Please Visit www.grcanada.com/warranty
or call:
519-631-2870**