

X446-47

B

17859

SHEET  
1 OF 1

\* 18.00/[457.2] RECOMMENDED FOR REMOVAL OF BACK COVER PLATE

10.50/[266.7] REQUIRED FOR REMOVAL OF BACK COVER PLATE

METRIC DISCHARGE:  
80,0 MM WITH (8) 18,0 MM  
DIA HOLES EQUALLY SPACED  
ON A 160 MM DIA B.C.  
PER DIN 2527, (PN16).

METRIC SUCTION:  
100,0 MM, WITH (8) 18,0 MM  
DIA. HOLES EQUALLY SPACED  
ON A 180 MM DIA B.C.  
PER DIN 2527, (PN16)

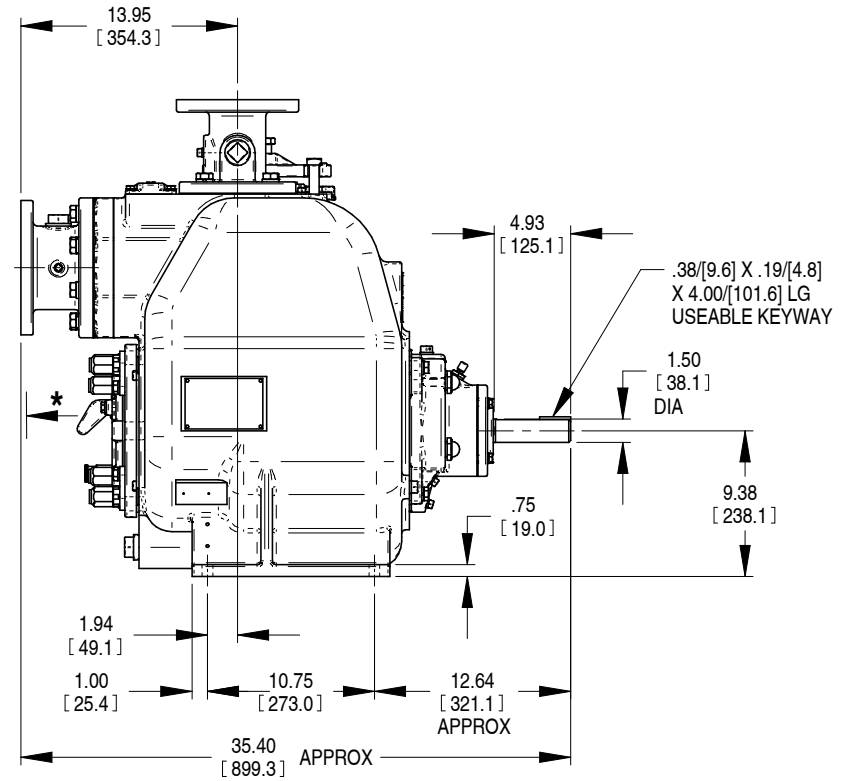
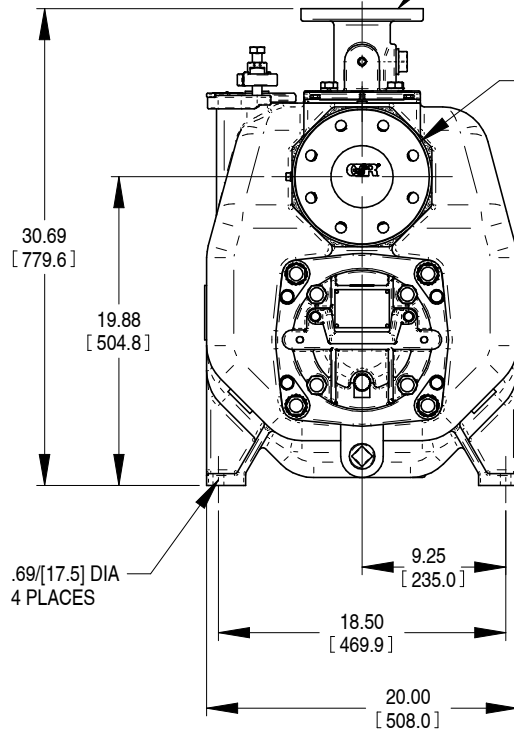

V3A-B  
V3B-B  
V3CSC-B  
V3DSC-B

NOTE:  
SHOWN WITH OPTIONAL METRIC SPOOL FLANGES

DIMENSIONS:  
INCHES  
[MILLIMETERS]

20-008

<b>GOR PUMPS</b>	<b>THE GORMAN-RUPP CO.</b>	DRAWN BY	SCALE	MODEL
	MANSFIELD, OHIO ST. THOMAS, ONTARIO	DFB	3/16	NOTED
		DATE	REVISED	OUTLINE NUMBER
		5/23/2006	7/14/2020	17859