

B 16669F

NOTE:
GHS JACKETED BACKHEAD DIMENSIONS ARE THE SAME AS THE STANDARD GHS BACKHEAD.

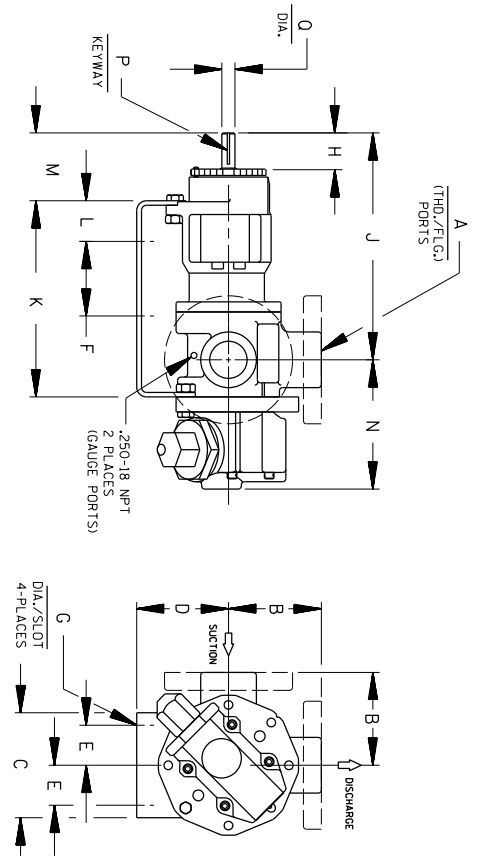

CAD FILE NO.: 16669F

MODEL NUMBERS	PUMP DIMENSIONS - INCHES [MILLIMETERS]														
	A	B	C	D	E	F	G	H	J	K	L	M	N	P	Q
GHS G	1-1/2"	4.00	4.88	4.50	1.62	8.00	.41	1.62	12.06	10.72	1.52	3.35	5.70	.19	.75
		[1023]	[124]	[114]	[41]	[203]	[10]	[41]	[306]	[272]	[39]	[85]	[145]	[5]	[19]
		6.25	6.25	5.25	5.25	6.25	6.25	6.25	6.25	6.25	6.25	6.25	6.25	6.25	6.25
GHS J	3"	6.00	6.88	6.25	2.88	10.00	.44	2.50	15.68	14.31	2.77	4.48	8.50	.25	1.00
		[1521]	[175]	[159]	[73]	[254]	[11]	[64]	[398]	[363]	[70]	[114]	[216]	[6]	[25]
		6.31	6.31	7.00	7.00	8.00	8.00	8.00	8.00	8.00	8.00	8.00	8.00	8.00	8.00
GHS N	3"	7.19	8.00	6.25	2.88	10.00	.44	2.50	16.37	15.14	2.69	4.56	8.72	.25	1.12
		[1833]	[203]	[159]	[73]	[254]	[11]	[66]	[416]	[383]	[88]	[116]	[221]	[6]	[28]
		7.19	7.19	7.00	7.00	8.00	8.00	8.00	8.00	8.00	8.00	8.00	8.00	8.00	8.00
GHS R	2-1/2"	7.19	10.50	7.00	3.75	13.75	.52	2.25	17.87	17.36	1.80	4.70	1.31	.38	1.44
		[1833]	[267]	[178]	[95]	[349]	[13]	[57]	[454]	[441]	[46]	[119]	[287]	[10]	[37]
		7.19	7.19	7.00	7.00	8.00	8.00	8.00	8.00	8.00	8.00	8.00	8.00	8.00	8.00

* STANDARD DIMENSION
 † PORTS ARE COMPATIBLE WITH 150" OR 300" ANSI STEEL FLANGES. ALL OTHER PORTS ARE TAPPED NPT FOR ANSI PIPE. OPTIONAL (DN) FLANGES OR TAPPED (BSP) PORTS AVAILABLE FOR EXPORT MARKET.
 ‡ 180" HOUSING

GHS STL, SEC. 560: PAGE 17
 JUNE 2009

CLOCKWISE ROTATION (FROM SHAFT END)

DIMENSIONS:
 INCHES
 [MILLIMETERS]

- DO NOT SCALE DRAWING.
- GRAPHICS ARE NOT TO SCALE.
- PUMP GRAPHICS ARE BASED ON A "G" SIZE PUMP.

18-018

	THE GORMAN-RUPP CO. MANSFIELD, OHIO ST. THOMAS, ONTARIO	DRAWN BY	SCALE	MODEL
		CSI	NONE	GHS 90°
		DATE	REVISED	OUTLINE NUMBER
		12-16-08	04-03-18	16669F